





1 1 1

- Gemini Bungalow
- Well-Presented
- Modern Shower Room
- Parking Available
- Public Transport Links
- Sought-After Area
- One Double Bedroom
- Built-In Wardrobes
- Local Facilities
- Council Tax Band *B*





We are delighted to welcome to the sale market this well-presented one bedroom Gemini bungalow, located in Melton Park- a very desirable residential area. The home benefits from a variety of local facilities nearby, with more available on Gosforth High Street and Newcastle city centre via regular bus routes and the metro service.

The ground floor of the property briefly comprises;- open plan living space, kitchen with floor and top units, and a modern shower room WC. The stairs lead to the loft, which is a double bedroom that boasts built-in wardrobes. The property further benefits from electric heating and double glazing. Externally, there is parking available to the front of the property

For more information or to book your viewing, please, call our Gosforth office on 0191 236 2070.

Tenure

The agent understands the property to be leasehold. However, this should be confirmed with a licensed legal representative.

Council Tax band *B*



Ground Floor

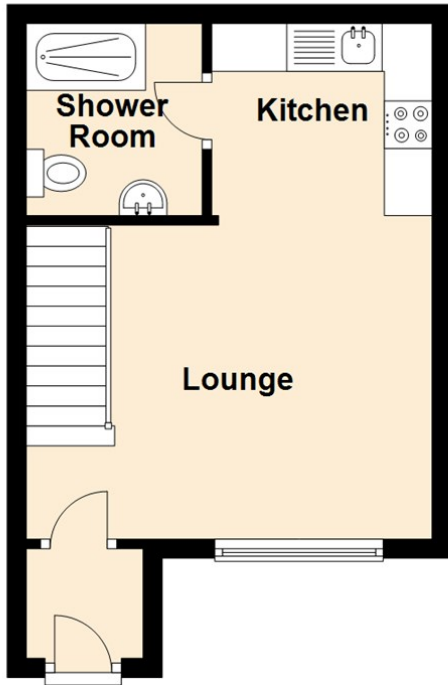

First Floor



The difference between house and home

You may download, store and use the material for your own personal use and research. You may not republish, retransmit, redistribute or otherwise make the material available to any party or make the same available on any website, online service or bulletin board of your own or of any other party or make the same available in hard copy or in any other media without the website owner's express prior written consent. The website owner's copyright must remain on all reproductions of material taken from this website.



www.janforsterestates.com

Energy Efficiency Rating		
	Current	Potential
Very energy efficient - lower running costs		
(92 plus) A		95
(81-91) B		
(69-80) C	68	
(55-68) D		
(39-54) E		
(21-38) F		
(1-20) G		
Not energy efficient - higher running costs		
England & Wales	EU Directive 2002/91/EC	

Gosforth

0191 236 2070

Newcastle

0191 284 4050

High Heaton

0191 270 1122

Tynemouth

0191 257 2000

Low Fell

0191 487 0800

Property Management Centre

0191 236 2680

