



**For Sale**

**21 Wellum Street, Lighthorne Heath**

**£270,000**

**3**

**1**

**2**

**132 m<sup>2</sup>**

**62 m<sup>2</sup>**

**Nathaniel Cleaver**

**07793 363210**

[nathaniel@thepropertyexperts.co.uk](mailto:nathaniel@thepropertyexperts.co.uk)

**\*\*\* MODERN STUNNINGLY PRESENTED HOUSE SET IN EVER POPULAR LOCATION THAT IS READY TO MOVE STRAIGHT INTO \*\*\***

... MODERN STUNNINGLY PRESENTED HOUSE SET IN EVER POPULAR LOCATION THAT IS READY TO MOVE STRAIGHT INTO ...

This property was built by Bellway Homes just over five years ago and is ideally located for Leamington Spa, Warwick, Banbury and Stratford Upon Avon and is a stone's throw from Jaguar Land Rover and Aston Martin.

The property is ideal for a first time buyer, small family, somebody looking to downsize or an investor and is ready to move straight into.

In brief on the ground floor the property comprises of; entrance hallway, WC, living room and integrated kitchen / dining area with direct access to the enclosed rear garden.

Upstairs you have a great sized master bedroom with built in wardrobes, bedroom two is also a good sized and could be used as a bedroom, nursery or study, again with built in wardrobes and there is a white modern family bathroom suite with shower over bath.



**The Property Experts**

**The Property Experts -  
Leamington Spa**

01926436105



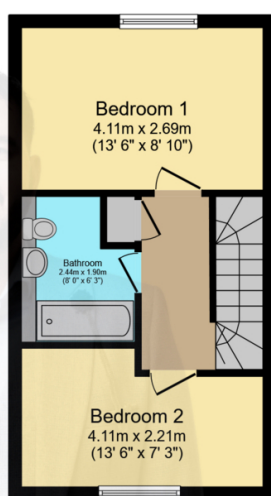
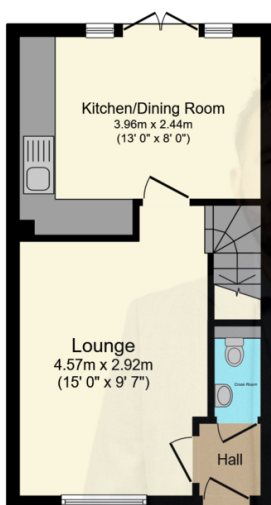

Total floor area: 62.1 sq.m. (668 sq.ft.)

This floor plan is for illustrative purposes only. It is not drawn to scale. Any measurements, floor areas (including any total floor area), openings and orientations are approximate. No details are guaranteed, they cannot be relied upon for any purpose and do not form any part of any agreement. No liability is taken for any error, omission or misstatement. A party must rely upon its own inspection(s). Powered by [www.Propertybox.io](http://www.Propertybox.io)

- Built By Belway Homes 5 Years Ago
- Semi Detached
- Two Double Bedrooms
- Living Room
- Integrated Kitchen / Dining Area
- Enclosed Rear Garden
- Driveway Parking For Two Cars
- Close To Local Amenities & JLR
- Immaculate Presentation Throughout

