



For Sale

22 Amados Close, Plymouth

**Offers In Excess Of
£250,000**

 **3**

 **1**

 **2**

 **649 sq ft**

Great opportunity to buy a 3 bedroom semi detached in a quiet cul de sac in Plympton with a large corner plot giving loads of potential to extend subject to PP

PROPERTY DESCRIPTION

Situated in the ever popular town of Plympton, this 3 bedroom semi detached house sits on a generous plot giving the property plenty of potential to extend subject to the relevant planning permission.

Over the last few years the property has been modernised to include a new kitchen and bathroom and a feature media wall in the living room. The property is all UPVC Double glazed and has gas central heating. To the first floor there are 2 double bedrooms and the smaller 3rd bedroom and the newly fitted bathroom.

To the front of the property there is parking for 2/3 cars and a driveway leading to the garage, to the side of which is a large gate giving access to the garden. The garden is mainly laid to lawn with a patio area and wraps around the property, to the side and rear.

AREA DESCRIPTION

Plympton is a Historic town situated on the outskirts of the Ocean City of Plymouth, the ancient Stannary Town is listed in the Domesday book and is steeped in History including its own Mott and Bailey Castle.

Plympton has a fantastic community spirit with a characterful town centre being the hub of it all, the Christmas Light switch on yearly attracts over 4000 residents.

Paul Stone

07798 674649

paul.stone@thepropertyexperts.co.uk





Ground Floor

Approx. 29.2 sq. metres (314.1 sq. feet)

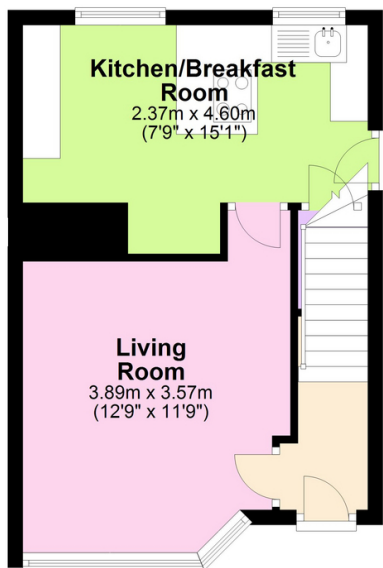

Total area: approx. 60.3 sq. metres (649.6 sq. feet)

- 3 Bedroom Semi Detached
- Corner Plot
- Cul De Sac Location
- Garage and driveway
- Gas Central Heating
- upvc Double Glazing
- New Kitchen and Bathroom

