



For Sale

3 Sunset Close, Leamington Spa

£136,000

3

1

3

83 m²

***** IDEAL FOR FIRST TIME BUYERS LOOKING TO GET ON THE PROPERTY LADDER *** This shared ownership property is available for £136,000 for 40%. (100% is £340,000).**

A well presented and very modern three bedroom semi detached house located in the popular area of Oakley Grove and recently built by local builder AC Lloyd.

This house is in a perfect location for school catchments, motorway networks and local amenities. The property has 8 years of its NHBC guarantee and is close to a newly built children's play area.

The ground floor consists of; lounge, downstairs WC, kitchen / dining area with doors leading out to the enclosed and pleasant rear garden which is mainly laid to lawn and fully fenced with a small patio area and shed

Upstairs there are three good sized bedrooms and a white modern family bathroom suite.

Further benefits include tandem driveway parking to the side for two cars, air source heat pump, solar panels and under floor heating throughout.

Nathaniel Cleaver

07793 363210

nathaniel@thepropertyexperts.co.uk



 **The Property Experts**

**The Property Experts -
Leamington Spa**

01926436105

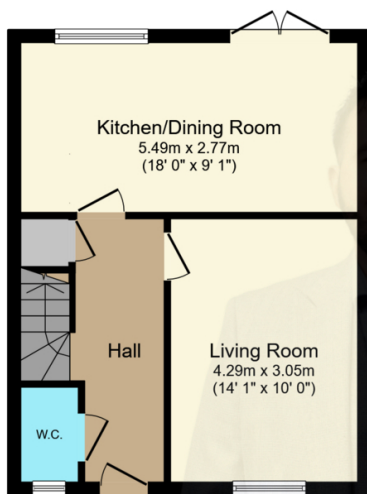

Ground Floor

Floor area 39.3 sq.m. (423 sq.ft.)

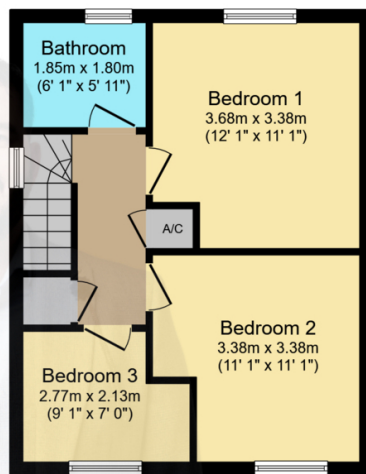

First Floor

Floor area 39.3 sq.m. (423 sq.ft.)

TOTAL: 78.6 sq.m. (846 sq.ft.)

This floor plan is for illustrative purposes only. It is not drawn to scale. Any measurements, floor areas (including any total floor area), openings and orientations are approximate. No details are guaranteed, they cannot be relied upon for any purpose and do not form any part of any agreement. No liability is taken for any error, omission or misstatement. A party must rely upon its own inspection(s). Powered by www.Propertybox.io

- Shared Ownership From.....
- Very Modern Semi Detached House
- Built By Local Builder, AC Lloyd
- Three Bedrooms
- Living Room
- Kitchen / Dining Area
- Air Source Heat Pump, Solar Panels & Under Floor Heating
- 8 Years Left OF NHBC Guarantee
- Driveway Parking For Two Cars

