



For Sale

28 Arlington Lodge Arlington Avenue, Leamington

£230,000

1

1

1

48 m²

***** RETIREMENT APARTMENT IN HIGHLY SOUGHT AFTER LOCATION WITH NO ONWARD CHAIN *****

This well presented one double bedroom first floor apartment is situated close to all local amenities and it is close to the main shopping Parade and all of the shops, restaurants, boutiques and coffee shops the town has to offer as well as being close to all major road networks and the train station.

In brief the accommodation comprises of; good sized entrance hall with large storage cupboard, lounge / dining area with direct access to the kitchen. There is a good-sized double bedroom with built in wardrobe space in and a shower room.

Queensway Court is for the over 60's and offers a good lifestyle with communal lounge and kitchen facilities with a lovely community feel to them as well as very well-maintained rear gardens. The property is also offered for sale with no onward chain.

DO NOT MISS OUT, CALL NOW TO VIEW!

Council Tax Band - C

EPC Rating - B

Tenure - Leasehold

Nathaniel Cleaver

07793 363210

nathaniel@thepropertyexperts.co.uk



 **The Property Experts**

**The Property Experts -
Leamington Spa**

01926436105

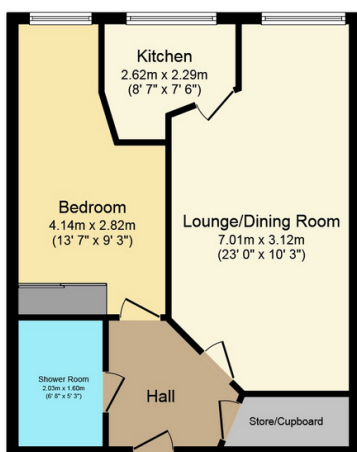

Floor Plan

Floor area 51.0 sq.m. (549 sq.ft.) approx

- Retirement Complex
- One Double Bedroom
- First Floor
- Lounge / Dining Area
- Kitchen
- Shower Room
- Well Maintained Communal Gardens
- Communal Facilities On Ground Floor
- No Onward Chain
- EPC Rating - B

Total floor area 51.0 sq.m. (549 sq.ft.) approx

This Floor Plan is for illustration purposes only and may not be representative of the property. The position and size of doors, windows and other features are approximate. Unauthorized reproduction prohibited. © PropertyBOX



Nathaniel Cleaver
 07793 363210

nathaniel@thepropertyexperts.co.uk