



For Sale

31 Chandley Wharf, Warwick

£215,000

2

1

3

710.4 sq ft

***** MODERN PURPOSE BUILT APARTMENT IS TENANTED UNTIL 31/01/24 SO IDEAL FOR INVESTORS *****

This spacious and modern first floor apartment is ideal for buy to let investments or somebody looking to stay in Warwick and downsize or even a first time buyer prepared to wait until the current tenant vacates.

The property is positioned close to the M40, Warwick and Leamington Town centres and just over 1 mile to Warwick Parkway train station.

The property comprises in brief of; secure communal entrance hall, hallway, lounge / diner with a Juliet balcony overlooking the canal and a kitchen. There are 2 double bedrooms, the master benefiting from an en suite shower room and built in wardrobes and a modern white bathroom.

The apartment also benefits from double glazing and allocated parking space and a garage. The property is a stones throw away from the canal to enjoy walks, a bike ride or simply take in the picturesque views.

The apartment is in immaculate condition throughout, is offered for sale with no onward chain and viewing is highly recommended.

Nathaniel Cleaver

07793 363210

nathaniel@thepropertyexperts.co.uk



 **The Property Experts**

The Property Experts UK

01926436105



- Modern First Floor Apartment
- Tenanted Until 31/01/24
- Two Double Bedrooms
- Open Plan Lounge / Dining Room
- Bathroom & En Suite
- Integrated Kitchen
- Views Over Looking Canal
- Popular Location
- Garage
- EPC Rating - B

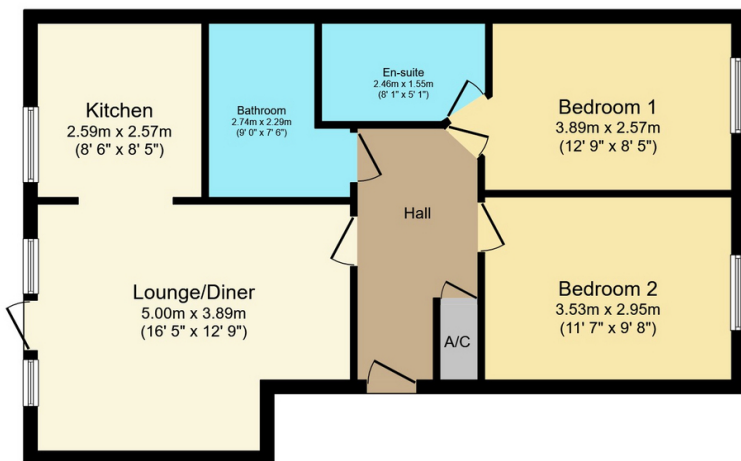

Floor Plan

Floor area 65.2 sq.m. (702 sq.ft.) approx

Total floor area 65.2 sq.m. (702 sq.ft.) approx
 This Floor Plan is for illustration purposes only and may not be representative of the property. The position and size of doors, windows and other features are approximate. Unauthorized reproduction prohibited. © PropertyBOX

