



26 Derby Road | Long Eaton | Nottingham | NG10 1PD

The shop comprises of two ground floor rooms – front shop area, rear room and central inner lobby leading down to the cellar, which is beneath the entire ground floor of the property. Located in a prominent main road location close to the centre of Long Eaton.

Rent £600 pcm

Viewing Arrangements

Strictly by appointment

Contact Details

27 Derby Road
Long Eaton
Nottingham
Nottinghamshire
NG10 1LU

www.wallacejones.co.uk
enquiries@wallacejones.net
01159468946

Ground Floor

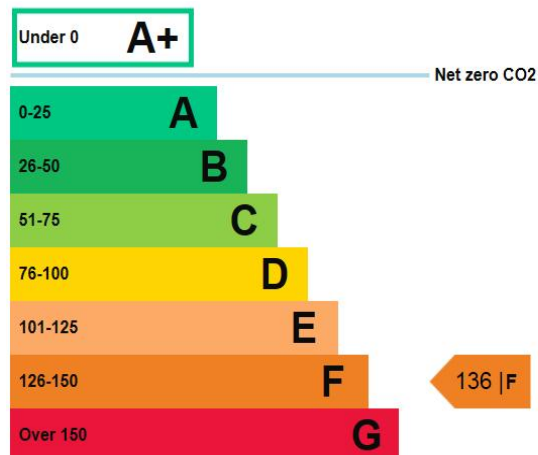
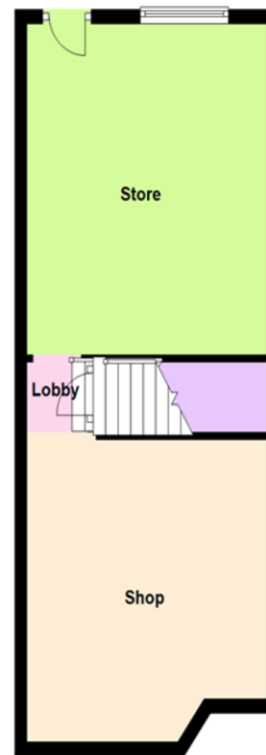

Agents Note: Whilst every care has been taken to prepare these particulars, they are for guidance purposes only. All measurements are approximate and for general guidance purposes only and whilst every care has been taken to ensure their accuracy, they should not be relied upon and potential tenants are advised to recheck the measurements.