

# Beacon Mews

Beacon Street, Lichfield, WS13 7AQ



A spacious two bedroom ground floor apartment offered to the market with no onward chain situated within walking distance of Lichfield Cathedral and city centre.

£250,000



John German 

Outside, to the rear of the property there is a communal courtyard with allocated and visitor parking, a wonderful patio seating area and a covered entrance way leading to the front door of this apartment.

This spacious ground floor apartment comprises a n entrance hallway with two storage cupboards and doors leading off to the family bathroom, bedrooms and living room.

The master is a spacious double bedroom, having a beautiful double glazed sash window to the front aspect looking out onto Beacon Street, carpeted flooring, radiator, and an en-suite shower room comprising a fully tiled double shower cubicle with mains shower, wash hand basin and low level WC.

Bedroom two is a further double bedroom with a timber double glazed sash window to the side aspect overlooking the communal garden, radiator and carpeted flooring.

In addition to the master bedroom having its own en-suite, the family bathroom comprises a panelled bath, low level WC and wash hand basin with part tiled walls, radiator and carpeted flooring.

Completing this apartment is the wonderful living room with a timber double glazed sash window, an entrance door to the rear allowing access onto Beacon Street and an opening into the kitchen. The kitchen has a sash window to the side aspect, spotlights to the ceiling and is fitted with a range of wall and base units with roll top surfaces, tiled splashbacks, stainless steel sink with mixer tap over and a range of integrated appliances.

Please note that as well as steps, there is also alternative level access.

**Tenure:** Leasehold (purchasers are advised to satisfy themselves as to the tenure via their legal representative).

**Property construction:** Brick

**Parking:** Allocated

**Electricity supply:** Mains

**Water supply:** Mains

**Sewerage:** Mains

**Heating:** Gas

(Purchasers are advised to satisfy themselves as to their suitability).

**Broadband type:** See Ofcom link for speed: <https://checker.ofcom.org.uk/>

**Mobile signal/coverage:** See Ofcom link <https://checker.ofcom.org.uk/>

**Local Authority/Tax Band:** Lichfield District Council / Tax Band C

**Useful Websites:** [www.gov.uk/government/organisations/environment-agency](http://www.gov.uk/government/organisations/environment-agency)  
[www.lichfielddc.gov.uk](http://www.lichfielddc.gov.uk)

**Our Ref:** JGA/18032024

The property information provided by John German Estate Agents Ltd is based on enquiries made of the vendor and from information available in the public domain. If there is any point on which you require further clarification, please contact the office and we will be pleased to check the information for you, particularly if contemplating travelling some distance to view the property. Please note if your enquiry is of a legal or structural nature, we advise you to seek advice from a qualified professional in their relevant field.

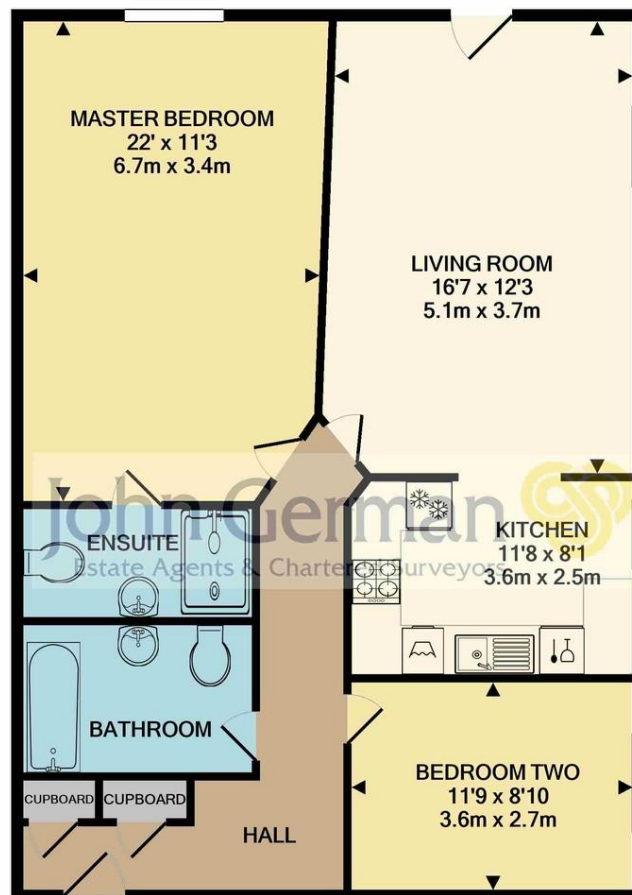

Whilst every attempt has been made to ensure the accuracy of the floor plan contained here, measurements of doors, windows, rooms and any other items are approximate and no responsibility is taken for any error, omission, or mis-statement. This plan is for illustrative purposes only and should be used as such by any prospective purchaser. The services, systems and appliances shown have not been tested and no guarantee as to their operability or efficiency can be given  
Made with Metropix ©2020





Score	Energy rating	Current	Potential
92+	A		
81-91	B		
69-80	C	76 C	78 C
55-68	D		
39-54	E		
21-38	F		
1-20	G		



John German  
 22 Bore Street, Lichfield, Staffordshire, WS13 6LL  
 01543 419121  
 lichfield@johngerman.co.uk

#### Agents' Notes

These particulars do not constitute an offer or a contract neither do they form part of an offer or contract. The vendor does not make or give and Messrs. John German nor any person employed has any authority to make or give any representation or warranty, written or oral, in relation to this property. Whilst we endeavour to make our sales details accurate and reliable, if there is any point which is of particular importance to you, please contact the office and we will be pleased to check the information for you, particularly if contemplating travelling some distance to view the property. None of the services or appliances to the property have been tested and any prospective purchasers should satisfy themselves as to their adequacy prior to committing themselves to purchase.

#### Referral Fees

**Mortgage Services** - We routinely refer all clients to APR Money Limited. It is your decision whether you choose to deal with APR Money Limited. In making that decision, you should know that we receive on average £60 per referral from APR Money Limited.

**Conveyancing Services** - If we refer clients to recommended conveyancers, it is your decision whether you choose to deal with this conveyancer. In making that decision, you should know that we receive on average £150 per referral.

**Survey Services** - If we refer clients to recommended surveyors, it is your decision whether you choose to deal with this surveyor. In making that decision, you should know that we receive up to £90 per referral.

Ashbourne | Ashby de la Zouch | Barton under Needwood  
 Burton upon Trent | Derby | East Leake | Lichfield  
 Loughborough | Stafford | Uttoxeter

**JohnGerman.co.uk** Sales and Lettings Agent