

2  
BED

# Detached Bungalow in Quiet Close

9, Gleneagles Close, Seaford, BN25 2TL



Price £375,000

Freehold

**phillipmann**  
we do more

[www.phillipmann.com](http://www.phillipmann.com)

9 Gleneagles Close, BN25 2LT

Approximate Gross Internal Floor Area = 73.4 sq m / 791 sq ft

Garage Area = 12.2 sq m / 132 sq ft

Total Area = 85.6 sq m / 923 sq ft

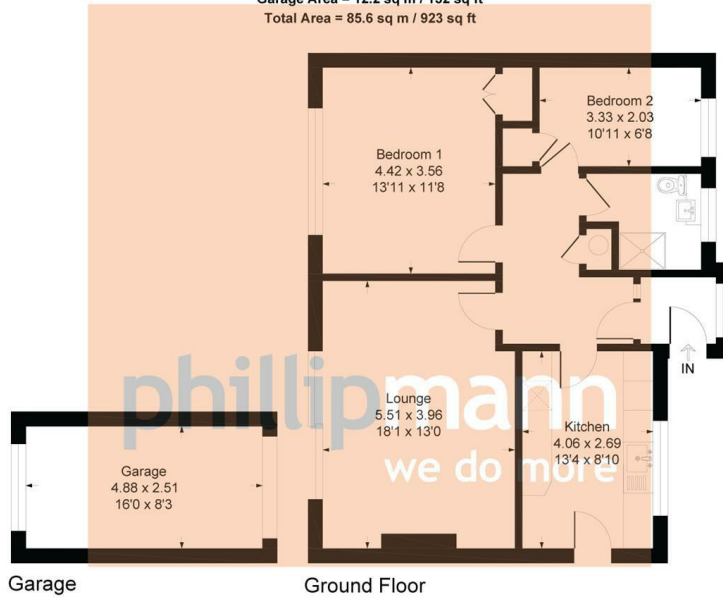

Illustration for identification purposes only, measurements are approximate, not to scale

inbrief...

Phillipmann Estate Agents are offering this two bedroom detached bungalow in the popular area of Bishopstone which is close to train links, beach and lovely walks along Tide Mills. This property is in need of modernising. However, it still offers good sized accommodation with a lovely wide garden and benefits from double glazing and gas central heating and is being sold with NO ONGOING CHAIN.

As you enter the property you are welcomed into a separate porch way leading into a spacious hall.

On your left you will find a good sized gally kitchen that includes multiple base and wall hung units, oven space, views of the sea, fridge freezer space and a side door to the garage.

Following through the hall, there is a shower room which has been tiled throughout and includes, a sink vanity unit, closed-couple W/C, single shower cubicle, heated towel rail and a frosted glass window.

The second bedroom next door is more of a single bedroom or study, it has space for a small wardrobe and chest of drawers as well as a single bed.

The master bedroom can be found further down which is a good sized double bedroom that has space for a chest of drawers, double bed, bedside tables and a wardrobe it also overlooks the garden.

There is a spacious lounge next along the hall which has space for multiple seating, dining table and has sliding doors out to the garden.

The garden on this property is a lovely sized plot which has shed space down the side and also side access.

A regular sized garage can be found on the side of the property too.



Council Tax Band: D

Energy Rating Level: D

moreinfo...



Phillip Mann Seaford Office  
1-3 Dane Road, Seaford, East Sussex, BN25 1LG  
01323 898666

To see more details on this & all our homes go to [www.phillipmann.com](http://www.phillipmann.com)