



1 Fox Street

Rothwell, Northamptonshire NN14 6AN



Simpson & Partners

*** NO ONWARD CHAIN*** Nestled in the charming historic market town of Rothwell, this exquisite brick and stone cottage offers a unique blend of traditional character and modern conveniences. With two double bedrooms, the property is available for sale with no onward chain, providing a hassle-free purchasing experience.

Upon entering, you'll be greeted by an inviting atmosphere accentuated by UPVC double glazing and a modern, efficient electric heating system. The heart of the home is the luxury fitted kitchen, which boasts built-in appliances and elegant solid wood work surfaces, providing both functionality and style. Adjacent to the kitchen, the living room serves as a cosy retreat, enhanced by French doors that lead out to a beautifully designed, low-maintenance stone walled garden. This seamless connection between indoor and outdoor spaces is perfect for both relaxation and entertaining. Relaxed parking in parking bay to the front.

Ascending to the first floor, you'll discover two double bedrooms, each offering space and comfort. The luxury fitted shower room is thoughtfully designed with high-quality finishes, adding a touch of elegance to your daily routine.

The cottage's prime location ensures convenience, with easy access to Rothwell's town centre and a variety of local amenities. Whether you're exploring the historic charm of the town or simply running errands, everything you need is within reach.

This property is a rare find, combining the allure of a historic setting with the comforts of modern living. An internal viewing is essential to fully appreciate the beauty and character of this stunning home. It's an exceptional opportunity for those seeking a distinctive residence in a sought after location, promising a lifestyle of both convenience and charm.

Council Tax Band: A -

Price £180,000



2



1



1



Simpson & Partners

GROUND FLOOR

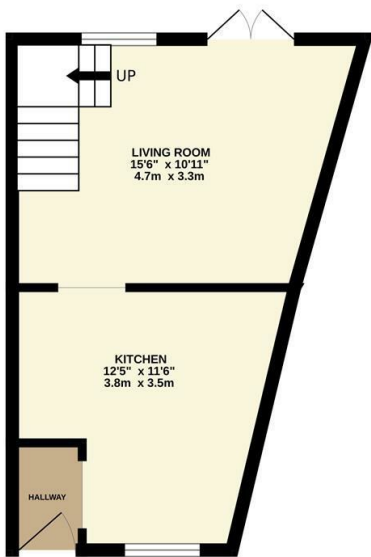

1ST FLOOR

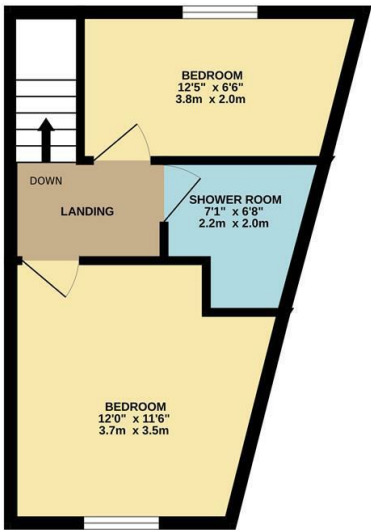

Whilst every attempt has been made to ensure the accuracy of the floorplan contained here, measurements of doors, windows, rooms and any other items are approximate and no responsibility is taken for any error, omission or mis-statement. This plan is for illustrative purposes only and should be used as such by any prospective purchaser. The services, systems and appliances shown have not been tested and no guarantee as to their operability or efficiency can be given.
Made with Metropix ©2025

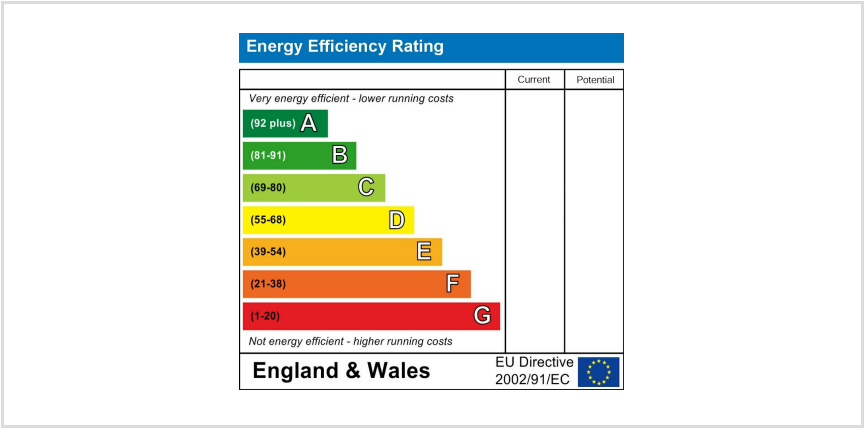

When you buy with Simpson and Partners, you know **you'll be in safe hands**. From the moment you walk through our doors, we'll make you **feel truly welcome**. Our sales consultants and financial advisors will take you through **every step of the process**, offering **free expert advice** along the way, from help choosing the right mortgage and insurance through to finding your conveyancer. And if you need help selling your home too, **with over 20 years of local experience, you can trust us to get you moving**.



**Simpson
& Partners**

Making Every
Journey Personal



01536 518200

kettering@simpsonandpartners.co.uk

<https://www.simpsonandpartners.co.uk/>

1 Silver Street, Kettering, Northants, NN16 0BN