



Bosworth Street

Barton Seagrave, Northamptonshire NN15 6RN



Simpson & Partners

NO ONWARD CHAIN - This exceptional three bedroom terraced property, constructed in 2021, combines modern living with practical features in a highly desirable setting. The home provides you with off road parking, ensuring convenience from the moment you arrive.

The ground floor reveals a 15' kitchen/dining room that comes equipped with stainless steel built-in appliances, perfect for culinary enthusiasts and family gatherings. Adjacent to this is a generous 14' living room, providing ample space for relaxation and entertainment. A convenient downstairs WC adds to the practicality of the layout.

Ascending to the first floor, bedroom one impresses with its own en-suite shower room, offering a private retreat. Two additional bedrooms ensure flexibility for family, guests, or home office needs. The three-piece bathroom suite on this level caters to the household with style and functionality.

Outside, the property features an enclosed rear garden, ideal for outdoor activities and enjoying sunny days. This home is a true gem, and an internal viewing is highly recommended to fully appreciate its quality and avoid any disappointment.

Price £250,000



3



2



1



GROUND FLOOR

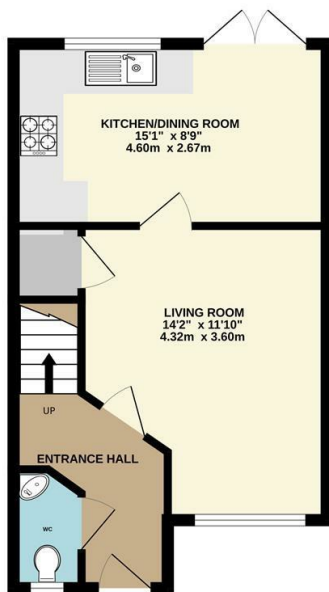

1ST FLOOR

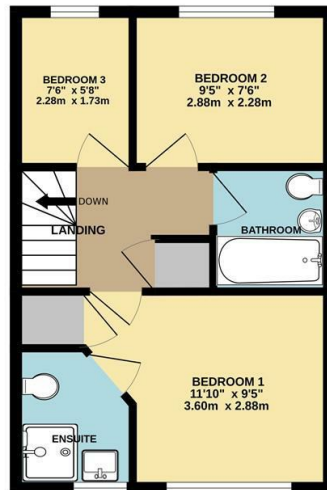

Whilst every attempt has been made to ensure the accuracy of the floor plan contained herein, measurements of doors, windows, rooms and any other items are approximate and no responsibility is taken for any error, omission, or mis-statement. The plan is copyright to Simpson and Partners and is for illustrative purposes and should only be used as such for any prospective purchaser. The services, systems and appliances shown have not been tested and no guarantee as to their operability can be given.
Made with Metropop ©2024

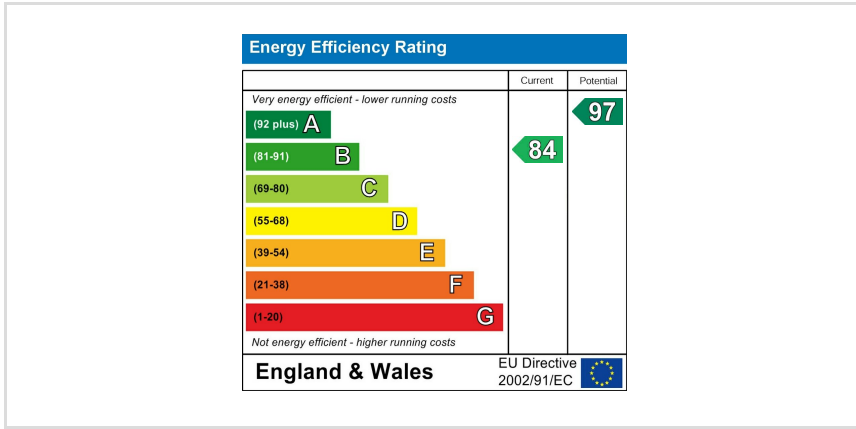

When you buy with Simpson and Partners, you know **you'll be in safe hands**. From the moment you walk through our doors, we'll make you **feel truly welcome**. Our sales consultants and financial advisors will take you through **every step of the process**, offering **free expert advice** along the way, from help choosing the right mortgage and insurance through to finding your conveyancer. And if you need help selling your home too, **with over 20 years of local experience, you can trust us to get you moving**.



**Simpson
& Partners**

Making Every
Journey Personal



01536 518200

kettering@simpsonandpartners.co.uk

<https://www.simpsonandpartners.co.uk/>

1 Silver Street, Kettering, Northants, NN16 0BN