



24 Cyprus Road, Portsmouth  
Portsmouth

In Excess of £210,000

 chinneckshaw







# 24 Cyprus Road

Portsmouth, Portsmouth

We are delighted to present this charming two-bedroom mid-terraced house located on Cyprus Road, Portsmouth. This property is ideal for first-time buyers and investors alike, boasting an inviting open-plan living area and a spacious four-piece bathroom.

Upon entry, you are welcomed into a quaint vestibule that leads into the expansive open-plan living space, seamlessly connecting to the garden.

Towards the rear of the property, you will find a generously sized kitchen, offering ample storage and countertop space. The kitchen, decorated in neutral tones, includes room for appliances and features a picturesque window above the sink, providing a delightful view of the garden.

The first floor comprises two well-proportioned bedrooms and a large bathroom complete with a four-piece suite.

The rear garden, perfect for entertaining and relaxation, features a raised patio area and two freestanding sheds at the far end, offering additional storage solutions.

This property on Cyprus Road is not to be missed. Contact Chinneck Shaw today to arrange a viewing.



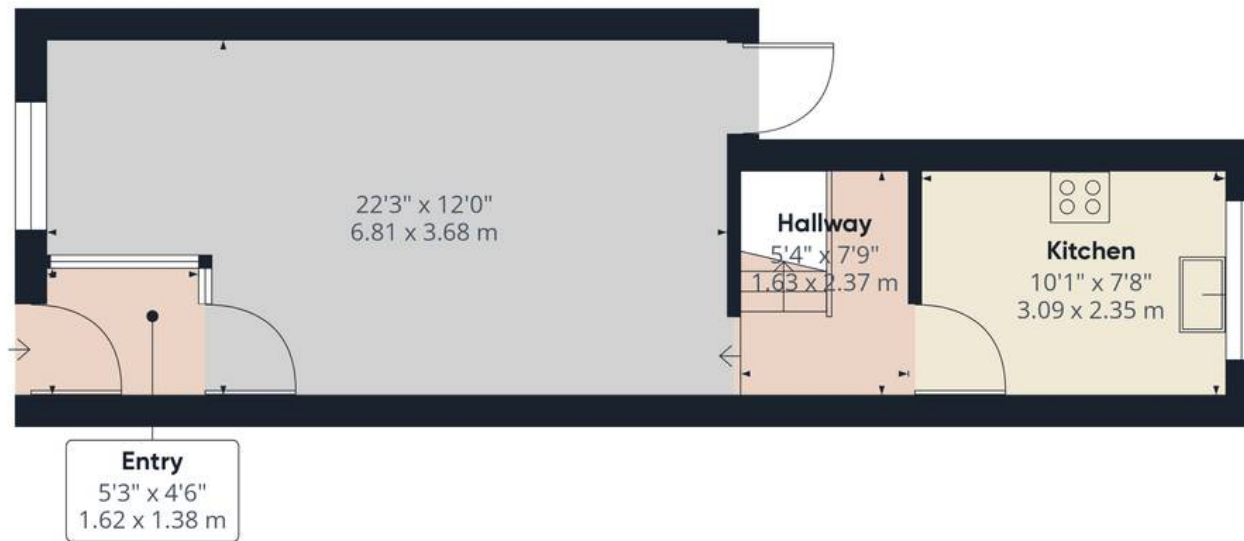

Ground Floor

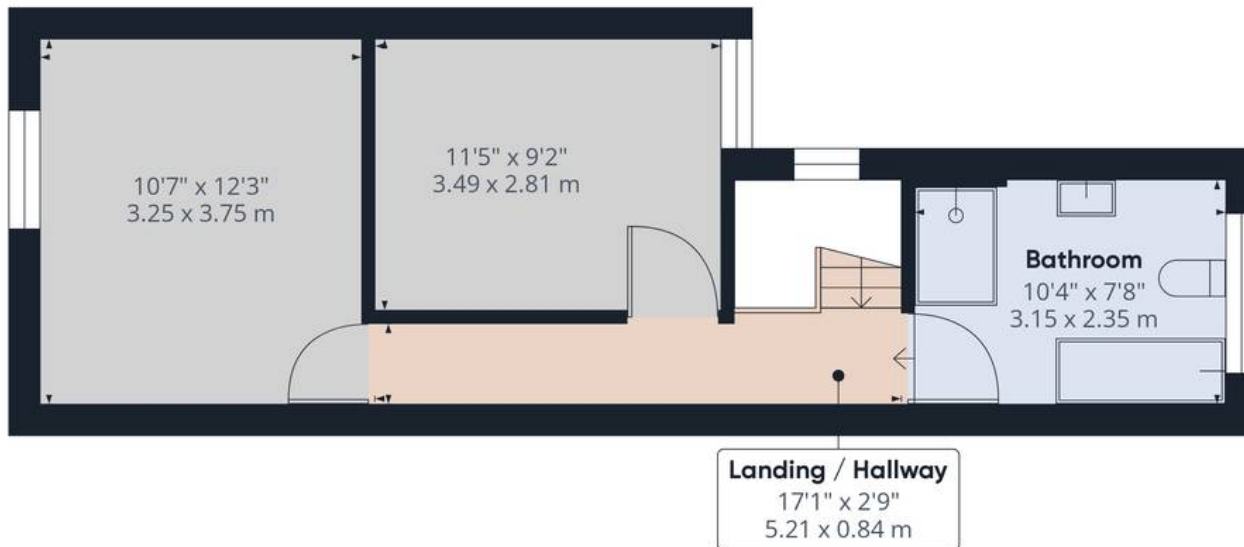

Floor 1

Approximate total area<sup>(1)</sup>

764.52 ft<sup>2</sup>

71.03 m<sup>2</sup>

(1) Excluding balconies and terraces

While every attempt has been made to ensure accuracy, all measurements are approximate, not to scale. This floor plan is for illustrative purposes only.

GIRAFFE360





## Chinneck Shaw

Bridge House, Milton Road, Portsmouth – PO3 6AN

023 9282 6731

[hello@chinneckshaw.co.uk](mailto:hello@chinneckshaw.co.uk)

[www.chinneckshaw.co.uk/](http://www.chinneckshaw.co.uk/)

Chinneck Shaw, Bridge House, Milton Road, PO3 6AN Consumer Protection from Unfair Trading Regulations 2008: These details are for guidance only and complete accuracy cannot be guaranteed. If there is any point which is of particular importance, verification should be obtained. The do not constitute a contract or part of a contract. All measurements are approximate. No guarantee can be given with regard to planning permissions or fitness for purpose. No apparatus, equipment, fixture or fitting has been tested. Items shown in the photographs are NOT necessarily included. Interested Parties are advised to check availability and make an appointment to view before travelling to see a property.