



Coopers Court Crane Mead, Ware

£275,000 Leasehold

CHAIN FREE • En-Suite to Bedroom One • Riverside Development • Communal Gardens • Allocated Parking •
First Floor Apartment • Juliette Balcony



Accommodation Comprises:

Hallway

Lounge/Diner

17' 3" x 13' 8" (5.26m x 4.17m)

Kitchen

10' 4" x 6' 3" (3.15m x 1.91m)

Bedroom One

15' 5" x 11' 1" (4.70m x 3.38m)

En-Suite

Bedroom Two

13' 9" x 6' 4" (4.19m x 1.93m)

Bathroom







First Floor
713 sq.ft. (66.3 sq.m.) approx.

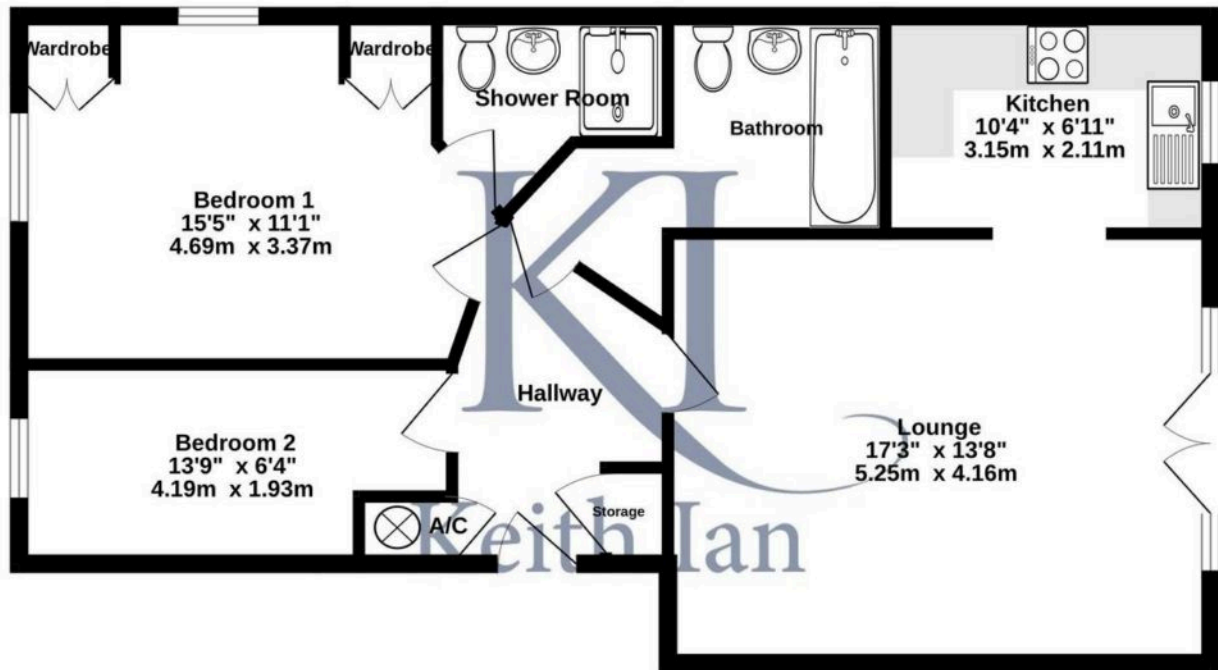

TOTAL FLOOR AREA: 713 sq.ft. (66.3 sq.m.) approx.

Whilst every attempt has been made to ensure the accuracy of the floorplan contained here, measurements of doors, windows, rooms and any other items are approximate and no responsibility is taken for any error, omission or mis-statement. This plan is for illustrative purposes only and should be used as such by any prospective purchaser. The services, systems and appliances shown have not been tested and no guarantee as to their operability or efficiency can be given.
Made with Metropix ©2025