



Grammers Park | | Launceston | PL15 7FY

**Guide Price £225,000**



Grammers Park |  
Launceston | PL15 7FY  
Guide Price £225,000

Prices from  
Open Market Value: £225,000  
Minimum Share: 40%  
Rent PCM: £295.88  
Monthly Service Charge: £29.69

**Summary**  
8 Grammers Park is a 2 bedroom semi-detached house available for shared ownership with a minimum of a 40% share, located within the popular Cornish town of Launceston.

**Description**  
This well presented property benefits from two double bedrooms, open plan living/kitchen/diner, two parking

- Shared Ownership
- Coastline Housing

Description

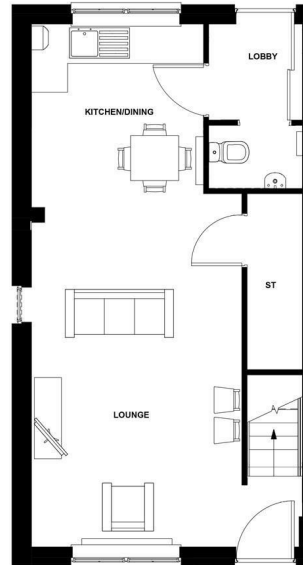

Energy Efficiency Rating		Current	Potential
<i>Very energy efficient - lower running costs</i>			
(92 plus)	A		96
(81-91)	B	84	
(69-80)	C		
(55-68)	D		
(39-54)	E		
(21-38)	F		
(1-20)	G		
<i>Not energy efficient - higher running costs</i>			
<b>England &amp; Wales</b>		EU Directive 2002/91/EC	



Treleven House, Unit 5  
Threemilestone Industrial  
Estate  
Truro  
Cornwall  
TR4 9LD  
01872 242425  
sales@goundrys.co.uk