



4 Bedrooms



1 Bathroom



2 Reception Rooms



On-Street Parking



Private Rear Garden



EPC Band D

Council Tax
Band: D £2,257.13 (2025/2026)

Local Authority
St Albans City & District
Council

 **ashtons**
for life's great moves



Ramsbury Road, St. Albans, AL1 1SJ
Guide Price £970,000 Freehold

Ramsbury Road, St. Albans

A handsome four bedroom semi-detached Edwardian home, set within easy reach of St Albans City centre, mainline railway station and highly regarded schooling.

- 🏡 Beautifully Presented Edwardian Home Arranged Over Three Floors
- 🏡 Living Room with Log-Burning Stove
- 🏡 Superb Fitted Kitchen with French Doors Onto Rear Garden
- 🏡 Four Double Bedrooms
- 🏡 Stylish Bathroom Suite
- 🏡 Private Rear Garden
- 🏡 Close to St Albans City Centre & Highly Regarded Schooling

Description

Positioned within a quiet and peaceful cul-de-sac, this wonderful Edwardian property has a superb arrangement of accommodation over three floors which is flooded in natural light.

The property is accessed via an enclosed porch leading to a bright and spacious entrance hall. The living room has a front aspect with feature fireplace and log burner and to the rear there is a bespoke kitchen with a range of high-end fitted appliances and storage units. There is a separate dining room, and the beautiful rear garden can be accessed via French doors from the breakfast room.

To the first floor there are three sizeable bedrooms which are serviced by a stylish bathroom suite. The second floor provides a generous double bedroom with plenty of storage built-in the eaves and far-reaching views.

To the rear there is a private manicured garden which is mainly laid to lawn with various plant borders and mature shrubs.

Location

Ramsbury Road is situated in the conservation area approximately a ten minute walk to the mainline station and central St Albans. The road consists of character older-style properties and is close to excellent schooling.





Important Information

These particulars do not constitute an offer or contract in whole or part. The statements contained herein are made without responsibility on the part of Ashtons or the vendors and they cannot be relied upon as representatives of fact. In respect of floor plans, these are for illustrative purposes only. The measurement and position of each element is approximate and must be viewed as such. Intending purchasers should therefore satisfy themselves by inspection or otherwise as to their correctness. The vendors do not make or give, and neither Ashtons nor any person in their employment has any authority to make or give, any representation or warranty whatsoever in relation to this property. We offer a wide range of services through third party providers including solicitors, surveyors, removal firms, mortgage providers and EPC suppliers. We receive additional payments for administering suppliers quoting software and making referrals. You are not under any obligations to use these services and it is your discretion whether you choose to deal with these parties or your own preferred supplier. You should be aware the average payment we received in 2021 equated to £48.36 per referral.

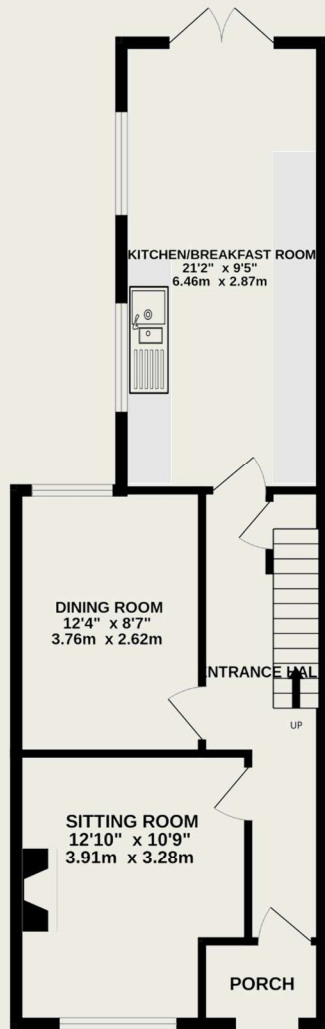

GROUND FLOOR
539 sq.ft. (50.1 sq.m.) approx.



1ST FLOOR
535 sq.ft. (49.7 sq.m.) approx.

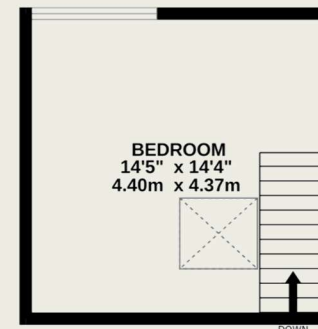

2ND FLOOR
207 sq.ft. (19.2 sq.m.) approx.

TOTAL FLOOR AREA : 1281 sq.ft. (119.0 sq.m.) approx.

This floor plan is for illustrative purposes only. The measurement and position of each element is approximate and must be viewed as such