



2 Bedrooms



1 Bathroom



1 Reception Room



On-Street Parking



80ft approx.



EPC Band D

Council Tax
Band: D £2,257.13 (2025/2026)
Local Authority
St Albans City & District Council



Upper Culver Road, St. Albans, AL1 4EE
Guide Price £565,000 Freehold

Upper Culver Road, St. Albans

A beautifully presented two bedroom Victorian terraced house with a rear garden measuring approximately 80ft set in a highly desirable location, just a stone's throw from Bernards Heath Junior School and within easy walking distance of St Albans mainline station and City centre.

- 🏡 Beautifully Presented Victorian Cottage Over Two Floors
- 🏡 Open Plan Living/Dining Room
- 🏡 Stylish Bathroom
- 🏡 Two Bedrooms
- 🏡 Close to Highly Regarded Schooling
- 🏡 80ft Rear Garden
- 🏡 Walking Distance to St Albans City Centre & Mainline Station

Description

This Victorian property has enjoyed tasteful refurbishment and now combines period features with modern decor throughout. The ground floor offers ample reception space. An open plan lounge/dining room provides bright and spacious living and the recently renovated kitchen, equipped with modern appliances, has the identical sunny aspect. Additionally, the owners have added bespoke storage units underneath the stairs.

To the first floor a large principal bedroom and one further good size bedroom can be found. These are serviced by the family bathroom, presented in the same modern décor as the rest of the property. The property also benefits from a spacious boarded loft with shelving.

Externally, there is on-street parking and a long, manicured garden that is mainly laid to lawn with a patio area and shed to the rear.

Location

Upper Culver Road is conveniently positioned within walking distance of the many amenities of St Albans city centre and the mainline station. Highly regarded schools are close by and the open space of Bernards Heath is on the doorstep.





Important Information

These particulars do not constitute an offer or contract in whole or part. The statements contained herein are made without responsibility on the part of Ashtons or the vendors and they cannot be relied upon as representatives of fact. In respect of floor plans, these are for illustrative purposes only. The measurement and position of each element is approximate and must be viewed as such. Intending purchasers should therefore satisfy themselves by inspection or otherwise as to their correctness. The vendors do not make or give, and neither Ashtons nor any person in their employment has any authority to make or give, any representation or warranty whatsoever in relation to this property. We offer a wide range of services through third party providers including solicitors, surveyors, removal firms, mortgage providers and EPC suppliers. We receive additional payments for administering suppliers quoting software and making referrals. You are not under any obligations to use these services and it is your discretion whether you choose to deal with these parties or your own preferred supplier. You should be aware the average payment we received in 2018 equated to £38.00 per referral.

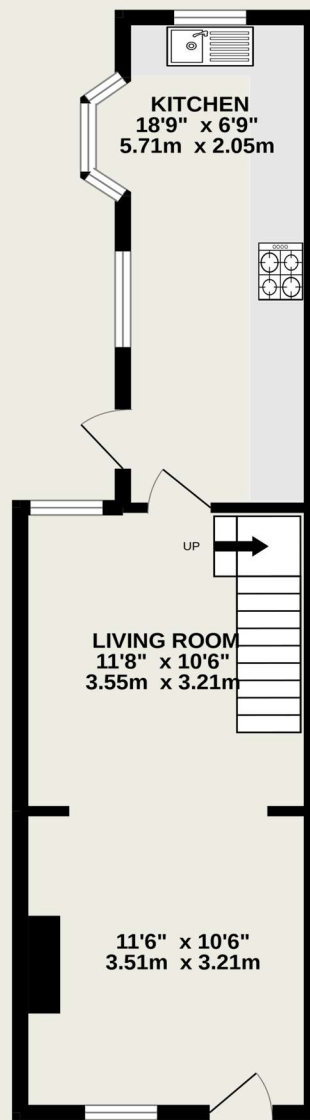

GROUND FLOOR
372 sq.ft. (34.6 sq.m.) approx.

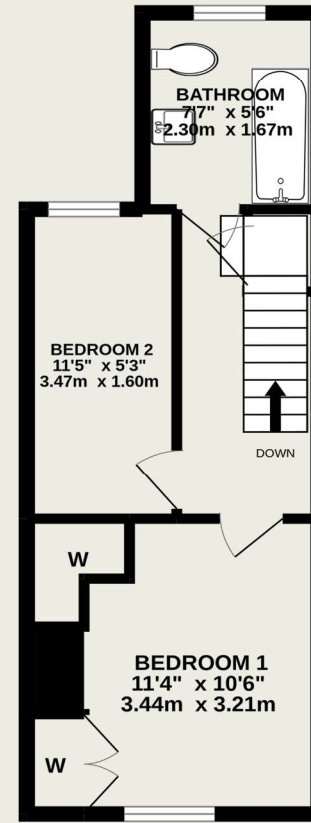

1ST FLOOR
286 sq.ft. (26.6 sq.m.) approx.

TOTAL FLOOR AREA : 659 sq.ft. (61.2 sq.m.) approx.

This floor plan is for illustrative purposes only. The measurement and position of each element is approximate and must be viewed as such

