



2 Bedrooms



1 Bathroom



2 Reception Rooms



On-Street Parking



Walled Garden



EPC Band D

Council Tax

Band: E £2,758.72

Local Authority

St Albans City & District
Council

 **ashtons**
for life's great moves



Lower Dagnall Street, St. Albans, St Albans, AL3 4PE
Guide Price £600,000 Freehold

Lower Dagnall Street, St. Albans, AL3 4PE

A beautifully presented, two bedroom, Grade II listed character cottage, positioned within the heart of St. Albans conservation area.

🏡 Beautifully Presented Grade II Listed Character Cottage

🏡 Arranged Over Four Floors

🏡 Two Bedrooms

🏡 Conservation Area Location

🏡 Two Reception Rooms

🏡 Walled Landscaped Rear Garden

🏡 Close to St Albans City Centre & Mainline Station

Description

This charming cottage has light and bright accommodation spread across four floors with a plethora of period features. The accommodation includes an open-plan living room and kitchen with stairs down to the versatile basement. To the first floor you have a spacious principal bedroom and a family bathroom, and a further bedroom is on the second floor.

To the rear you have a pretty, walled garden which has been beautifully landscaped to make it low maintenance and includes a patio seating area and various flower borders and mature trees and shrubs.

Location

Lower Dagnall Street is a well-regarded road set within the heartbeat of the St Albans conservation area, moments from the Abbey precincts whilst having the convenience of the transport links and City centre amenities just a short walk away.





Important Information

These particulars do not constitute an offer or contract in whole or part. The statements contained herein are made without responsibility on the part of Ashtons or the vendors and they cannot be relied upon as representatives of fact. In respect of floor plans, these are for illustrative purposes only. The measurement and position of each element is approximate and must be viewed as such. Intending purchasers should therefore satisfy themselves by inspection or otherwise as to their correctness. The vendors do not make or give, and neither Ashtons nor any person in their employment has any authority to make or give, any representation or warranty whatsoever in relation to this property. We offer a wide range of services through third party providers including solicitors, surveyors, removal firms, mortgage providers and EPC suppliers. We receive additional payments for administering suppliers quoting software and making referrals. You are not under any obligations to use these services and it is your discretion whether you choose to deal with these parties or your own preferred supplier. You should be aware the average payment we received in 2021 equated to £48.36 per referral.

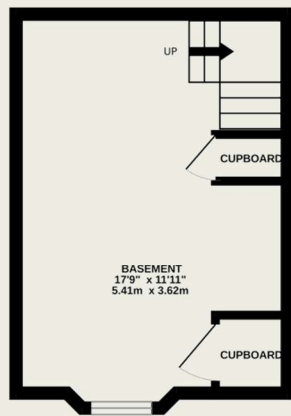

BASEMENT LEVEL
200 sq.ft. (18.6 sq.m.) approx.

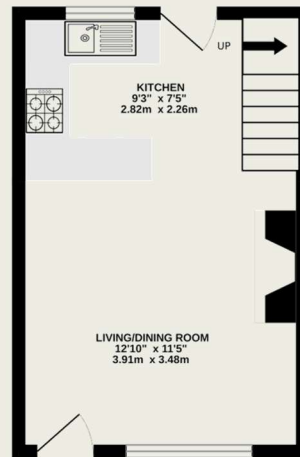

GROUND FLOOR
230 sq.ft. (21.3 sq.m.) approx.



1ST FLOOR
229 sq.ft. (21.3 sq.m.) approx.

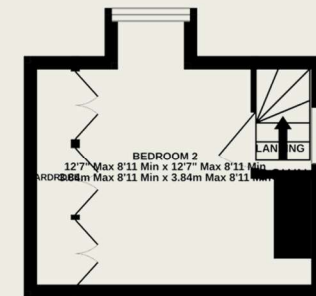

2ND FLOOR
128 sq.ft. (11.9 sq.m.) approx.

TOTAL FLOOR AREA : 787 sq.ft. (73.1 sq.m.) approx.

This floor plan is for illustrative purposes only. The measurement and position of each element is approximate and must be viewed as such