

RIVERHOMES

Imperial Wharf
Fulham SW6

£250,000
Leisure or Pied-a-Terre Mooring



Imperial Wharf Fulham SW6

Zelig is a 72 ft. Delta Marine Dutch Luxemotor moored at Imperial Wharf, Fulham. With 2 bedrooms, a bathroom and open-plan kitchen/dining/living area, it would make a wonderful and very comfortable pied-à-terre. Zelig is fully navigable and the wheelhouse is collapsible, offering more scope for cruising further afield. All mod cons - including central heating, Bose sound system and multi fuel burner. Built in 2006, it is very well presented and flooded with light. Moored on a pied a terre licence at Imperial Wharf, Fulham, she has wonderful full river views. Fob access to pier. Parking available by separate arrangement. Electricity

is metered and high speed fibre-optic broadband is connected. Imperial Wharf Overground Station is one stop away from Clapham Junction National Railway Station, one stop from West Brompton Overground and Underground (District Line) Station and only a short drive from Sloane Square.

KEY FEATURES

Two bedroom houseboat

Open-plan kitchen / living room / dining room

Collapsible wheelhouse

Open-plan kitchen/dining/living area

Bose sound system and multi fuel burner

Mooring fees (leisure): £18,000 per annum approx.

Internal area: 759 sq. ft. / 70.5 sq. m.

No stamp duty or council tax

Dome on upper deck





ZELIG, IMPERIAL WHARF

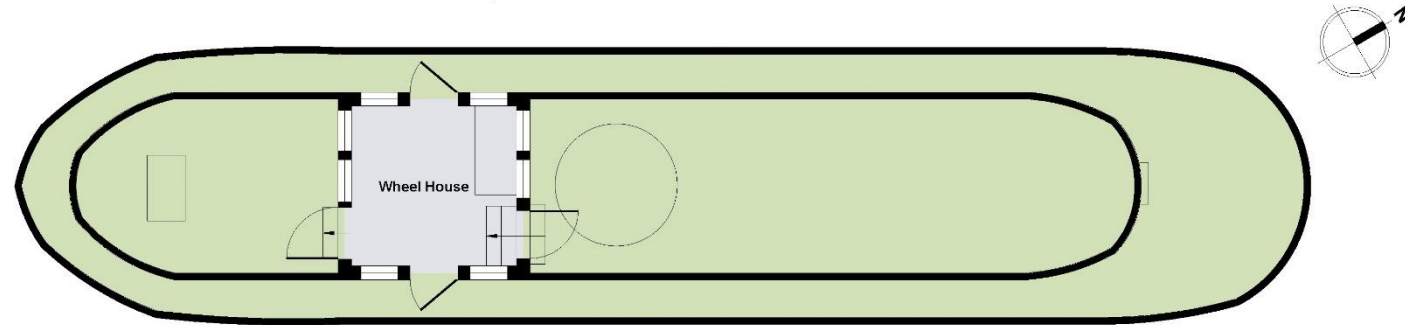

Upper Deck
Approximate Floor Area
69 sq. ft
(6.38 sq. m)

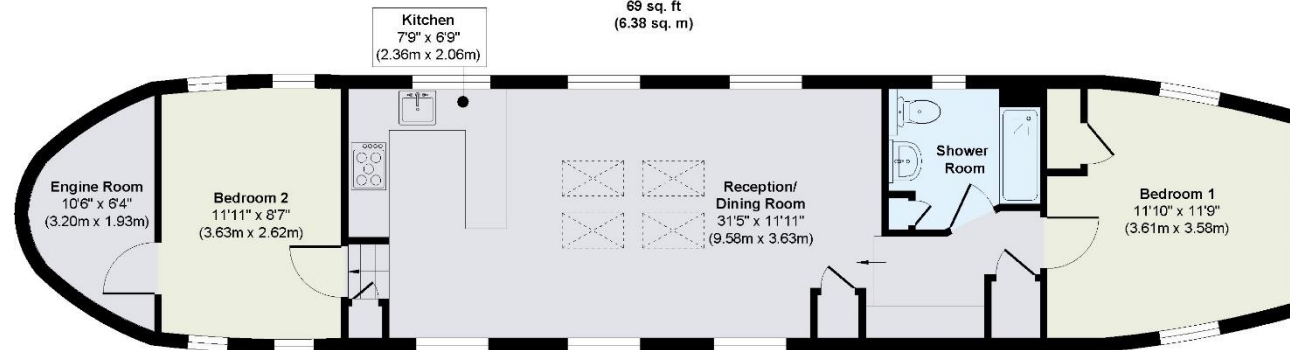

Lower Deck
Approximate Floor Area
690 sq. ft
(64.12 sq. m)

Approx. Gross Internal Floor Area 759 sq. ft / 70.50 sq. m

Illustration for identification purposes only, measurements are approximate, not to scale.