

RIVERHOMES

Albion Quay,
Battersea, SW11

£600,000
Residential Mooring



Albion Quay, Battersea, SW11

Located at Albion Quay by the charming and popular conservation area of Battersea Square, 'Sonnet' is a (28.65 m. x 5 m.) Belgian luxe motor barge. She has been converted for contemporary living yet maintains her classic Continental features.

Accommodation includes an unusually large wheelhouse. A door opens onto a generous deck area where you can enjoy outside living and of course those stunning views. Downstairs, the stern cabin is well proportioned - airy and bright with an en suite shower room/lavatory. A large

skylight and windows provide natural light all year round - in addition to the ever-changing views of the tidal Thames. Forward from the engine room there is a separate fully equipped kitchen. Moving further forward you enter an open-plan dining/lounge area with high level portholes and a large skylight. Towards the bow are two cosy bedrooms with small, high level portholes, alongside a high-ceilinged shower room with lavatory and sink. There is a superb master bedroom with high ceiling, built in wardrobes and en suite bathroom/lavatory.

KEY FEATURES

Mooring and Maintenance fee: £4,500 p.a. approx.

Council Tax: Band A - £549 for 2020/21

Residential Mooring

Three bedrooms and fourth extra study / bedroom

Converted for contemporary living

Large skylight and windows providing natural light

Fantastic family home

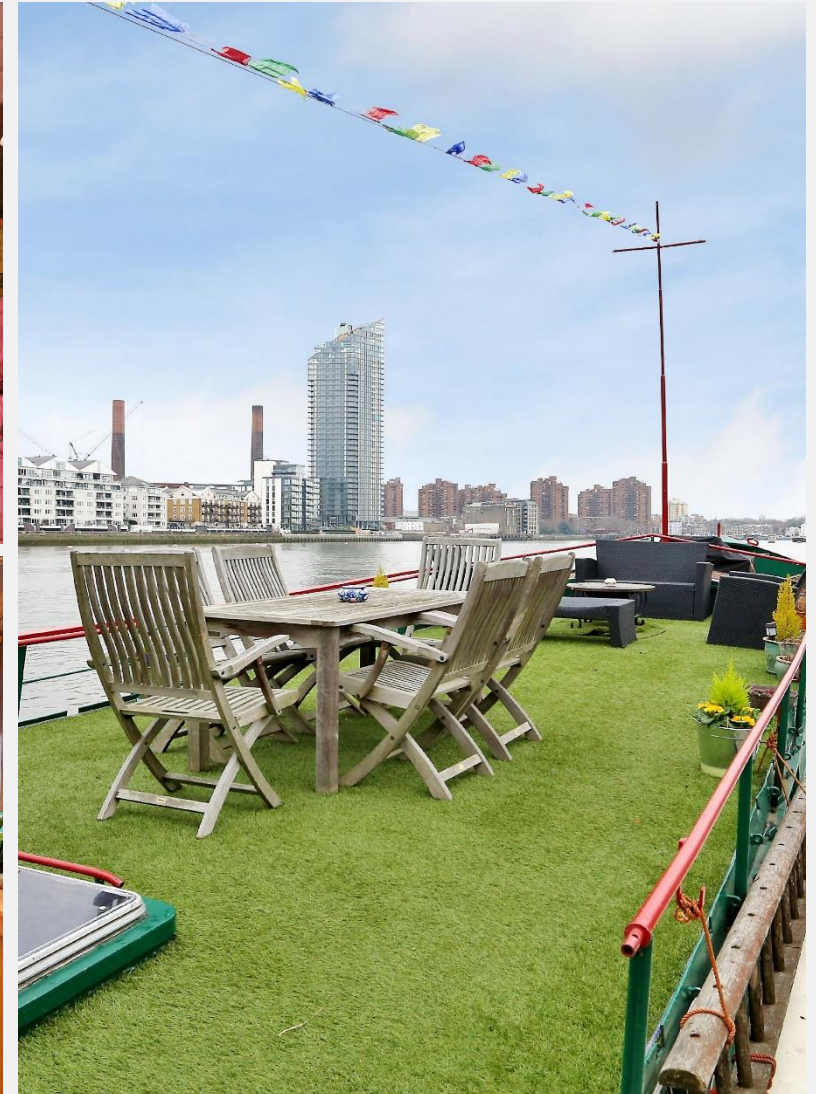



KEY INFORMATION

Local authority:	London Borough of Wandsworth
Internal area:	1,444 sq. ft. / 134.15 sq. m.
Garden area:	Deck
No. of bedrooms:	3

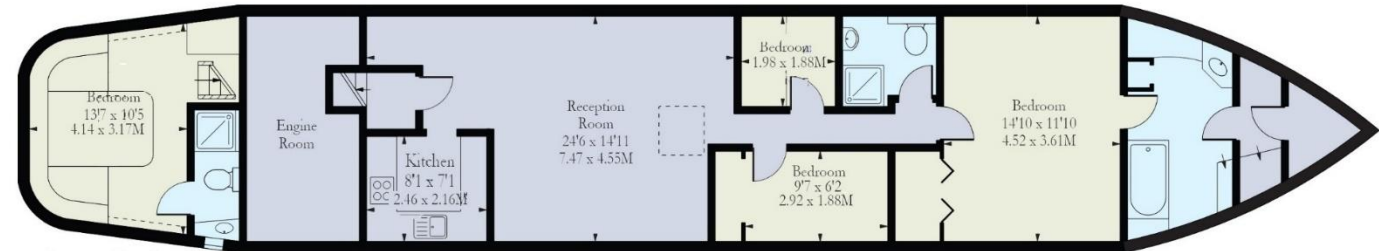

Lower Deck

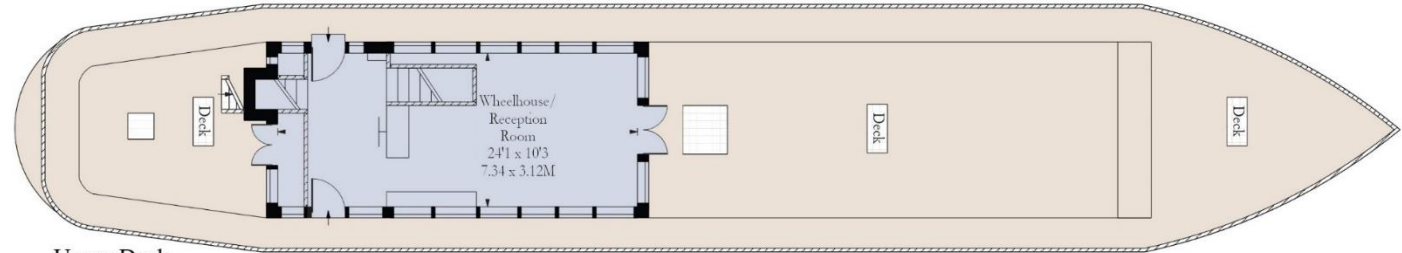

Upper Deck

