

# RIVERHOMES

Regents Canal Towpath  
Lisson Grove NW8

£140,000  
Leisure





## Regents Canal Towpath Lisson Grove NW8

Quetzal is a charming and exceptionally well-maintained 50ft narrowboat, moored at the highly sought-after Lisson Grove—widely regarded as one of the friendliest and most vibrant residential moorings in London. With a fully transferable residential licence, this is a rare opportunity to enjoy central London living with a strong sense of community. Just minutes from Regent's Park, St. John's Wood, Paddington, and the West End, the location offers both tranquillity and unbeatable convenience. Quetzal underwent a professional repaint just two years ago (£8,000), along with hull blacking and new anodes. The last survey was completed in 2020, with all recommendations addressed. The boat is in excellent mechanical condition, with a regularly serviced engine and a recently refurbished alternator.

A bow thruster adds ease and precision when manoeuvring. Inside, the boat offers a warm and inviting interior. A cosy double cabin is located at the rear, while a large guest bed can be set up in the living area. The well-equipped kitchen includes a gas stove, 12V fridge, microwave, and a small deep freeze—thoughtfully laid out for practical living. The engineered oak flooring, installed three years ago, adds a touch of elegance throughout. Quetzal is fully insulated and features a central heating system with four radiators, powered by a new diesel heater installed in November 2024. A new composting toilet was also fitted in October 2024. The boat is fitted with an inverter for off-grid power, making it ideal for both mooring and cruising the canal network.

### KEY FEATURES

**1 bedroom**

**1 bathroom**

**Regularly serviced engine and refurbished alternator**

**Oak flooring**

**Fully insulated with central heating**

**New composting toilet**

**A professional repaint only 2 years ago**

**Minutes from Regents Park, St. John's Woods, Paddington and the West End**

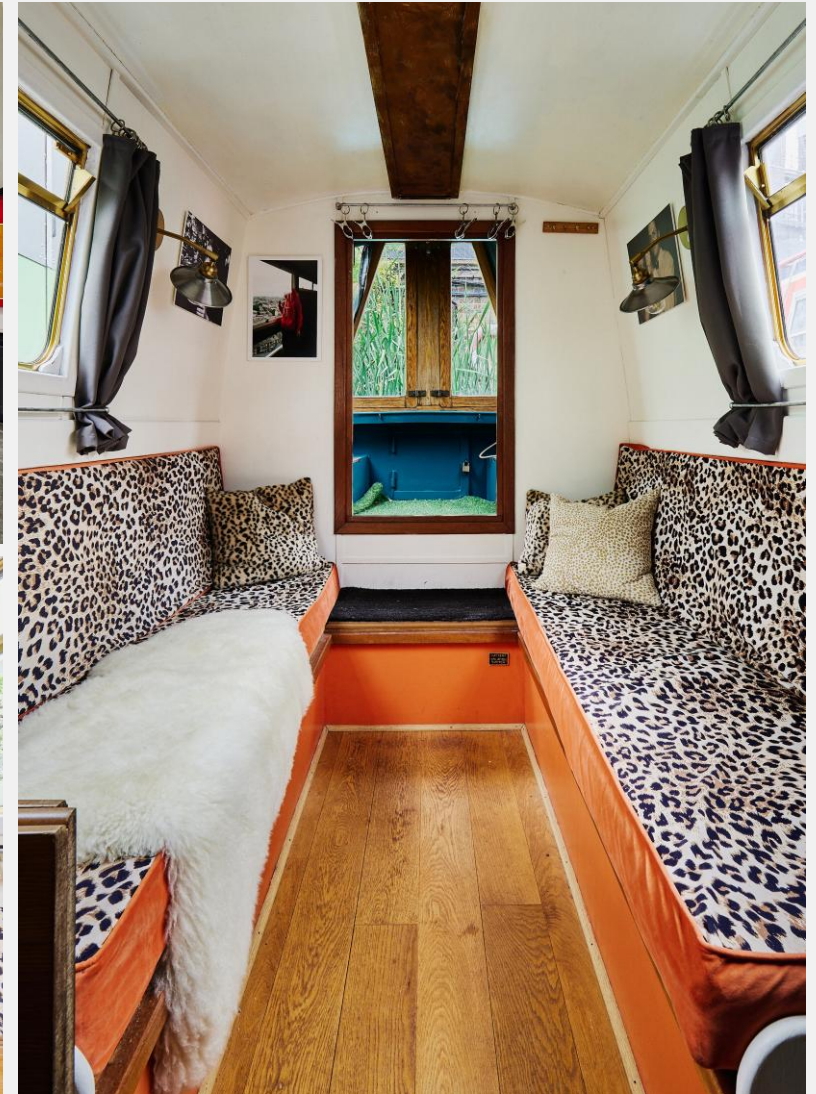



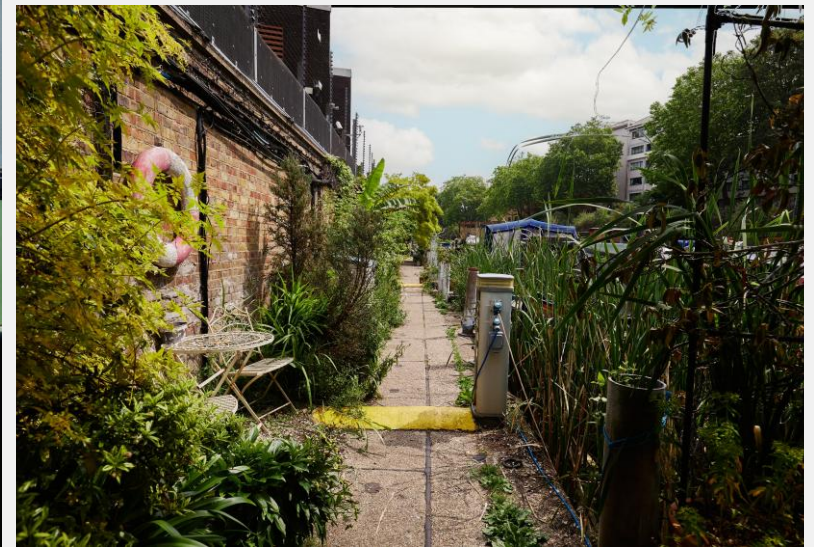

KEY INFORMATION

Internal area:	193 sq. ft. / 18.02 sq. m.
No. of bedrooms:	1
Mooring charges:	£674 per month approx.

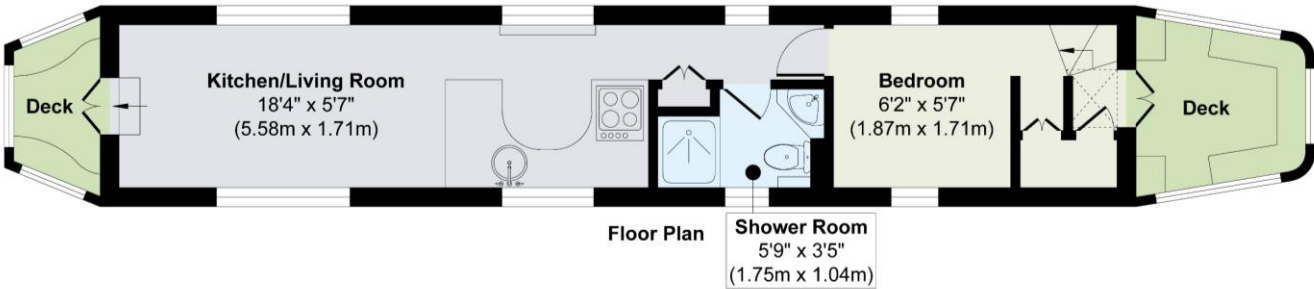

World Waterside Ltd trading as riverhomes for themselves and its clients give notice that 1: They are not authorised to make or give any representations or warranties in relation to the property either here or elsewhere, either on their own behalf or on behalf of their client or otherwise. 2: These particulars do not form part of any offer or contract and must not be relied upon as statements or representations of fact. Any areas, measurements or distances are approximate. The text, photographs and plans are for guidance only and are not necessarily comprehensive. 3: It should not be assumed that the property has all necessary planning, building regulation or other consents and any services, equipment or facilities have not been tested. 4: Lease details, service charges, ground rent (where applicable) and council tax are given as a guide only and should be checked and confirmed by your Solicitor prior to exchange of contracts. 5: They assume no responsibility and any intending purchasers or tenants must satisfy themselves by inspection or otherwise as to the correctness of each of the statements contained within these particulars. If you require clarification of any points please contact us.