

RIVERHOMES

**St Katharine Docks
Wapping E1W**

**£250,000
Leisure Mooring**



St Katharine Docks Wapping E1W

A wonderful opportunity to acquire this Morgan Giles-built Monaco 52 powerboat, originally owned by Sir Thomas Sopwith (source: Morgan Giles Archive). Now fully restored by the current owners to an exceptional standard. While appreciating and respecting its original charm, the boat has been made more suitable for liveaboard accommodation. The wheelhouse has been preserved and restored to maintain its character. From the wheelhouse, you step onto the large aft deck, perfect for entertaining and dining. With nearly 360 degrees of natural light filling almost the entire living space, it truly offers the perfect opportunity to enjoy time on the water. The open-plan kitchen features fitted units and a breakfast bar area, perfect for enjoying the view at any time of the day. A door leads you down to the vessel's bow, where you have the potential to create a third bedroom, a home

office/study, and a utility room. This area is currently partially renovated, offering a great opportunity for customization. In addition you have ample storage space under the living room. The saloon leads to a fully fitted galley and a door to a utility room. The yacht features a beautifully refitted bathroom, a second bedroom with double bed, and a master cabin with a super king bed located in the aft of the yacht.

The yacht is currently moored at St Katharine Docks, Central London's premier marina, just a short distance from Tower Bridge. This vibrant community is one of London's hidden gems, offering an unrivalled location for working, living, and relaxing. Transport options are numerous, with Tower Hill Underground Station and Tower Gateway National Rail station only moments away.

- KEY FEATURES
- Monaco 52 powerboat
 - 2 bedrooms
 - Option of 3rd bedroom
 - Beautifully refitted bathroom
 - Restored wheelhouse
 - Large aft deck
 - Fully fitted galley
 - Utility room
 - Ample storage
 - Conveniently located close to shops, restaurants and public transport





KEY INFORMATION

Local authority: London Borough of Tower Hamlets

Internal area: 545 sq. ft. / 50.6 sq. m.

No. of bedrooms: 2

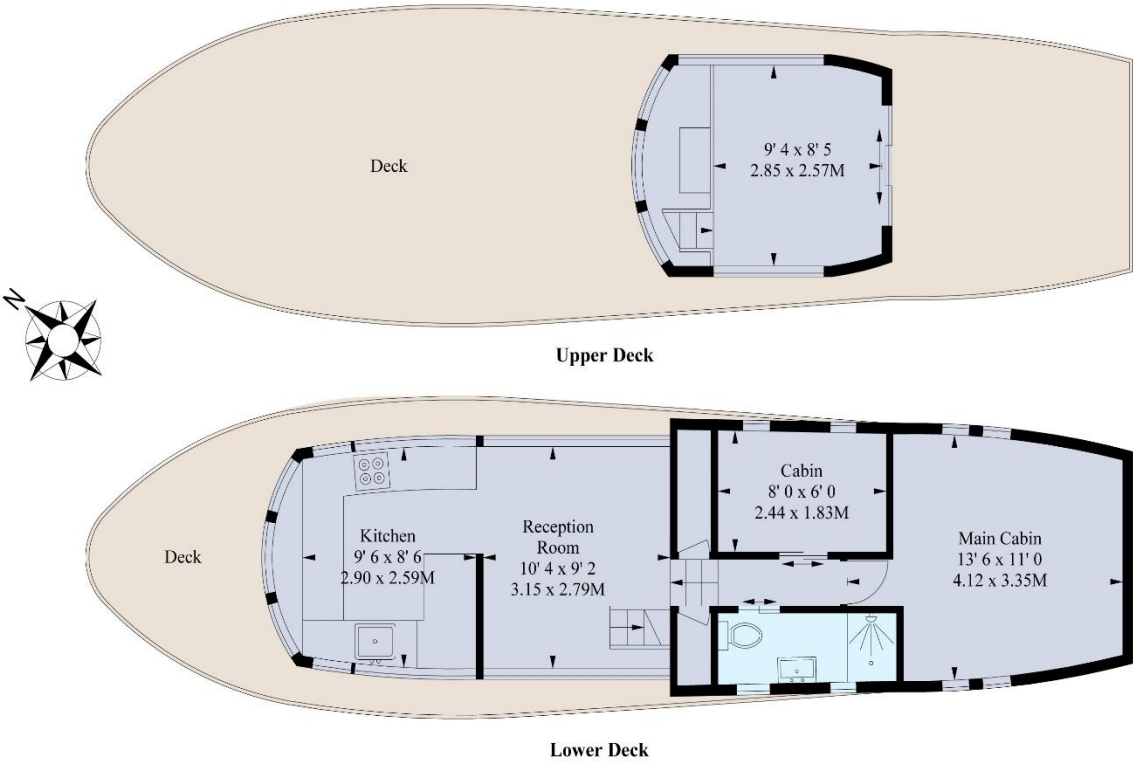

World Waterside Ltd trading as riverhomes for themselves and its clients give notice that 1: They are not authorised to make or give any representations or warranties in relation to the property either here or elsewhere, either on their own behalf or on behalf of their client or otherwise. 2: These particulars do not form part of any offer or contract and must not be relied upon as statements or representations of fact. Any areas, measurements or distances are approximate. The text, photographs and plans are for guidance only and are not necessarily comprehensive. 3: It should not be assumed that the property has all necessary planning, building regulation or other consents and any services, equipment or facilities have not been tested. 4: Lease details, service charges, ground rent (where applicable) and council tax are given as a guide only and should be checked and confirmed by your Solicitor prior to exchange of contracts. 5: They assume no responsibility and any intending purchasers or tenants must satisfy themselves by inspection or otherwise as to the correctness of each of the statements contained within these particulars. If you require clarification of any points please contact us.