

# RIVERHOMES

Riverlight Quay  
Vauxhall SW11

£3,750 per month  
Furnished





## Riverlight Quay Vauxhall SW11

A stunning 5th floor, two bedroom apartment in Nine Elms' Riverlight Quay. A spacious reception with direct access to a private balcony, contemporary open-plan kitchen, master bedroom with en suite and access to a second balcony. There is second double bedroom and a family bathroom. This superb apartment offers bright, spacious accommodation in the heart of Nine Elms' riverside and benefits from a striking, contemporary interior.

Residents of Riverlight Quay benefit from Leisure Suite with Gym and Swimming pool, virtual golf, cinema room, business centre, communal gardens and a 24 hour concierge. Transport links are available from Vauxhall Station (National Rail and Victoria Line), Nine Elms Underground (Northern line). Thames Clippers at St George Wharf provide regular and fast connections to key commuter hubs, including Canary Wharf, Tower Hill, London Bridge, Greenwich, Embankment and Waterloo.

### KEY FEATURES

**Local Authority: London Borough of Wandsworth**

**Two bedroom apartment**

**Spacious reception room**

**Private balcony**

**Open-plan kitchen**

**Access to gym, swimming pool and business centre**

**24 hour concierge service**

**Fantastic location**

**Council tax: Band F - £1,372.36 for 2023/24**

**EPC rating B**





## KEY INFORMATION

<b>Local authority:</b>	London Borough of Wandsworth
<b>Internal area:</b>	778 sq. ft. / 72 sq. m.
<b>Garden area:</b>	Balcony
<b>No. of bedrooms:</b>	2

## Energy Efficiency Rating

Very energy efficient - lower running costs

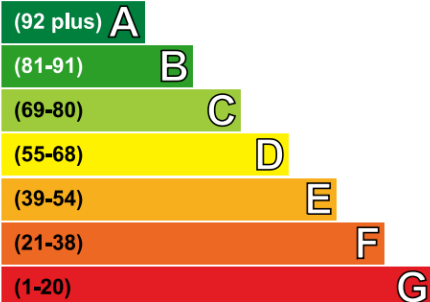

Not energy efficient - higher running costs

Current	Potential
81	82

## RIVERLIGHT QUAY, NINE ELMS SW11

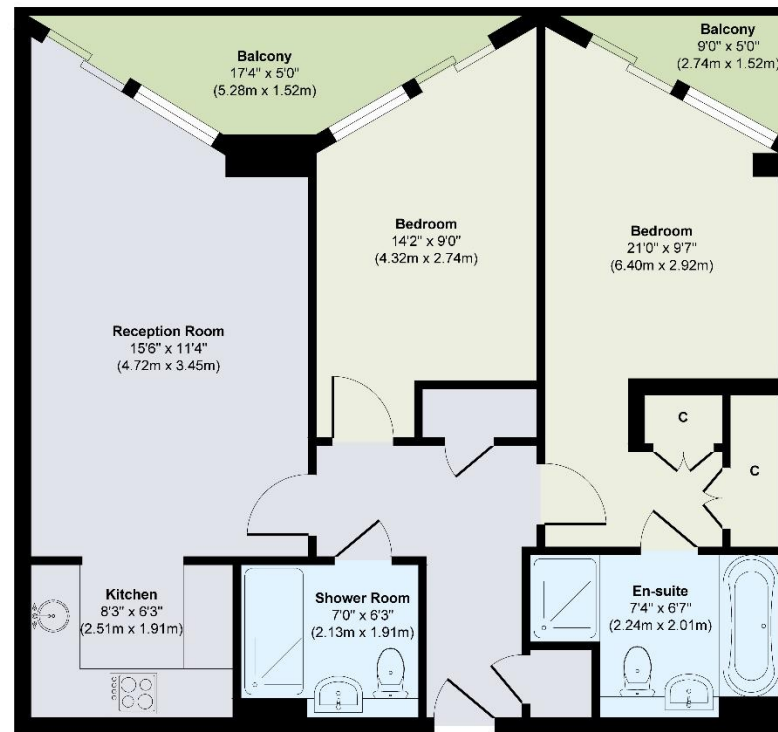

Fifth Floor  
Approximate Floor Area  
778 sq. ft  
(72.27 sq. m)

**Approx. Gross Internal Floor Area 778 sq. ft / 72.27 sq. m**

Illustration for identification purposes only, measurements are approximate, not to scale.