

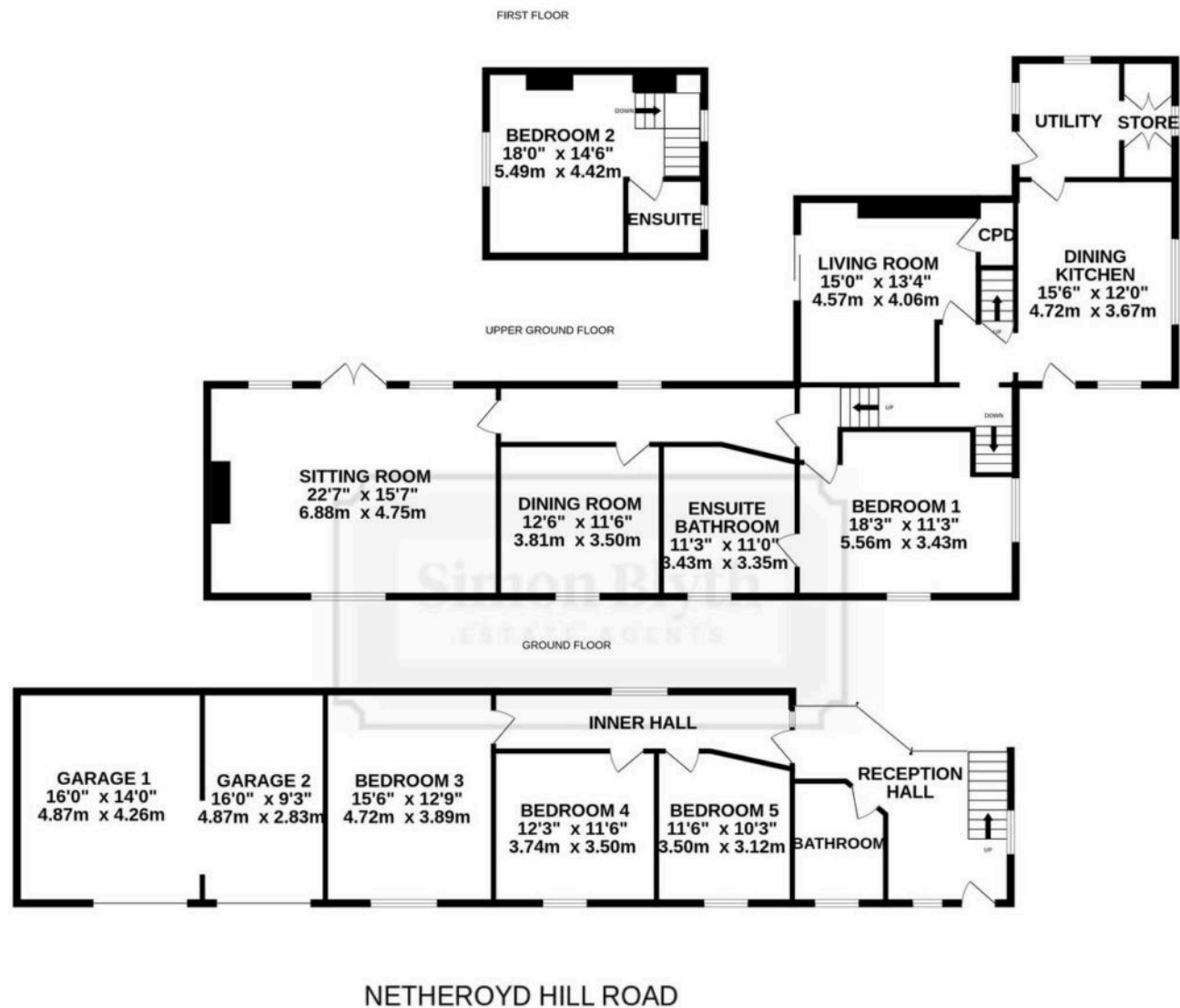

Cowcliffe Farm
Netheroyd Hill Road

Offers in Region of **£995,000**



Whilst every attempt has been made to ensure the accuracy of the floorplan contained here, measurements of doors, windows, rooms and any other items are approximate and no responsibility is taken for any error, omission or mis-statement. This plan is for illustrative purposes only and should be used as such by any prospective purchaser. The services, systems and appliances shown have not been tested and no guarantee as to their operability or efficiency can be given.

Made with Metropix ©2025



169 Netheroyd Hill Road

Cowcliffe, Huddersfield

Cowcliffe Farm is a substantial stone built and slated detached home with great character with a stone cobbled driveway, double garage and gardens with a curtilage of just over $\frac{1}{2}$ an acre and enjoying fabulous views over Huddersfield. In addition there is an adjacent grassed area of around $\frac{1}{2}$ an acre rented from Kirklees.

This delightful property has versatile split level accommodation which offers flexibility together with gas central heating system, hardwood sealed unit double glazing and briefly comprising the upper ground floor; dining kitchen, utility room with store off, living room, sitting room, dining room, master bedroom and en suite bathroom. First floor; bedroom two with en suite shower room, ground floor reception hall, inner hall, three further double bedrooms and family bathroom. The gardens incorporate large stone flagged patio with koi carp pond and brick set patio. There is also a public footpath which runs along the dry stone wall boundary to the front of the property.



Upper Ground Floor

Dining Kitchen

15' 6" x 12' 0" (4.72m x 3.66m)

This has a timber panelled and leaded glazed door, there are stone mullioned sealed unit double glazed windows to two elevations, heavily beamed ceiling with velux double glazed window and all of these provide the room with plenty of natural light. There is a tiled floor, central heating radiator and a range of medium oak faced base and wall cupboards, drawers, contrasting overlying granite worktop, leaded and glazed display cupboards, wine rack, storage shelves and housed within a stone chimney breast there is a Bosch five ring stainless steel gas hob, recessed stainless steel electric double oven, integrated dishwasher, under counter space for washing machine, tumble dryer and freezer. To one side a timber and frosted glazed door gives access to the utility room.

Utility Room

9' 0" x 8' 0" (2.74m x 2.44m)

This has a mono pitched timber clad ceiling, dual aspect sealed unit double glazed windows and a timber panelled and glazed door giving access to the garden, there is a tiled floor, base and wall cupboards, overlying worktops, Belfast sink with antique style mixer tap and under counter space for washing machine and tumble dryer. To one side there is a doorway giving access to a store/boiler room, this has a frosted double glazed window, ceiling light point, tiled floor and fitted with louvered door cupboards which provide useful storage as well as housing a hot water cylinder.

Inner Lobby

This gives access to the first floor, living room and the remaining upper ground floor accommodation.



Living Room

15' 0" x 13' 3" (4.57m x 4.04m)

A comfortable and well proportioned reception which has timber and sealed unit double glazed French doors which provide the room with plenty of natural light and look over the garden, there is a beamed ceiling, central heating radiator, four wall light points, useful storage cupboard beneath the stairs and as the main focal point of the room there is a fireplace with oak surround, granite inset and having an open fire and black granite hearth.

Landing

A short flight of 5 steps from the inner lobby leads to the landing. This timber panelled and frosted glazed door opening onto a further landing with stone mullioned sealed unit double glazed window looking out over the garden, there is a beamed ceiling, three wall light points and at the far end a timber panelled door opens into the sitting room.

Sitting Room

22' 7" x 15' 7" (6.88m x 4.75m)

As the dimensions indicate this is a particularly spacious reception room which enjoys some stunning far reaching views to the front elevation through stone mullioned sealed unit double glazed windows with window seat beneath and oak lintel. The rear elevation once again has stone mullioned sealed unit double glazed windows together with central sealed unit double glazed French doors which open onto a sealed unit patio. There is a heavily beamed ceiling, three wall light points, two central heating radiators, reclaimed maple flooring from Gannex Mill in Elland and as the main focal point of the room there is a beautiful fireplace with oak lintel, brick inset and home to a multi fuel stove which rests on a brick hearth.





Dining Room

12' 6" x 11' 6" (3.81m x 3.51m)

This has stone mullioned sealed unit double glazed windows which enjoy a similar aspect to that of the sitting room, there is a heavily beamed ceiling, two wall light points and a central heating radiator.

Bedroom One

18' 3" x 11' 3" (5.56m x 3.43m)

A generously proportioned principle bedroom which has stone mullioned sealed unit double glazed windows together with window seat, feature timber and sealed unit double glazed arch window with exposed stone work and window seat and from here there are stunning far reaching views over Huddersfield. The ceiling is open to the rafters and has exposed beams and troughs, there are two wall light points, central heating radiator and a seven rise spindled staircase rises to a mezzanine area which has a bank of fitted floor to ceiling wardrobes and cupboards. To one side a timber panelled door opens into an en suite bathroom.

En Suite Bathroom

11' 3" x 11' 0" (3.43m x 3.35m)

As the dimensions demonstrate this is a particularly spacious en suite which has stone mullioned sealed unit double glazed windows once again enjoying the fabulous view, there is a heavily beamed ceiling, two wall light points, beam mounted spotlight, tiled floor, floor to ceiling tiled walls to two elevations and fitted with a four piece suite which comprises free standing roll top and bath resting on ball claw feet, pedestal wash basin, low flush WC and large tiled shower cubicle with glazed panels and door together with chrome shower incorporating fixed shower rose and separate hand spray, ladder style chrome heated towel rail.



First Floor Landing

Bedroom Two

18' 0" x 14' 6" (5.49m x 4.42m)

A lovely guest room which is open to the rafters and has beams and exposed troughs, there are stone mullioned sealed unit double glazed windows to both front and rear elevations which provide plenty of natural light, there are exposed polished and stained floor boards, wall light point, recessed for wardrobe placement and as the main focal point of the room there is a lovely stone fireplace with decorative cast iron inset and resting on a stone flagged hearth. To one side a door gives access to an en suite shower room.

En Suite Shower Room

5' 9" x 5' 4" (1.75m x 1.63m)

With beamed ceiling with inset ceiling down lighters, sealed unit double glazed window, central heating radiator and fitted with a suite comprising pedestal wash basin, low flush WC and tiled shower cubicle with glass door and having a fixed shower rose.

Ground Floor

Reception Hall

11' 6" x 9' 6" (3.51m x 2.90m)

This has timber panelled and leaded stained glass door with adjacent sealed unit double glazed window with further stone mullioned window to the side of the staircase, there is a lovely stone flagged floor, central heating radiator and to one side a spindled staircase with useful storage cupboard beneath rises to the upper ground floor. From here access can be gained to the following..-





Bathroom

9' 3" x 7' 0" (2.82m x 2.13m)

With frosted stone mullioned sealed unit double glazed window, beamed ceiling with angled spotlights, central heating radiator, there are exposed roof timbers together with exposed stone work and display niches and fitted with a suite comprising roll top cast iron bath resting on bowl and claw feet with mixer tap incorporating hand spray, pedestal wash basin and low flush WC.

Inner Hallway

Which has stone mullioned sealed unit double glazed windows, two wall light points and central heating radiator.

Bedroom Three

15' 6" x 12' 9" (4.72m x 3.89m)

A large double room which has stone mullioned sealed unit double glazed windows and enjoying some lovely far reaching views, there is a beamed ceiling, two wall light points and central heating radiator.

Bedroom Four

12' 3" x 11' 6" (3.73m x 3.51m)

A double room with stone mullioned sealed unit double glazed windows, once again enjoying some lovely far reaching views, there is a beamed ceiling, wall light point and central heating radiator.

Bedroom Five

11' 6" x 10' 3" (3.51m x 3.12m)

A double room currently utilised as an office and having stone mullioned sealed unit double glazed windows together with beamed ceiling and, wall light point and central heating radiator.



GARDEN

To the front of the property there are planted trees, flowers and shrubs bordered by a dry stone wall with some stunning far reaching views across Huddersfield. To the left hand side of the garage there is a short flight of steps rising to the rear garden. This has an extensive stone flagged patio which can be accessed from the sitting room with planted flowers trees and shrubs to the borders as well as feature stone koi carp pond. At the far end of the patio there are three steps leading down to a further brick set patio area which can be accessed from the living room and utility room. Above the stone flagged patio there is a sloping lawned garden which is bordered by trees and shrubs, this faces west and as such enjoys the evening sun with some spectacular views from the top of the garden stretching across Huddersfield with Emley Moor Mast on the horizon. In total the property stands in just over half an acre. In addition to the side of the garden there is a further lawned area which is rented from Kirklees council which is currently £100 per annum and once again from here there are stunning views over Huddersfield.

Garage

The property is approached along a lane over which the neighbouring property has a right of way, at the end of the lane a five bar timber hand gate opens onto a gravel drive which provides off road parking and this in turn becomes a stone cobbled drive which runs across the front elevation and provides parking for a number of vehicles as well as giving access to the double garaging. Garage One is 16' x 14' with an up and over door, light and there is a doorway leading to garage two. Garage Two is 16' x 9'3" with up and over door, outside cold water tap, light and power and with a doorway leading into garage one.





VIEWING For an appointment to view, please contact the Huddersfield Office on 01484 651878

BOUNDARY OWNERSHIP The boundary ownerships and tenure of the property have not been checked on the title deeds for any discrepancies or rights of way if any (This is a standard statement on all our brochures due to the Property Misdescription's Act)

COPYRIGHT Unauthorised reproduction prohibited.

FREE VALUATIONS If you are thinking of a move then take advantage of our FREE valuation service, telephone our nearest office for a prompt and efficient service.

CONSUMER PROTECTION FROM UNFAIR TRADING REGULATIONS 2008
Simon Blyth for themselves and for the vendors or lessors of this property, whose agent they are, have made every effort to ensure the details given have been prepared in accordance with the above act and to the best of our knowledge give a fair and reasonable representation of the property.

Please note:

1. There is a six inch measurement tolerance or metric equivalent and the measurements given should not be entirely relied upon and purchasers must make their own measurements if ordering carpets, curtains or other equipment.
2. None of the main services, i.e. gas, water, electricity, drainage or central heating system (if any) have been tested in any way whatsoever. This also includes appliances which are to be left in situ by the vendors.

PURCHASERS MUST SATISFY THEMSELVES AS TO THE CONDITION AND EFFECTIVENESS OF ANY SUCH APPLIANCES OR SERVICES FLOOR PLANS NOT TO SCALE - FOR IDENTIFICATION PURPOSES ONLY.

MAILING LIST Keep up to date with all our new properties. Let us know your price range, the area and type of home you require by registering on our mailing list.

MORTGAGE ADVICE Simon Blyth Estate Agents understand that getting appropriate mortgage advice is a crucial part of the home buying process. Finding a suitable mortgage has always been something of a daunting experience which is why we would like to introduce you to our independent mortgage advisors. They provide tailored mortgage solutions through a wealth of experience in the mortgage and property market and offer access to the full unrestricted range of products available. Our advisors are dedicated to providing ongoing guidance and advice throughout the entire house purchase process keeping you, your estate agent and solicitor involved with continual updates on the progress. Once in your new home they will be available for ongoing support to build a long term relationship for your future mortgage planning. Your home may be repossessed if you do not keep up repayments on your mortgage. For friendly expert advice on your mortgage requirements, or to discuss the potential of making your ideas a reality then please call in or phone for a chat.

OFFICE OPENING TIMES 7 DAYS A WEEK

Monday to Friday - 8:45 am to 5:30 pm

Saturday - 9:00 am - 4:00 pm Sunday - 11:00 am - 2:00 pm



Simon Blyth Estate Agents

Simon Blyth Estate Agents, 26 Lidget Street – HD3 3JP

01484 651878

huddersfield@simonblyth.co.uk

www.simonblyth.co.uk/

Wakefield	Huddersfield	Holmfirth	Kirkburton	Penistone	Sheffield	Barnsley	Pontefract	Leeds	Halifax
01924 361631	01484 651878	01484 689689	01484 603399	01226 762400	01143 216 590	01226 731730	01977 800259	0113 4689331	01422 417000