

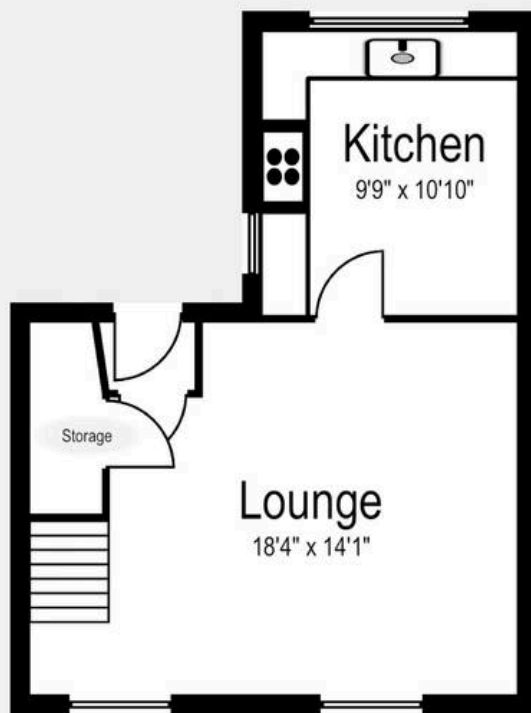

**28 Tanyard Road, Oakes**  
Huddersfield

Offers in Region of **£235,000**





Front Ground

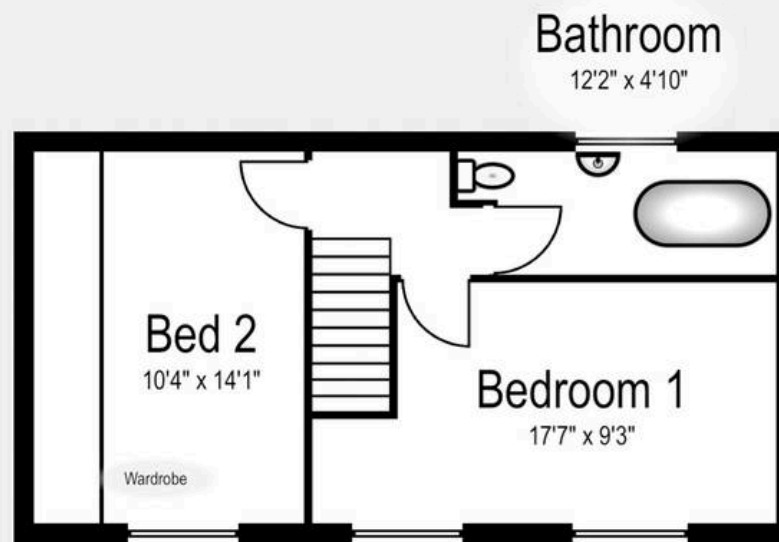

1st Floor

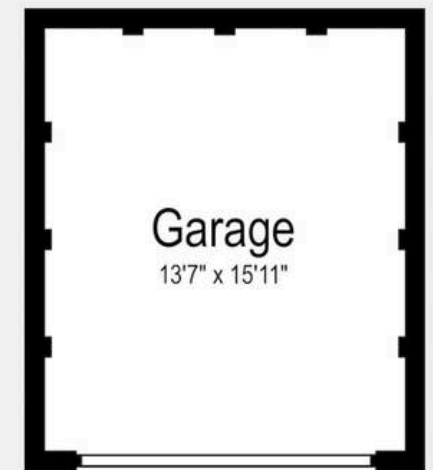



## 28 Tanyard Road

Oakes, Huddersfield

A characterful stone built two bedroom cottage with a stone slate roof providing attractively presented accommodation with features including exposed stone work, oak flooring ,oak doors and having secure gated off road parking, large garage and garden enjoying privacy. The accommodation comprises briefly to the ground floor: entrance lobby, living room and dining kitchen. First floor, two bedrooms and bathroom.

The property enjoys some lovely far reaching views particularly from first floor level or from the garden and is located within a popular and convenient residential area in close proximity to local shopping, schools and just a short drive from J23 and J24 of the M62.

Council Tax band: B





### Ground Floor

A PVCU and frosted double glazed door opens into an entrance lobby, this has decorative tiled walls to dado height, tiled floor and from here an oak plank door opens into the living room.

### Living Room

18' 3" x 14' 0" (5.56m x 4.27m)

As the dimensions indicate this is a generously proportioned room with lots of character including a beamed ceiling, exposed stone, lovely polished and stained oak floor boards and as the main focal point of the room there is a stone fireplace which is home to a wood burning stove which rests on a stone hearth. There are inset led down lighters, two column radiators, two PVCU double glazed windows both of which have fitted louvered shutters and provide the room with plenty of natural light. To one side there is an oak plank door which gives access to useful storage area beneath the stairs, this has a wall mounted Viessmann boiler, there is a cloaks rail and ceiling light point. From the living room an oak plank door opens into the dining kitchen.

### Dining Kitchen

10' 6" x 9' 7" (3.20m x 2.92m)

With a dual aspect PVCU double glazed windows which provide the room with plenty of natural light, there is a beamed ceiling with two ceiling light points, column radiator, tiled floor and fitted with a range of base cupboards and drawers complimented by contrasting overlying granite work tops, there are tiled splash backs, and inset Belfast sink with an antique style brushed stainless steel mixer tap over, range style cooker with seven ring gas hob, twin electric double ovens, grill and warming drawer (this is available by separate negotiation at a price to be agreed) there is also under counter space for washing machine and fridge.



### First Floor

### Landing

With grey plank effect laminate flooring which continues throughout the first floor. There is a beamed



## First Floor

### Landing

With grey plank effect laminate flooring which continues throughout the first floor. There is a beamed ceiling with ceiling light point and a loft access. From here access can be gained to the following rooms..-

### Bedroom One

17' 5" x 9' 3" (5.31m x 2.82m)

A generous double room with lots of natural light from two PVCU double glazed windows which take advantage of some lovely far reaching views, there is beamed ceiling with inset ceiling down lighters, exposed stone work, column radiator and two wall light points.

### Bedroom Two

14' 5" x 7' 2" (4.39m x 2.18m)

With PVCU double glazed window enjoying a similar aspect that of bedroom one, there are inset down lighters, column radiator and to one wall there are a bank of fitted floor to ceiling sliding door, mirror fronted wardrobes.

### Bathroom

11' 5" x 4' 10" (3.48m x 1.47m)

With beamed ceiling, inset ceiling down lighters, part tiled walls, chrome heated towel rail incorporating radiator and fitted with a suite comprising, free standing cast iron roll top bath resting on ball and claw feet with free standing chrome mixer tap incorporating hand spray, pedestal wash basin and low flush WC.





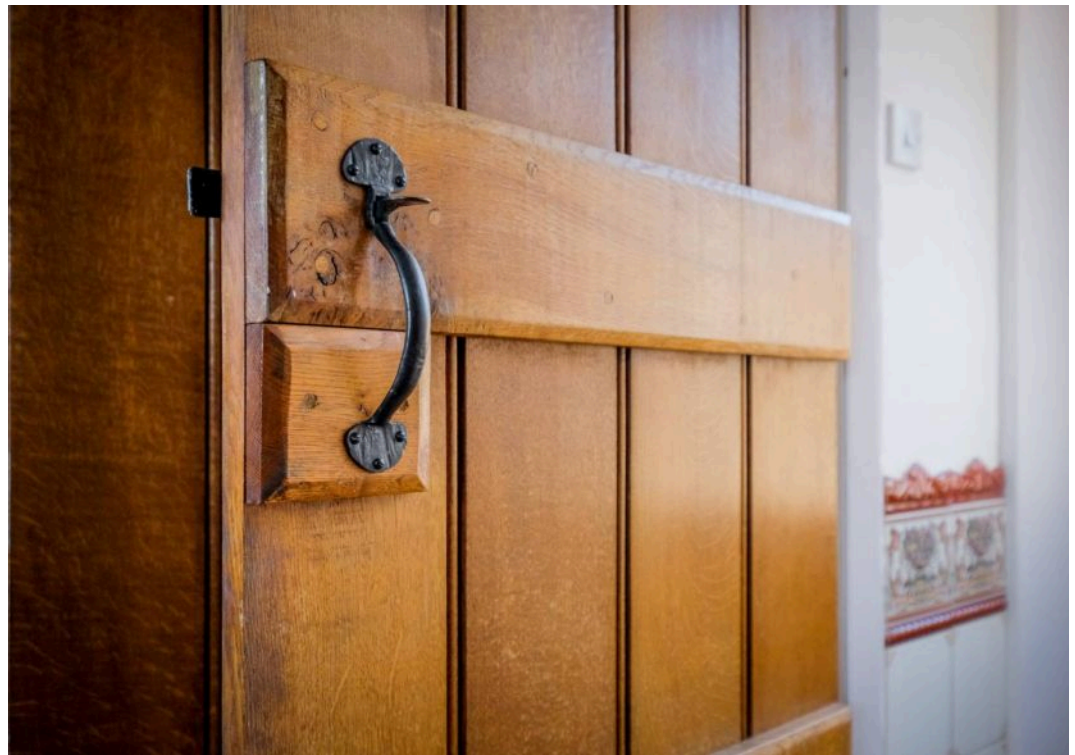



## Garden

To the left hand side of the garage there is a timber hand gate which opens onto a flight of stone steps which rise to a south westerly facing lawned garden together with Indian stone flagged patio, there are planted trees, flowers and shrubs, this area is well screened offering a good degree of privacy, the roof of the garage is also used as an area to sit and from here there are some lovely far reaching views.

## Garage

The property is approached either on foot or by car through a five bar timber gate which goes under the passage way which is shared with the adjoining property. From here there is a timber hand gate or larger gate which opens to provide vehicular access to a stone flagged driveway which provides off road parking for two cars as well as giving access to the garage. Garage is 15'10" x 13'6" with an up and over door, power and light.









**VIEWING** For an appointment to view, please contact the Huddersfield Office on 01484 651878

**BOUNDARY OWNERSHIP** The boundary ownerships and tenure of the property have not been checked on the title deeds for any discrepancies or rights of way if any (This is a standard statement on all our brochures due to the Property Misdescription's Act) **COPYRIGHT** Unauthorised reproduction prohibited.

**FREE VALUATIONS** If you are thinking of a move then take advantage of our FREE valuation service, telephone our nearest office for a prompt and efficient service. **CONSUMER PROTECTION FROM UNFAIR TRADING REGULATIONS 2008** Simon Blyth for themselves and for the vendors or lessors of this property, whose agent they are, have made every effort to ensure the details given have been prepared in accordance with the above act and to the best of our knowledge give a fair and reasonable representation of the property. Please note: 1. There is a six inch measurement tolerance or metric equivalent and the measurements given should not be entirely relied upon and purchasers must make their own measurements if ordering carpets, curtains or other equipment. 2. None of the main services, i.e. gas, water, electricity, drainage or central heating system (if any) have been tested in any way whatsoever. This also includes appliances which are to be left in situ by the vendors.

**PURCHASERS MUST SATISFY THEMSELVES AS TO THE CONDITION AND EFFECTIVENESS OF ANY SUCH APPLIANCES OR SERVICES FLOOR PLANS NOT TO SCALE – FOR IDENTIFICATION PURPOSES ONLY.**

**MAILING LIST** Keep up to date with all our new properties. Let us know your price range, the area and type of home you require by registering on our mailing list. **MORTGAGE ADVICE** Simon Blyth Estate Agents understand that getting appropriate mortgage advice is a crucial part of the home buying process. Finding a suitable mortgage has always been something of a daunting experience which is why we would like to introduce you to our independent mortgage advisors. They provide tailored mortgage solutions through a wealth of experience in the mortgage and property market and offer access to the full unrestricted range of products available. Our advisors are dedicated to providing ongoing guidance and advice throughout the entire house purchase process keeping you, your estate agent and solicitor involved with continual updates on the progress. Once in your new home they will be available for ongoing support to build a long term relationship for your future mortgage planning. Your home may be repossessed if you do not keep up repayments on your mortgage. For friendly expert advice on your mortgage requirements, or to discuss the potential of making your ideas a reality then please call in or phone for a chat. **OFFICE OPENING TIMES 7 DAYS A WEEK**

Monday to Friday – 8:45 am to 5:30 pm Saturday – 9:00 am – 4:00 pm Sunday – 11:00 am – 2:00 pm





## Simon Blyth Estate Agents

Simon Blyth Estate Agents, 26 Lidget Street - HD3 3JP

01484 651878

[huddersfield@simonblyth.co.uk](mailto:huddersfield@simonblyth.co.uk)

[www.simonblyth.co.uk/](http://www.simonblyth.co.uk/)

Wakefield	Huddersfield	Holmfirth	Kirkburton	Penistone	Sheffield	Barnsley	Pontefract	Leeds	Halifax
01924 361631	01484 651878	01484 689689	01484 603399	01226 762400	01143 216 590	01226 731730	01977 800259	0113 4689331	01422 417000