



Local to you - contactable when you need us

 **KMJProperty**
Your local independent Estate Agent

Oakdale Road, Tunbridge Wells

Offers In Region Of £350,000

3 1 1



Located in the very heart of Tunbridge Wells, this charming and characterful split-level apartment offers three double bedrooms and a unique blend of period features and modern enhancements. Well maintained throughout, it provides flexible and stylish living space ideal for a range of buyers.

The exterior of the property sets a welcoming tone, with a quaint front garden and a well-maintained pathway leading to the private entrance.

Upon entering, the lower level hosts two well-proportioned double bedrooms, both flooded with natural light from large windows that enhance the bright and airy feel of the space. These rooms offer versatile accommodation – perfect as bedrooms, guest rooms, or even a home office. The modern bathroom is also located on this level, featuring contemporary tiling and a stunning freestanding bath, creating a luxurious yet practical space.

On the upper level, you will find a truly charming living area, complete with beautiful exposed floorboards and a feature fireplace, adding a rustic yet elegant touch. The room's impressive bay window not only provides a lovely architectural feature but also allows an abundance of natural light to pour in, making the space feel warm and inviting – perfect for relaxing or entertaining.

The kitchen is uniquely designed, offering a quaint and characterful setting with oak-style countertops and sleek, modern cabinets. While compact, it is bright and thoughtfully laid out, with everything needed for functional everyday living.

Completing the accommodation is a further generously sized double bedroom on the upper floor, offering a peaceful and private retreat.

The property also boasts a charming private garden, with steps leading down to a beautifully maintained lawn. Mature shrubbery and secure fencing enclose the space, creating a wonderfully private and peaceful setting – perfect for relaxing, entertaining, or enjoying outdoor dining during the warmer months.

This distinctive home offers the perfect combination of character, charm, and convenience, all just moments away from the vibrant amenities of Tunbridge Wells. Early viewing is highly recommended to appreciate everything this delightful apartment has to offer.



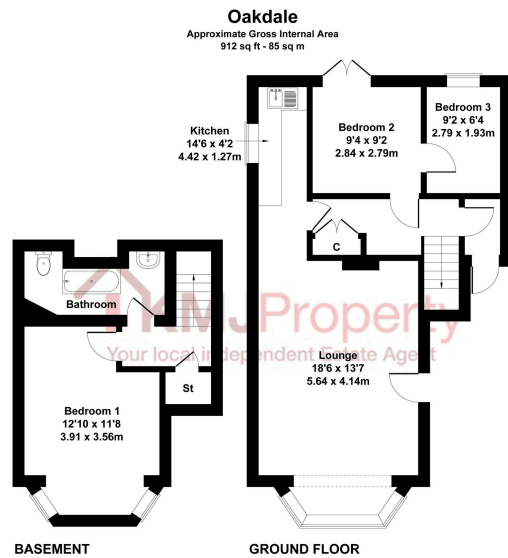

Not to Scale. Produced by The Plan Portal 2025
For Illustrative Purposes Only.

- Split level Apartment
- Charming and Rustic
- Well Maintained Garden
- Modern Bathroom
- EPC: D
- 3 Double Bedrooms
- Unique Kitchen
- Beautiful Bay Window
- Desirable Location
- Council Tax band: C

