



*Local to you - contactable when you need us*

 **KMJProperty**  
Your local independent Estate Agent



## Common View, Tunbridge Wells

Offers In Region Of £375,000

🛏 2 🍳 1 🚿 1





The exterior of this property boasts charm, featuring a neatly enclosed front courtyard garden and a white picket fence.

Upon entering this beautiful home, you are met with a porch area perfect for storing shoes and coats.

Moving through the home, you are welcomed by a spacious, stylish living/dining room with an exposed brick chimney and log burner, adding to the rustic charm of the property—the perfect spot for relaxing or entertaining.

Towards the back of the property, you will find the bright and airy kitchen, offering integrated appliances, sleek worktops, and access to the rear garden.

Moving upstairs, you are met with a landing area leading to the main living spaces. The main bedroom is a spacious double, featuring a charming fireplace and plenty of built-in storage.

The modern family bathroom offers a sleek shower over bath and a contemporary wash basin.

At the back of the property, you will find the second bedroom, a smaller double with a large window overlooking the rear garden. This space is perfect for a child's bedroom or a work-from-home area.

The rear garden is the perfect spot for relaxing, with an extensive lawn and fencing on either side for added privacy.

This charming and stylish home is a perfect opportunity for small families, first-time buyers, or buy-to-let investors alike.

This property also boasts a desirable location. The property is within walking distance (0.1 miles) of Rusthall St Paul's CE Primary School and just 1.5 miles from Tunbridge Wells town centre, which offers excellent shopping, dining, and transport links. The area is also well-connected to Tunbridge Wells Station (1.9 miles), which offers direct links to London, making it ideal for commuters. Rusthall village provides local shops, cafes, and green spaces, offering convenience and a strong sense of community.

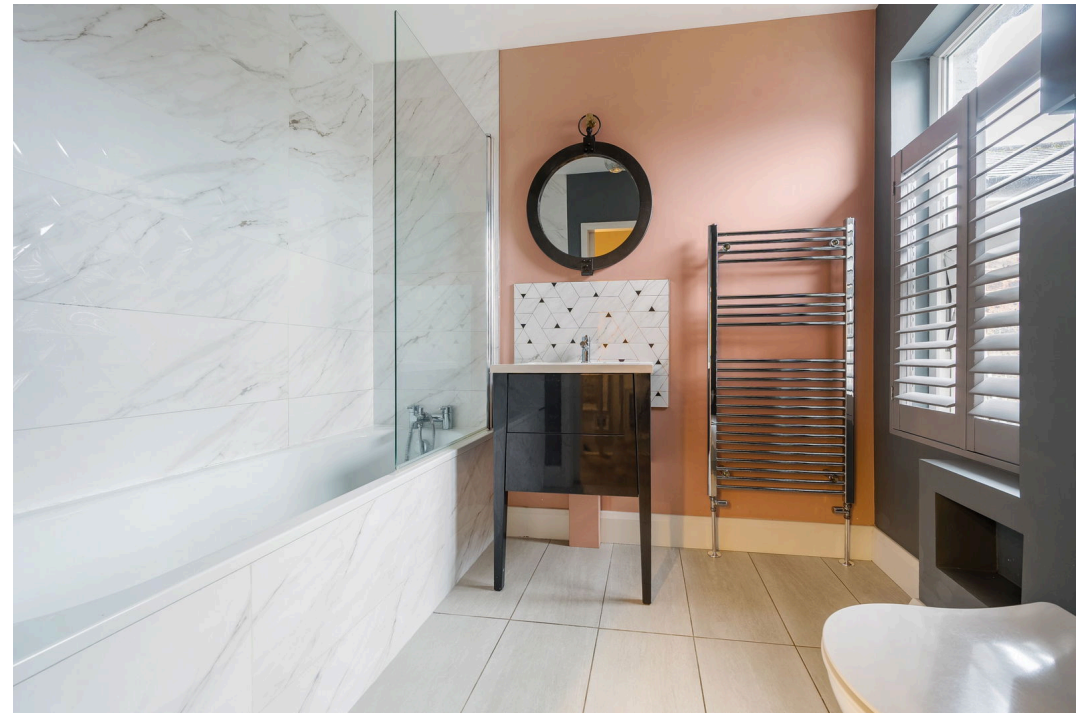



## Common View, Tunbridge Wells, TN4

Approximate Area = 706 sq ft / 65.5 sq m  
For identification only - Not to scale

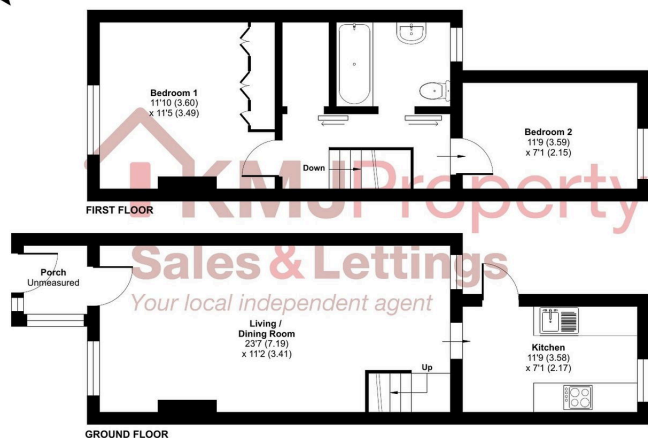

Floor plan produced in accordance with RICS Property Measurement 2nd Edition,  
Incorporating International Property Measurement Standards (IPMS2 Residential). © nrichcom 2025.  
Produced for K&M Property. REF: 1253626

- 2 Bedrooms
- Kitchen with Integrated Appliances
- Open Plan Living/Dining Area
- Rustic Charm
- EPC: C
- Mid Terrace
- Modern Family Bathroom
- Beautifully Presented
- Rear Fenced Garden
- Council Tax Band: C

