



Shirley Grove, Rusthall, Tunbridge Wells



 **KMJProperty**
Your local independent Estate Agent

- Garage
- Front and Rear Garden
- 4 Bedrooms
- Council Tax Band B
- Garden Room
- 3 Floors

This beautiful 4 bedroom, terrace property set over 3 floor is a perfect family home, providing all the outdoor and indoor space needed with outstanding interior.

Approaching the property you are presented with a good sized front garden and a paved walkway. Upon entering the property you are welcomed with a long entrance hallway accompanied with a downstairs WC and several storage cupboards, providing ample space for all of your belongings.

Towards the end of the hallway to the left is the kitchen/dining area. The kitchen displays a large open space with natural light, as well as many wall and base cupboards. The kitchen/dining area boasts the perfect space for entertaining and cooking your favourite meals whilst having the company of your guests.

Following from the kitchen to the lounge the area is flooded with natural light provided by the double doors leading you out to the garden room/second dining area. The lounge boasts the perfect family room with a feature fireplace and a statement TV wall, with plenty of room for games nights.

The versatile garden room provides all the extra space needed. This area allows the buyers freedom to use their imagination to turn this space into whatever their heart desires. The patio doors in this room lead out to the large rear garden which offers both grass and paved areas.

The first floor accommodates the family bathroom and bedrooms 1, 3, and 4, 2 of which are double bedrooms. The bathroom is equipped with a separate bath and shower as well as heated towel rail. It offers plenty of storage space and is the perfect environment to wind down after a long day.

All bedrooms have large windows, also with majority of the bedrooms benefitting from built in storage/ wardrobe space.

Heading back onto the landing and up to the second floor is the last bedroom with 2 large windows. An ideal private space away from all the noise of the family.

MORE PROPERTIES REQUIRED IN ALL AREAS





Notes

Leave KMJ Property Office Rusthall. Turn Right onto High St, take a left turn onto Lower Green Road. Turn Right onto Shirley Gardens, turn right again. Turn Right onto Shirley Grove, turn right again, turn Left and the destination is on the left.

Council Tax D
Tenure: Freehold

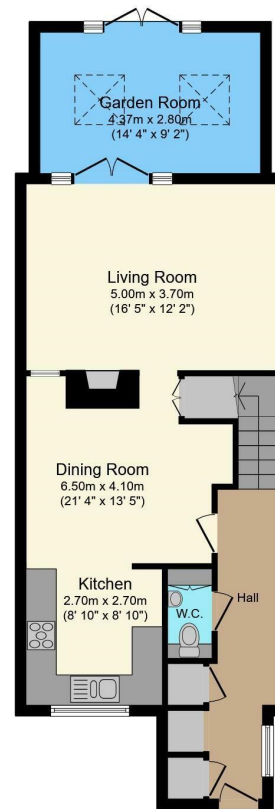

Ground Floor

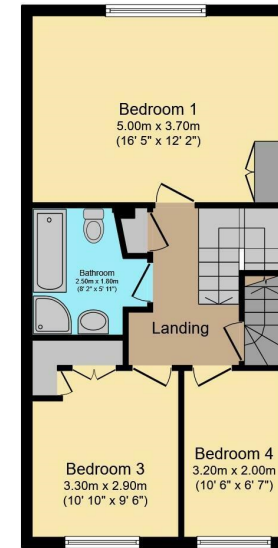

First Floor

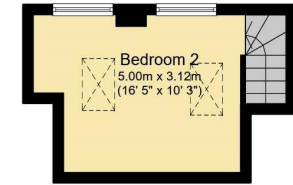

Second Floor

Total floor area 133.2 sq.m. (1,434 sq.ft.) approx

	Current	Potential
Very energy efficient - lower running costs		
(92-100) A		
(81-91) B		
(69-80) C		
(55-68) D	66	77
(39-54) E		
(21-38) F		
(1-20) G		
Not energy efficient - higher running costs		

AGENT NOTE: KMJ Property, their clients and any joint agents give notice that: They have no authority to make or give any representations or warranties in relation to the property. Any statements on which a purchaser wishes to rely must be checked through their Solicitors or Conveyancers. These Particulars do not form part of any offer or contract and must be independently verified. The text, photographs and floor plans are for guidance only and are not necessarily comprehensive, please also note that not everything in the photographs may be included in the sale. It should not be assumed that the property has necessary planning, Building Regulations or other consents. We have not tested any appliances, services, facilities or equipment and Purchasers must satisfy themselves as to their adequacy and condition. We have not investigated the Title, or the existence of any Covenants or other legal matters which may affect the property.

BRITISH
PROPERTY
AWARDS
2023
★★★★★
GOLD WINNER
ESTATE AGENT
IN CROWBOROUGH

01892 515188

01342 824824

01342 833333



FEDERATION
OF INDEPENDENT
AGENTS

Tunbridge Wells

Crowborough

Forest Row

BRITISH
PROPERTY
AWARDS
2022
★★★★★
GOLD WINNER
ESTATE AGENT
IN TUNBRIDGE
WELLS