



23 The Meads, Green Lane, Windsor, SL4 3TP
£124,995 Leasehold

CHAIN FREE A well presented one bedroom first floor retirement flat with secure entrance, warden's office and lift. There is a resident's laundry room, guest suite, communal lounge and ample parking. The property is ideally located within walking distance of local shops and Windsor town centre..

Entrance Lobby

Secure entrance lobby leading to inner hall with warden's office, entrance to resident's communal lounge, lift and stairs to first floor apartment

Entrance Hall

Walk in utility cupboard, hot and cold water tanks, electric meter

Sitting Room

Two wall lights, storage heater, window with views to front of property, double doors to

Kitchen

Fitted units incorporating inset sink, floor and wall cupboards and drawers, four ring electric hob with extractor over, built in oven, space for dishwasher, tiled splashbacks, window with view to front of property

Double Bedroom

fitted floor to ceiling wardrobes and recessed space between for double bed, storage heater, window with views to front of property

Bathroom

Close coupled WC, wash hand basin with cupboard below, panelled bath with mixer taps and shower unit above, fully tiled walls, mirror with light above, extractor fan, warm air heater

Outside

Well kept communal gardens. Ample parking spaces

Floor Plan

Approximate Floor Area = 44.2 sq m / 475 sq ft

The Meadows

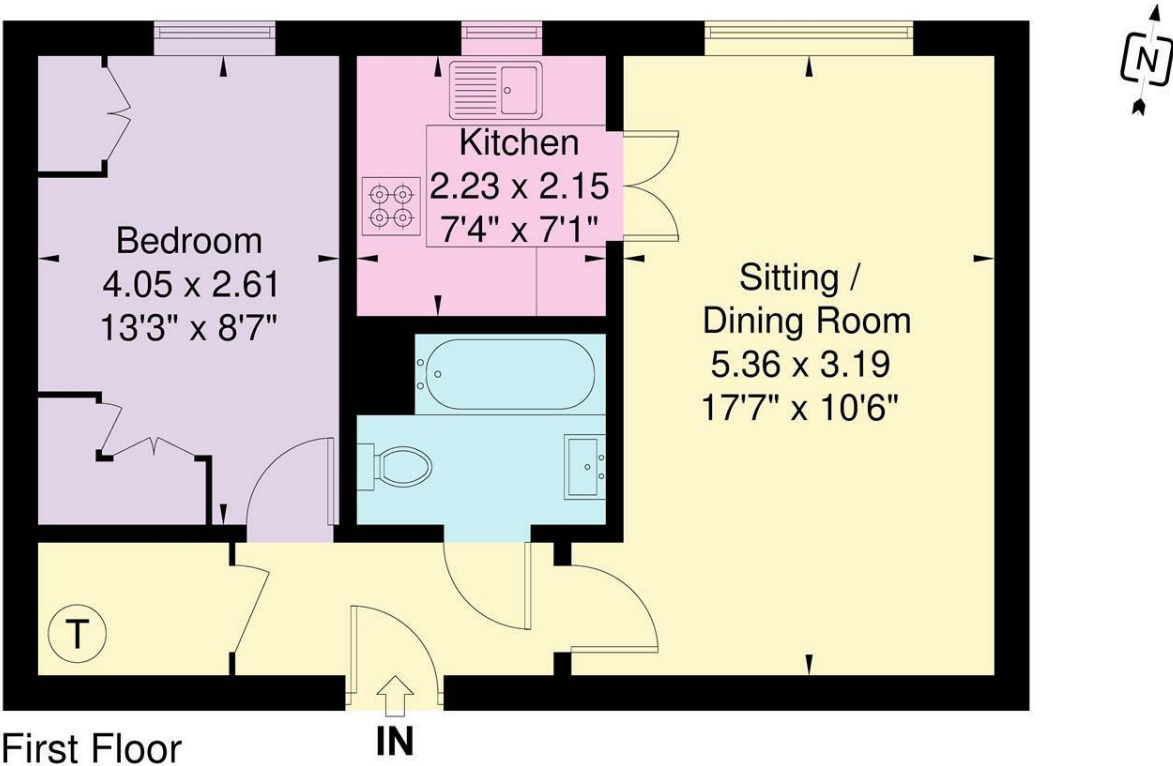
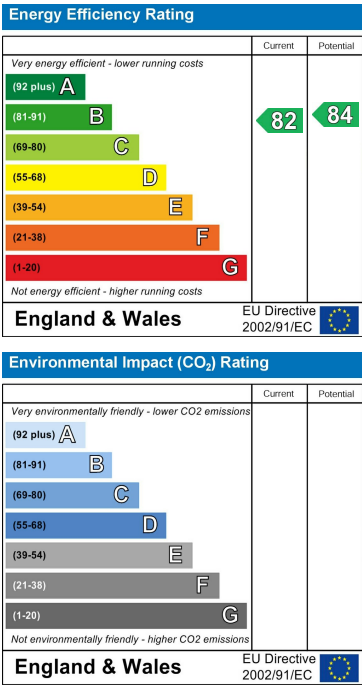

Illustration for identification purposes only, measurements are approximate, not to scale.

Area Map



Energy Efficiency Graph



These particulars, whilst believed to be accurate are set out as a general outline only for guidance and do not constitute any part of an offer or contract. Intending purchasers should not rely on them as statements of representation of fact, but must satisfy themselves by inspection or otherwise as to their accuracy. No person in this firm's employment has the authority to make or give any representation or warranty in respect of the property.