



**Flat 5 Ye Meads House, Maidenhead, SL6 0DH**  
**£345,000 Share of Freehold**

A spacious well presented 2 double bedroom ground floor apartment close to the Jubilee River and in a conveniently located semi rural location. The property has a part share of the freehold , long lease and allocated parking. Taplow Elizabeth line station is within walking distance and local shops and a large supermarket are a short distance away. CHAIN FREE

**Communal Entrance Hall**

Carpeted, staircase leading to upper floor, understairs storage cupboard

**Spacious Entrance Hall**

Spacious hallway, entryphone system

**Double Bedroom**

Built in floor to ceiling double wardrobe cupboards

**Bathroom**

White suite with close coupled WC, pedestal wash basin, mirrored cabinet, bath with shower over, glazed screen, tiled walls, storage cupboard

**Kitchen**

Wall and floor cupboards, tiled splashbacks, ceramic hob, built in oven, pull out kitchen tap, space for washing machine and fridge freezer, window shutters

**Sitting/dining room**

Double aspect with window shutters, looking out to garden, overlooking fields, space for dining table

**Double bedroom**

Two double floor to ceiling wardrobe cupboards,

**Porch**

Leading to private garden with front access

**Outside**

Private enclosed garden, patio area, allocated parking space

Floor Plan

**Ye Mead**  
Approximate Gross Internal Area 77.46 sq m / 833.77 sq ft

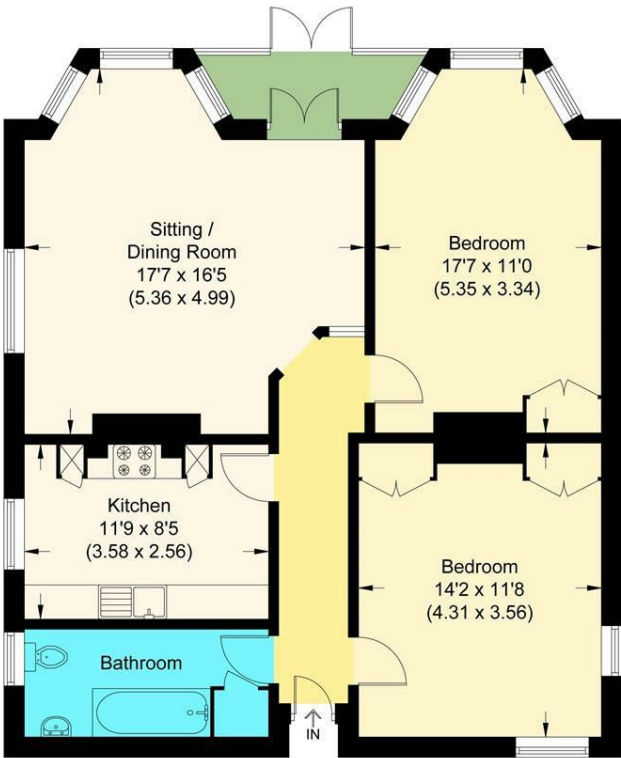

Ground Floor  
Illustration for identification purposes only,  
measurements are approximate, not to scale.

Area Map

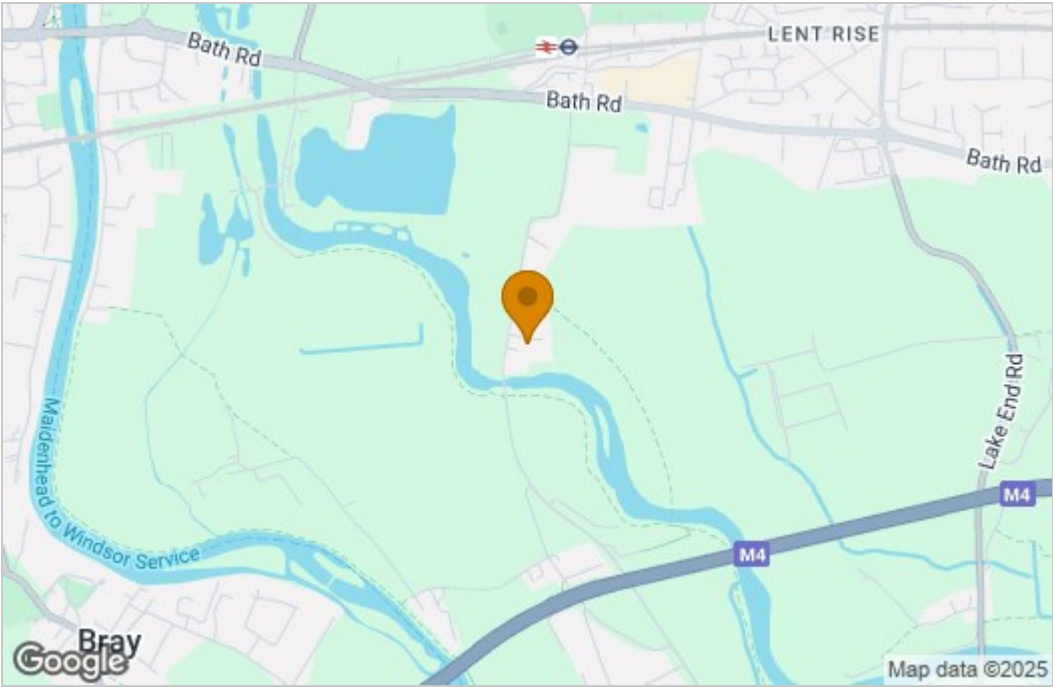

Energy Efficiency Graph

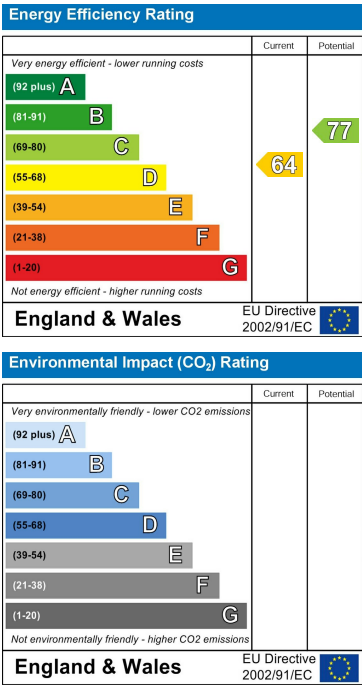

These particulars, whilst believed to be accurate are set out as a general outline only for guidance and do not constitute any part of an offer or contract. Intending purchasers should not rely on them as statements of representation of fact, but must satisfy themselves by inspection or otherwise as to their accuracy. No person in this firm's employment has the authority to make or give any representation or warranty in respect of the property.