

# JAMES SELICKS

44 ELMFIELD AVENUE

STONEYGATE, LEICESTER LE2 1RD

GUIDE PRICE: £200,000





Offered to the market with no upward chain, a two bedroom, first floor apartment, now in need of modernisation and updating, located in the heart of the suburb of Stoneygate, just a stone's throw away from Victoria Park.

Ground floor hallway • first floor hallway • two cloakrooms • sitting/dining room • kitchen • two bedrooms • bathroom • allocated parking • single garage • communal gardens • NO CHAIN • EPC - C

#### Location

Elmfield Avenue is located approximately one and a half miles south of the city centre with its professional quarters and mainline railway station, with day-to-day shopping found along the nearby Allandale Road and Francis Street shopping parades and neighbouring Queens Road in Clarendon Park.

#### Accommodation

This charming property offers a thoughtfully arranged layout, entered via a solid wood front door into an entrance hall with windows and the stairs to the first floor hallway housing several storage cupboards, the Worcester wall mounted boiler and a cloakroom with two piece suite.

The sitting/dining room is well-proportioned, with a bay window overlooking the communal gardens and a handy serving hatch into the adjacent kitchen, a bright and functional space with a side-facing window providing a basic range of cupboards, drawers and worktops, a stainless steel sink and drainer unit, plumbing and space for a gas oven. A secondary hallway leads to a separate WC with two piece suite and an obscure glazed window.

The master bedroom has a large bay window overlooking the communal gardens. The second bedroom is also a generous double, with a side-facing window and a built-in sliding wardrobe. A small, centrally located hallway connects the two bedrooms, houses the airing cupboard and leads to the main bathroom which is partially tiled, with a bath with shower, wash basin, and an obscure glazed window.

#### Outside

The property enjoys immaculately kept, pretty communal gardens, a single garage in a block with up and over door and further allocated parking.

**Tenure :** Freehold

**Local Authority:** Leicester City Centre

**Tax Band:** B

**Listed Status:** None. **Conservation Area:** Stoneygate.

**Services:** Offered to the market with all mains services and electric heating.

**Broadband delivered to the property:** Unknown.

**Wayleaves/Rights of Way/Covenants:** None out of the ordinary for an apartment block.

**Accessibility:** The apartment is on an upper floor, there is NO lift.

**Planning issues:** None our Clients are aware of.









Leicester Office  
56 Granby Street  
Leicester  
LE1 1DH  
0116 2854554  
info@jamesselicks.com

Market Harborough Office  
01858 410008

Oakham Office  
01572 724437

jamesselicks.com



**Important Notice**  
James Sellicks for themselves and for the Vendors whose agent they are, give notice that:

1) The particulars are intended to give a fair and substantially correct overall description for the guidance of intending purchasers and do not constitute part of, an offer or contract. Prospective purchaser(s) and lessees ought to seek their own professional advice.

2) All descriptions, dimensions, areas, reference to condition and if necessary permissions for use and occupation and their details are given in good faith and believed to be correct. Any intending purchaser(s) should not rely on them as statements or representations of fact but must satisfy themselves by inspection or otherwise as to the correctness of each of them.

3) No person in the employment of James Sellicks has any authority to make or give any representation or warrant, whether in relation to this property or these particulars, nor to enter into any contract relating to the property on behalf of the Vendors.

4) No responsibility can be accepted for any expenses incurred by any intending purchaser(s) in inspecting properties that have been sold, let or withdrawn.

#### Measures and Other Information

All measurements are approximate. Whilst we endeavour to make our sales particulars accurate and reliable, if there is any point which is of particular importance to you, please contact this office and we will be pleased to check the information for you, particularly if contemplating travelling some distance to view the property.

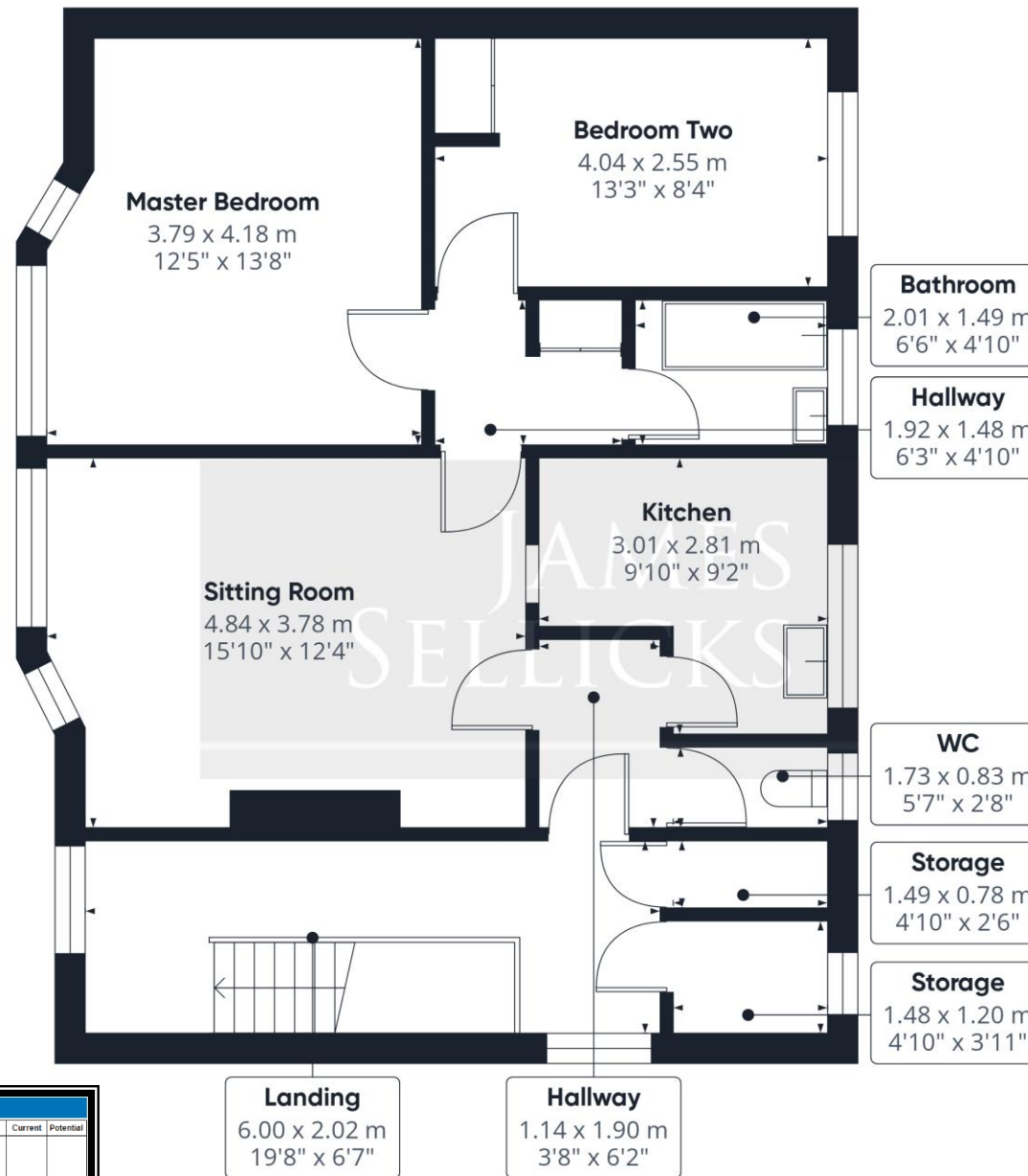
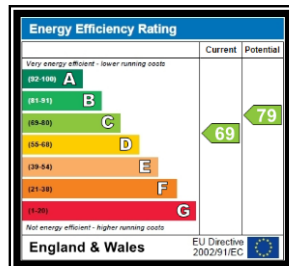

Floor 2

JAMES  
SELICKS

Approximate total area<sup>(1)</sup>

76.1 m<sup>2</sup>  
818 ft<sup>2</sup>

(1) Excluding balconies and terraces

While every attempt has been made to ensure accuracy, all measurements are approximate, not to scale. This floor plan is for illustrative purposes only.

Calculations were based on RICS IPMS 3C standard. Please note that calculations were adjusted by a third party and therefore may not comply with RICS IPMS 3C.

GIRAFFE360