



2 Springvale Cottages Main Road, Chillerton
£265,000



Megan Baker
Estate Agents

2 Springvale Cottages Main Road, Chillerton

£265,000

This pretty 18th century stone cottage is idyllically positioned in the popular village of Chillerton and is full of character. A stable door opens into the charming lounge with its flagstone floor and inglenook fireplace with woodburning stove. This leads in turn to a chic galley kitchen which features glossy cream units and bamboo worktops. A large conservatory to the rear offers a valuable extra reception area - ideal as a separate dining room. The galleried landing leads to two bedrooms, one being a pleasant double room with a window to the front. The smaller bedroom could be used as a study area and links through to the family bathroom. The loft has been creatively converted to provide a great master bedroom. Two large velux windows look to the rear, framing pleasant downland views. The room also has the benefit of a wet room style shower room. The cottage has a level, enclosed garden to the front. To the rear, a pleasant lawned and terraced garden steps up to back onto open fields. The area is planted with a variety of mature shrubs and trees and has a large timber workshop. as well as a stunning elevated downland view. FREEHOLD. COUNCIL TAX BAND A. EPC - F-36.

Half-glazed stable door to...

Sitting Room:

16'0" max x 13'5" max (4.88m max x 4.11m max)

An appealing area which oozes charm and character with its beautiful worn flagstone floor. The focal point of the room is a fabulous inglenook fireplace with natural brick features including a former bread oven. A wood burning stove is set on the raised stone hearth with a rustic wood mantle over. There

is a window to the front with a pretty window seat and stairs lead off to the first floor. Pretty painted stone wall; wall mounted electric heater and dresser unit set in the chimney recess. Pine plank door to...

Kitchen:

15'10" max x 5'9" max (4.85m max x 1.76m max)

The mellow flagstone floor runs through into this area which is fitted with a range of glossy cream units and bamboo worktops. Inset circular stainless





steel sink unit; gas hob; electric oven and spaces for a fridge freezer and washing machine. The room again features beautifully rustic painted stone walls and has a window with opening through to the...

Dining Room:

12'7" max x 8'8" max (3.86m max x 2.65m max)

A very useful addition to the house in the conservatory style, with solid walls and UPVC double glazed windows and french doors looking and leading into the garden. Wall mounted electric heater.

First Floor Landing:

Door leading to stairs the second floor with understairs cupboard and front facing window. Further doors to...



Bedroom Two:

14'4" max x 10'1" (4.38m max x 3.08m)

A pleasant twin, or smaller double bedroom with a window to the front and window seat under. Attractive and useful chimney recesses; built-in shelving and wall mounted electric heater.

Study/Bedroom 3:

10'9" x 6'3" (3.29m x 1.91m)

A pretty room suitable for multitude of uses including as a dressing room, study or single bedroom. Rear-facing window looking over the garden and fields beyond. Wall mounted electric heater and door to...



Bathroom:

6'2" max x 5'5" max (1.90m max x 1.67m max)

A compact, pretty bathroom with a small rear-facing window. Panelled bath with electric shower over; small wash hand basin set cupboard and WC.

Second Floor:

Bedroom One:

12'2" max x 11'10" +stairs (3.73m max x 3.63m +stairs)

The loft has been converted to create an appealing, L-shaped main bedroom with good height, part sloping ceilings. Two rear-facing double glazed Velux windows give a great view over the open fields behind the garden. Access to under-eaves storage and attractive exposed brick and stone chimney breast. Door to...

En-suite Shower Room:

5'4" max x 4'2" max (1.63m max x 1.28m max)

A wet room style area creating a useful second bathroom facility with underfloor heating. Fully tiled walls with shower, small wash hand basin and WC.

Garden:

The cottage has has gated access into an enclosed front garden with path to the front door. To the rear, the garden is accessed from the dining conservatory with a decked area. Steps lead up to a mainly lawn garden which is planted with a variety of mature shrubs. There is a useful garden shed and the whole area backs onto open fields enjoying some lovely views.

Disclaimer

These particulars are issued in good faith, but do not constitute representation of fact or form any part of any offer or contract. The Agents have not tested any apparatus, equipment, fittings or services and room measurements are given for guidance purposes only. Where maximum measurements are shown, these may include stairs and measurements into shower enclosures; cupboards; recesses and bay windows etc. Any video tour has contents believed to be accurate at the time it was made but there may have been changes since. We will always recommend a physical viewing wherever possible before a commitment to purchase is made.

Arrange a viewing: Call us on 01983 280555 or email: hello@meganbakerestateagents.com

Arrange a viewing
Love this property and want to see more?
Call us on **01983 280555**
Email: hello@meganbakerestateagents.com

Pop in for a chat
Megan Baker Estate Agents
128 High Street Cowes Isle of Wight PO31 7AY
meganbakerestateagents.com

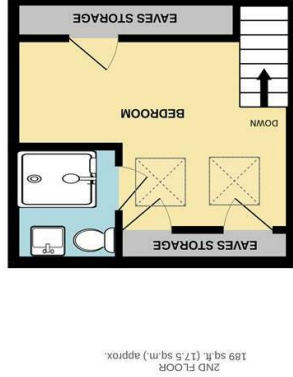

Whilst every attempt has been made to ensure the accuracy of the layout, the measurements of doors, windows, rooms and any other items are approximate and no responsibility is taken for any error, omission or mis-statement. This plan is for illustrative purposes only and should be used as such by any prospective purchaser. The services, systems and appliances shown have not been tested and no guarantee as to their operability or efficiency can be given.
Made with Metropix ©2025

