



London Road, Liss

**Offers Over £150,000**



**Williams of Petersfield**

INDEPENDENT ESTATE AGENTS



# London Road, Liss

\*No Onward Chain\*

Discover this charming one-bedroom ground-floor apartment nestled in the heart of Rake, a peaceful village perfect for nature lovers and those seeking a serene lifestyle. Surrounded by countryside walks, a quaint village pub and easy access to Petersfield and the A3.

The open plan kitchen / living room enjoys a log burner and large windows with peaceful views. It is split with a vanity board / shelf unit in order to separate kitchen from living space.

The double bedroom has the benefit of built in wardrobes. The bathroom and utility are practical with the utility offering plumbing for your washing machine, the bathroom includes a shower.

There are two allocated spaces to the rear of the property as well as wonderful communal gardens.

Council Tax- A

EPC- D

44 years remaining on lease - Lease being extended

Service charge - £1560 annually





Location - Rake

The property is located in the Village of Rake which is situated on the Hampshire/West Sussex border in the South Downs National Park and a short drive from the market town of Petersfield. Rake has a public house, a highly regarded primary school, village hall with a childrens play area and tennis court. There is also a popular garden centre with tea rooms and post office. There are school buses provided for secondary education at Midhurst, Liphook and Petersfield. Alternatively, Churchers College, Bedales and Highfield and Brookham schools are within easy reach. The larger village of Liss, which provides more comprehensive facilities, is approximately 1.5 miles away with the Town of Petersfield approximately 4.6 miles away.

Local authority - Chichester

Chichester District Council  
East Pallant House, 1 East Pallant  
Chichester  
West Sussex  
PO19 1TY  
01243 785166

Additional Information

Electric Storage Heaters  
Private Drainage

Tenure

Leasehold

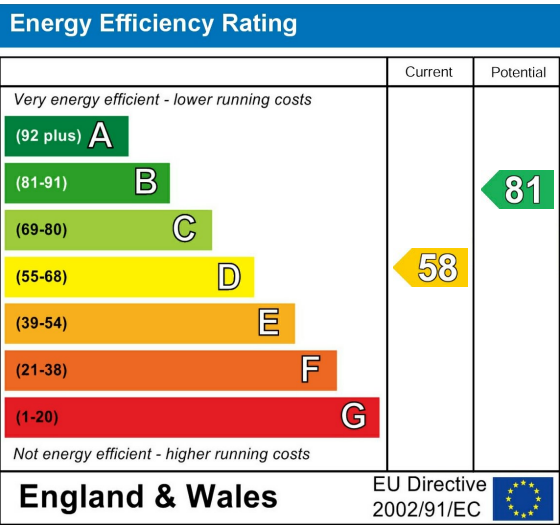

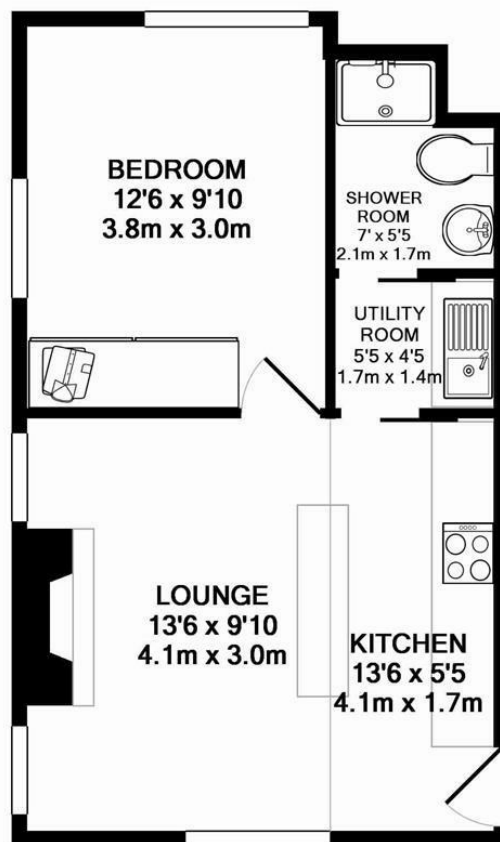

TOTAL APPROX. FLOOR AREA 387 SQ.FT. (35.9 SQ.M.)

Whilst every attempt has been made to ensure the accuracy of the floor plan contained here, measurements of doors, windows, rooms and any other items are approximate and no responsibility is taken for any error, omission, or mis-statement. This plan is for illustrative purposes only and should be used as such by any prospective purchaser. The services, systems and appliances shown have not been tested and no guarantee as to their operability or efficiency can be given

Made with Metropix ©2012

## Williams of Petersfield

6 - 8 College Street, Petersfield, Hampshire, GU31 4AD

01730 233333 [sales@williamsopfetersfield.co.uk](mailto:sales@williamsopfetersfield.co.uk) [www.williamsopfetersfield.co.uk](http://www.williamsopfetersfield.co.uk)

The Property Misdescriptions Act 1991: The Agent has not tested any apparatus, equipment, fixtures and fittings or services and so cannot verify that they are in working order or fit for the purpose. A buyer is advised to obtain verification from their solicitor or surveyor. References to the tenure of a property are based upon information supplied by the seller. The agent has not had site of the title documents. A buyer is advised to obtain verification from their solicitor. Items shown in photographs are NOT included unless specifically mentioned within the sales particulars. They may however be available by separate negotiation. Buyers must check the availability of any property and make an appointment to view before embarking on any journey to see a property.