



10 Chandlers Close | Buckshaw Village | Chorley | PR7 7DY

*** CALLING FIRST TIME BUYERS OR LANDLORD INVESTORS ***

This impressive two-bedroom modern property has been thoughtfully designed to provide well proportioned living spaces throughout. Comprising a fitted kitchen, spacious lounge, two excellent bedrooms and a three piece bathroom suite. Outside there is an allocated parking space making it an ideal home for modern living.

Offers Over £125,000

- Two Bedroom Modern Style House
- Popular Residential Location
- Spacious Lounge
- Fitted Breakfast Kitchen
- Two Double Bedrooms



GROUND FLOOR
355 sq.ft. (33.0 sq.m.) approx.

1ST FLOOR
349 sq.ft. (32.4 sq.m.) approx.

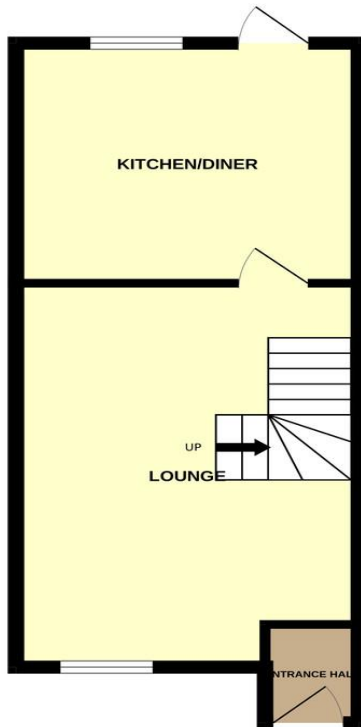

TOTAL FLOOR AREA : 704 sq.ft. (65.4 sq.m.) approx.

Whilst every attempt has been made to ensure the accuracy of the floorplan contained here, measurements of doors, windows, rooms and any other items are approximate and no responsibility is taken for any error, omission or mis-statement. This plan is for illustrative purposes only and should be used as such by any prospective purchaser. The services, systems and appliances shown have not been tested and no guarantee as to their operability or efficiency can be given.

Made with Metropix ©2025

Contact Details

Redrose
15 Barnes Wallis Way
Budshaw Village
Chorley
Lancs
PR7 7JA

www.redrosepm.co.uk
sales@redrose.co.uk
01772 456558

Score	Energy rating	Current	Potential
92+	A		
81-91	B		81 B
69-80	C	76 C	
55-68	D		
39-54	E		
21-38	F		
1-20	G		

Agents Note: Whilst every care has been taken to prepare these sales particulars, they are for guidance purposes only. All measurements are approximate and are for general guidance purposes only and whilst every care has been taken to ensure their accuracy, they should not be relied upon and potential buyers are advised to recheck the measurements