



Porchester Road, W2

£725,000

A two double bedroom, two bathroom lateral apartment in a purpose built building, with a lift and porter. Beautifully presented throughout, with a separate high specification kitchen and reception room with space to dine.

Peters Court is ideally located, offering excellent transport links including Paddington Station, which provides swift access across and beyond London as well as direct connections to Heathrow. The green spaces of Hyde Park, a large Waitrose and a wide selection of local shops, cafés and restaurants are all close by.

Features

- Two Double Bedrooms
- Two Bathrooms
- Long Lease
- Separate Kitchen
- Lift
- Porter
- Bayswater

Porchester Road,
London, W2

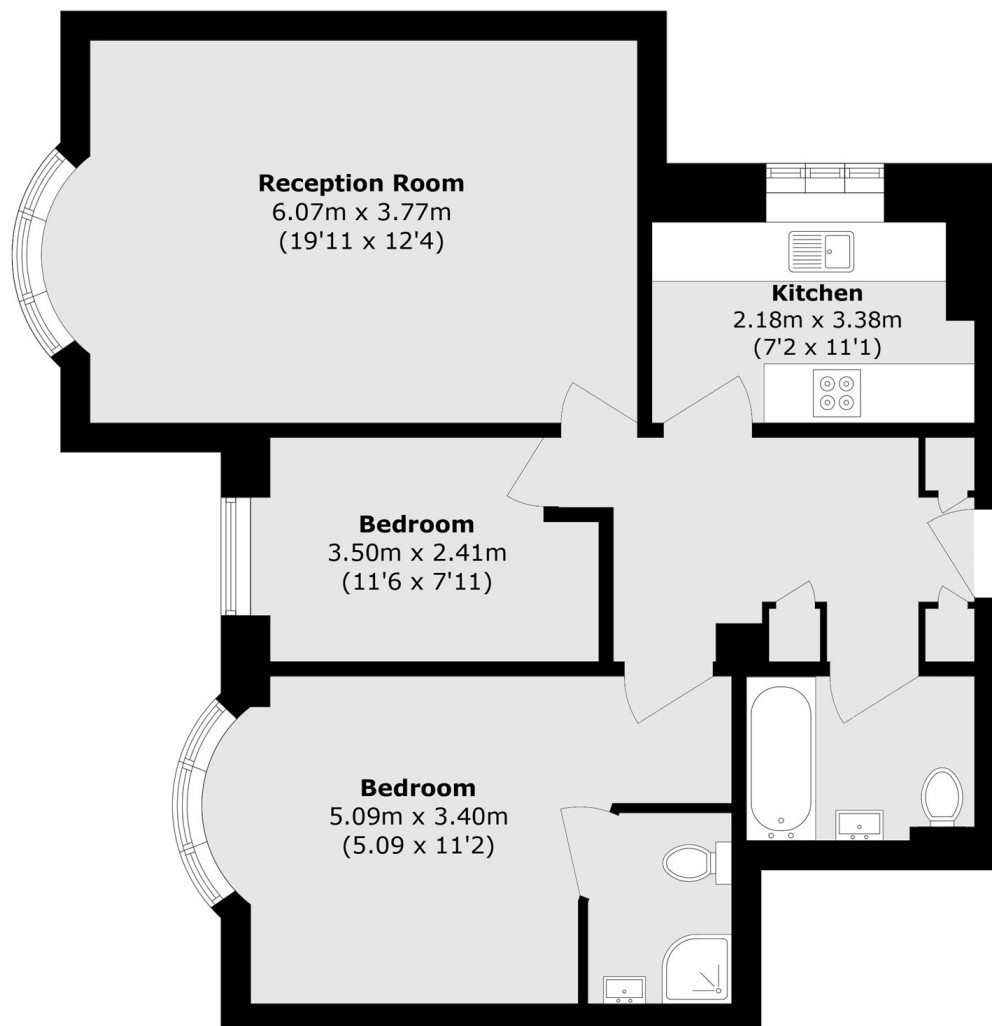

Total area (approx.): 69.8 sq. m (751.3 sq. ft)

Dexters

Westbourne Grove
120 Westbourne Grove
London
W11 2RR
Sales
020 7313 3600

Energy Rating: C. We aim to make our particulars both accurate and reliable. However they are not guaranteed; nor do they form part of an offer or contract. If you require clarification on any points then please contact us, especially if you're traveling some distance to view. Please note that appliances and heating systems have not been tested and therefore no warranties can be given as to their good working order.

 **RICS** | Regulated
Estate Agent
and Letting Agent

[dexters.co.uk](https://www.dexters.co.uk)