



Artesian Road, W2

£595,000

A south facing first floor one bedroom flat with high ceilings and large windows in a fabulous location. The flat is well presented with an open-plan reception room and kitchen plus a double bedroom and shower room.

Artesian Road runs parallel to Westbourne Grove with its first class amenities. Travel links include Royal Oak and Notting Hill Gate underground stations.

Features

High Ceilings
Large Windows
Wooden Floors
South Facing
Great Location

Artesian Road, London, W2

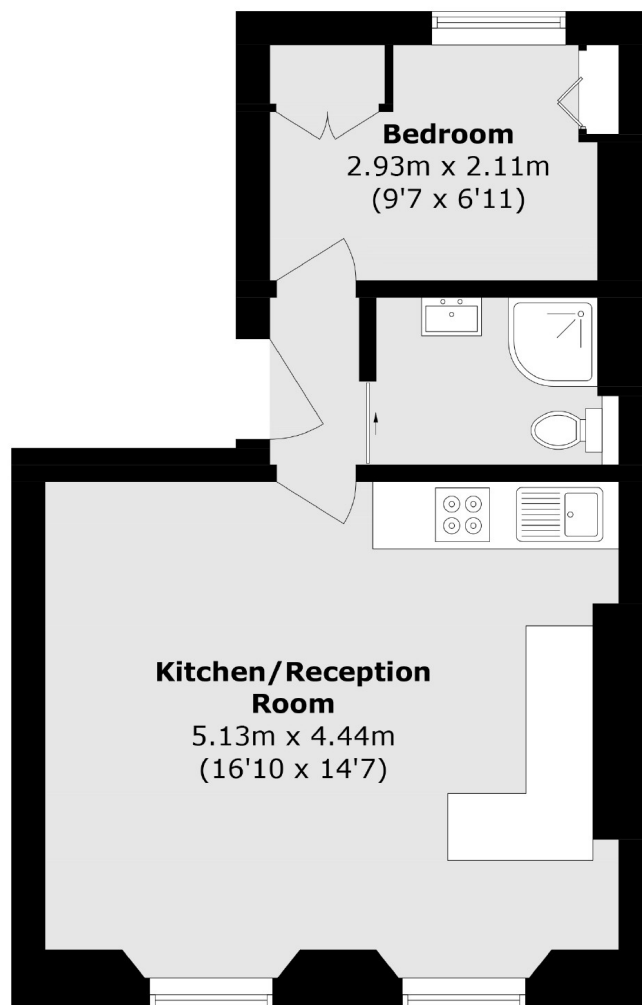

Total area (approx.): 34.9 sq. m (375.6 sq. ft)