



St. Quintin Avenue, W10

£650,000

A spacious and well proportioned two bedroom apartment in a Victorian Conversion. The flat has a semi open plan kitchen/reception room with room to dine and wooden floors. The property benefits from amazing views and lots of natural light throughout. The underlying lease will be extended and paid for by the seller as part of the sale.

St. Quintin Avenue is a popular residential location, close to Ladbroke Grove, Notting Hill and Holland Park, with convenient transport links across London and close to Kensington Memorial Park.

Features

- Share Of Freehold
- Two Bedrooms
- Residential Street
- Close To Amenities
- Top Floor
- Victorian Conversion

St. Quintin Avenue,
London, W10

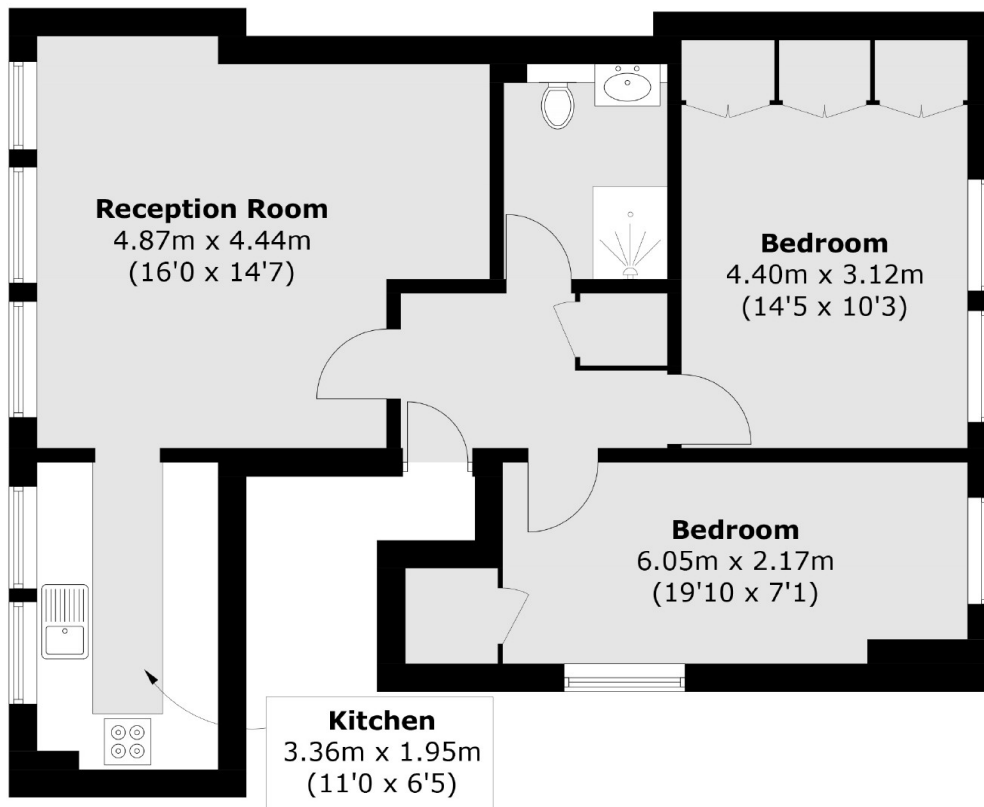

Total area (approx.): 62.4 sq. m (671.7 sq. ft)

Dexters

Westbourne Grove
120 Westbourne Grove
London
W11 2RR
Sales
020 7313 3600

Energy Rating: D. We aim to make our particulars both accurate and reliable. However they are not guaranteed; nor do they form part of an offer or contract. If you require clarification on any points then please contact us, especially if you're traveling some distance to view. Please note that appliances and heating systems have not been tested and therefore no warranties can be given as to their good working order.

 **RICS** | Regulated
Estate Agent
and Letting Agent

[dexters.co.uk](https://www.dexters.co.uk)