



## Holland Park, W11

£1,150,000

A stylish two double bedroom apartment in a white stucco fronted villa, with recently refurbished communal areas. There's a dual aspect, open plan reception room ideal for entertaining and the kitchen and bathroom are both high specification.

Holland Park is a prestigious location, with an immaculate green space on the doorstep and plenty of local boutiques, restaurants and transport links to choose from

### Features

- Two Double Bedrooms
- Dual Aspect
- Open Plan
- Prestigious Location
- White Stucco Fronted
- Holland Park

# Holland Park, London, W11

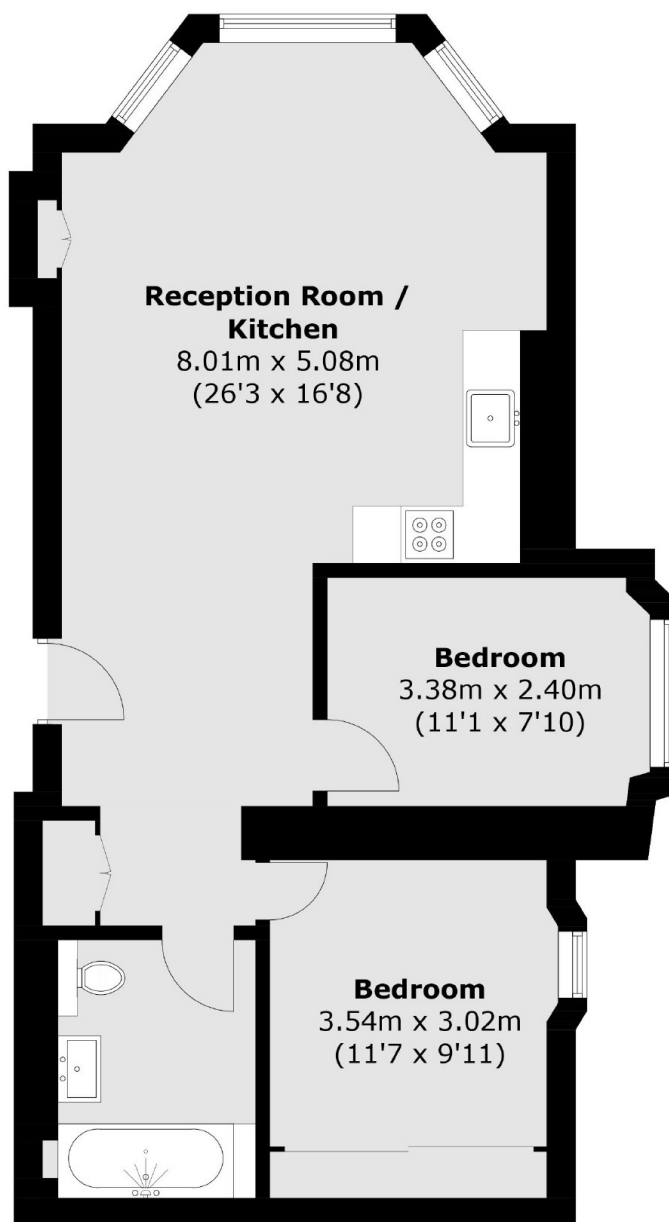

## Lower Ground Floor

Total area (approx.): 62.2 sq. m (669.5 sq. ft)