



## Ladbroke Grove, W11

### £320,000

A well proportioned studio apartment located in an attractive Victorian building on Ladbrooke Grove, W11. The property benefits from high ceilings throughout and is offered with a long lease.

Ladbroke Grove provides close proximity to Ladbroke Grove station as well as immediate access to an abundance of bars, cafés, restaurants and trendy shops in the surrounding area including Kensington Park Road and Portobello Road.

### Features

Studio  
Notting Hill  
Wooden Flooring  
Ladbroke Grove  
Close To Amenities  
Long Lease

# Ladbroke Grove, London, W11

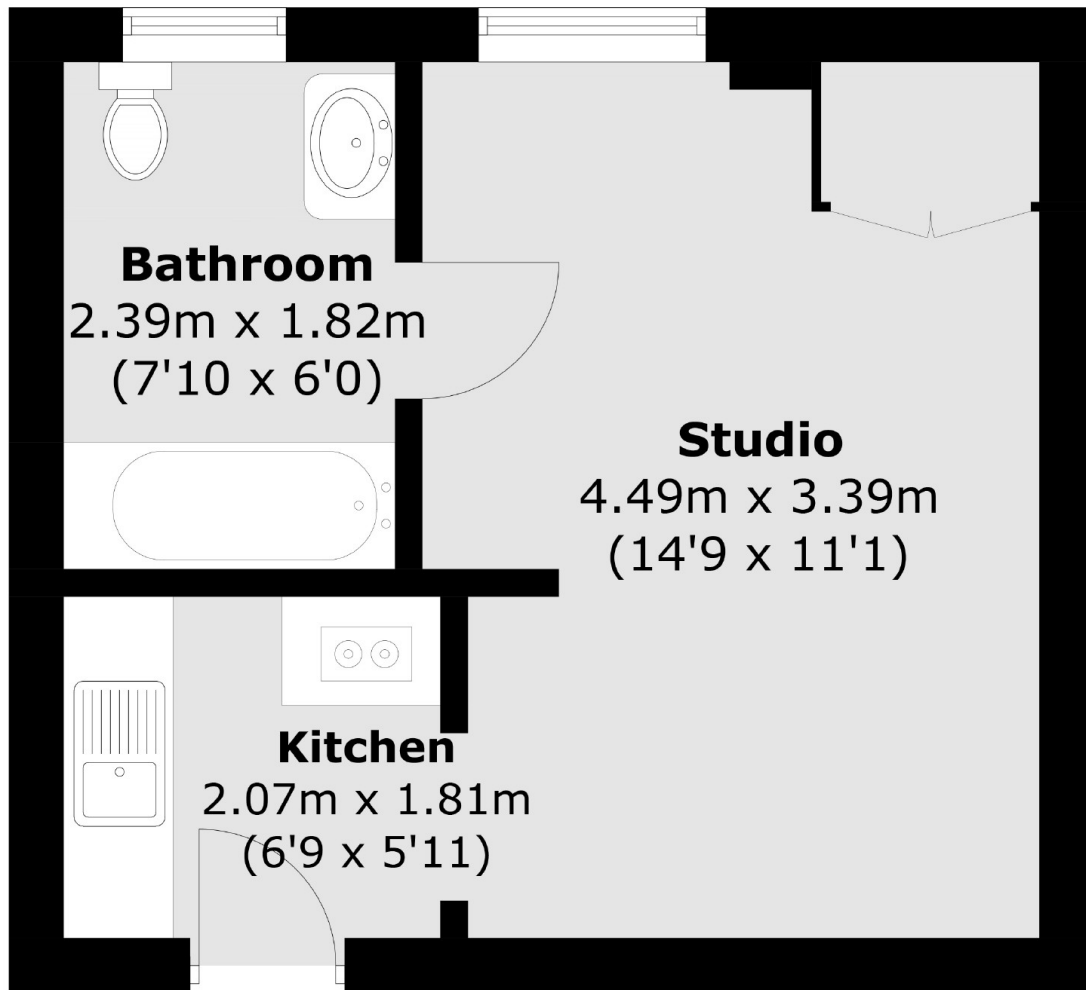

Total area (approx.): 26.0 sq. m (279.9 sq. ft)