

Russell Gardens, W14

£450,000

A spacious and modern two double bedroom apartment on the second floor of a Victorian conversion. The property has an open plan reception with feature fireplace and fitted kitchen and wooden flooring throughout.

Russell Gardens is located in between Holland Road and Shepherds Bush with both Westfield Shopping Centre and Shepherds Bush station under half a mile from the property.

Features

Two Bedrooms
Open Plan
Wooden Flooring
Second Floor
Close To Amenities

Russell Gardens, London, W14

Second Floor

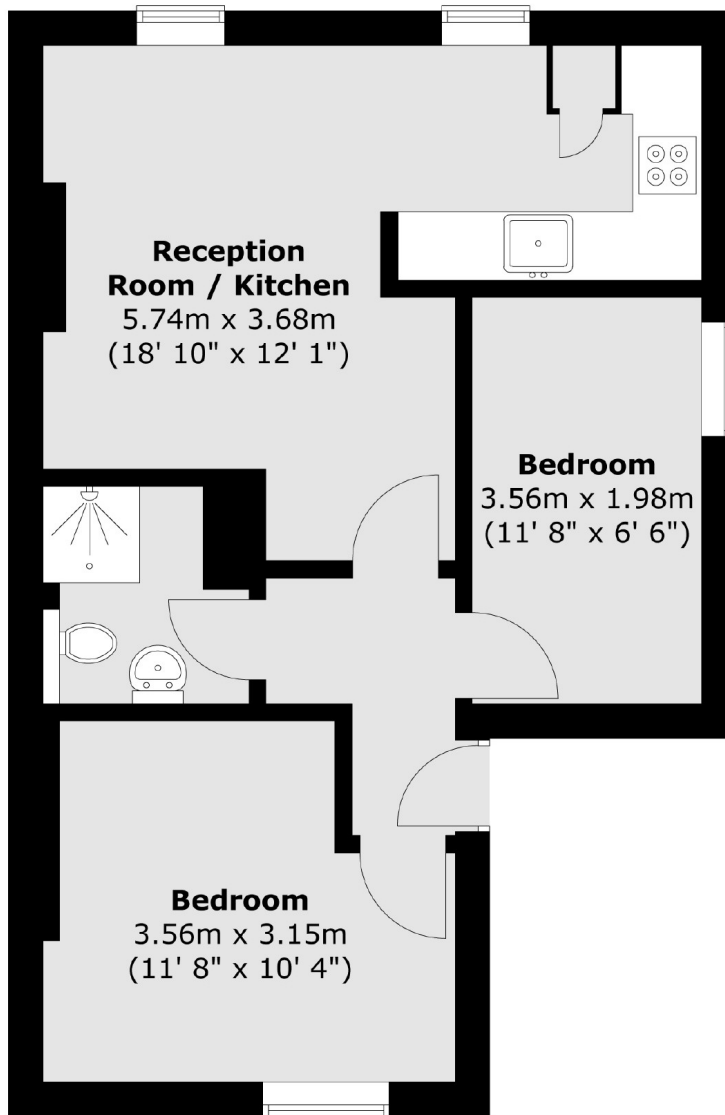

Total area (approx.) : 45.1 sq. m (485 sq. ft)