

Peter Clarke



35 Wolds End Close, Chipping Campden, GL55 6JW

£1,450 Per Calendar Month



- Three bedroom cottage
- Sitting room
- Kitchen
- Cloakroom
- Family bathroom
- Enclosed rear garden
- Garage and parking space
- Council Tax Band E; EPC rating D
- Security Deposit £1673

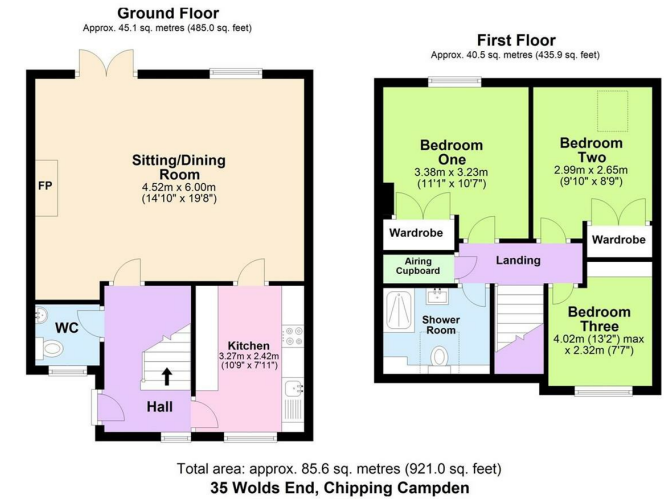

Three bedroom cottage located a short walk from the High Street. Hallway, cloakroom, sitting room and kitchen. Three first floor bedrooms and family bathroom. Outside there is an enclosed rear garden, garage and parking space. Unfurnished, Available Now.



DISCLAIMER: Peter Clarke & Co LLP themselves and for the vendors or lessors of this property whose agents they are, give notice that the particulars are set out as a general outline only for the guidance of intending purchasers or lessors, and do not constitute part of an offer or contract; all descriptions, dimensions, references to condition and necessary permission for use and occupation, and other details are given without responsibility and any intending purchasers or tenants should not rely on them as statements or presentations of fact but must satisfy themselves by inspection or otherwise as to the correctness of each of them. Room sizes are given on a gross basis, excluding chimney breasts, pillars, cupboards, etc. and should not be relied upon for carpets and furnishings. We have not carried out a detailed survey and/or tested services, appliances and specific fittings. No person in the employment of Peter Clarke & Co LLP has any authority to make or give any representation of warranty whatever in relation to this property and it is suggested that prospective purchasers walk the land and boundaries of the property, prior to exchange of contracts, to satisfy themselves as to the exact area of land they are purchasing.



Multi-award winning offices  
serving South Warwickshire & North Cotswolds

Grafton House High Street, Chipping Campden, Gloucestershire, GL55 6AT  
01386 770044 | campden@peterclarke.co.uk | www.peterclarke.co.uk

**Peter Clarke**

