



Peter Clarke

Foxglove Cottage 8 Park Road, Blockley, Moreton-In-Marsh, GL56 9BZ

- Character Cottage
- Open Plan Living Room & Stove
- Fitted Kitchen
- 2 Double Bedrooms
- Family Bathroom
- Long Cottage Garden
- Countryside Views
- Walking Distance of Shops
- Conservation Area
- Viewing Recommended



£399,000

Two double bedroom character cottage with stunning views. Open plan kitchen/living room with wood burning stove on the ground floor. Bedroom and bathroom on the first floor with the master bedroom on the top floor. Pretty cottage garden.

ACCOMMODATION

The front door opens into the kitchen/living room with beams, exposed stonework and wood burning stove. Stairs lead to the first floor with a double bedroom to the front, and family bathroom with useful laundry/airing cupboard. The top floor has a lovely master bedroom with amazing views.

The stable door leads out to the back garden across a pathway to a pleasant terraced area.. The garden is a good size and has several seating areas as well as a useful shed and mature shrubs.

GENERAL INFORMATION

TENURE: The property is understood to be freehold although we have not seen evidence. This should be checked by your solicitor before exchange of contracts.

SERVICES: We have been advised by the vendor that mains gas, electricity, water and drainage are connected to the property. However this should be checked by your solicitor before exchange of contracts.

RIGHTS OF WAY: The property is sold subject to and with the benefit of any rights of way, easements, wayleaves, covenants or restrictions etc. as may exist over same whether mentioned herein or not.

COUNCIL TAX: Council Tax is levied by the Local Authority and was previously in Band D.

CURRENT ENERGY PERFORMANCE CERTIFICATE RATING: D. A full copy of the EPC is available at the office if required.

VIEWING: By Prior Appointment with the selling agent.



Approximate Gross Internal Area
56 sq mt/602 sq ft



Ground Floor



Second Floor

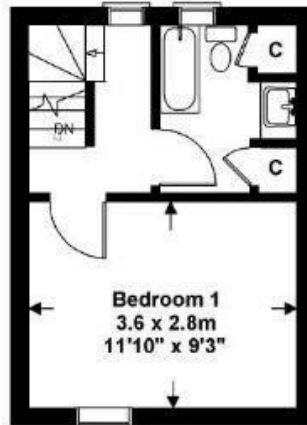

First Floor

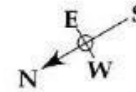

SKETCH PLAN FOR ILLUSTRATIVE PURPOSES ONLY
All measurements walls, doors, windows, fittings and appliances, their sizes and locations, are shown conventionally and are approximate only. They cannot be regarded as being a representation by the seller, his agent, the illustrator or hippo.uk.net



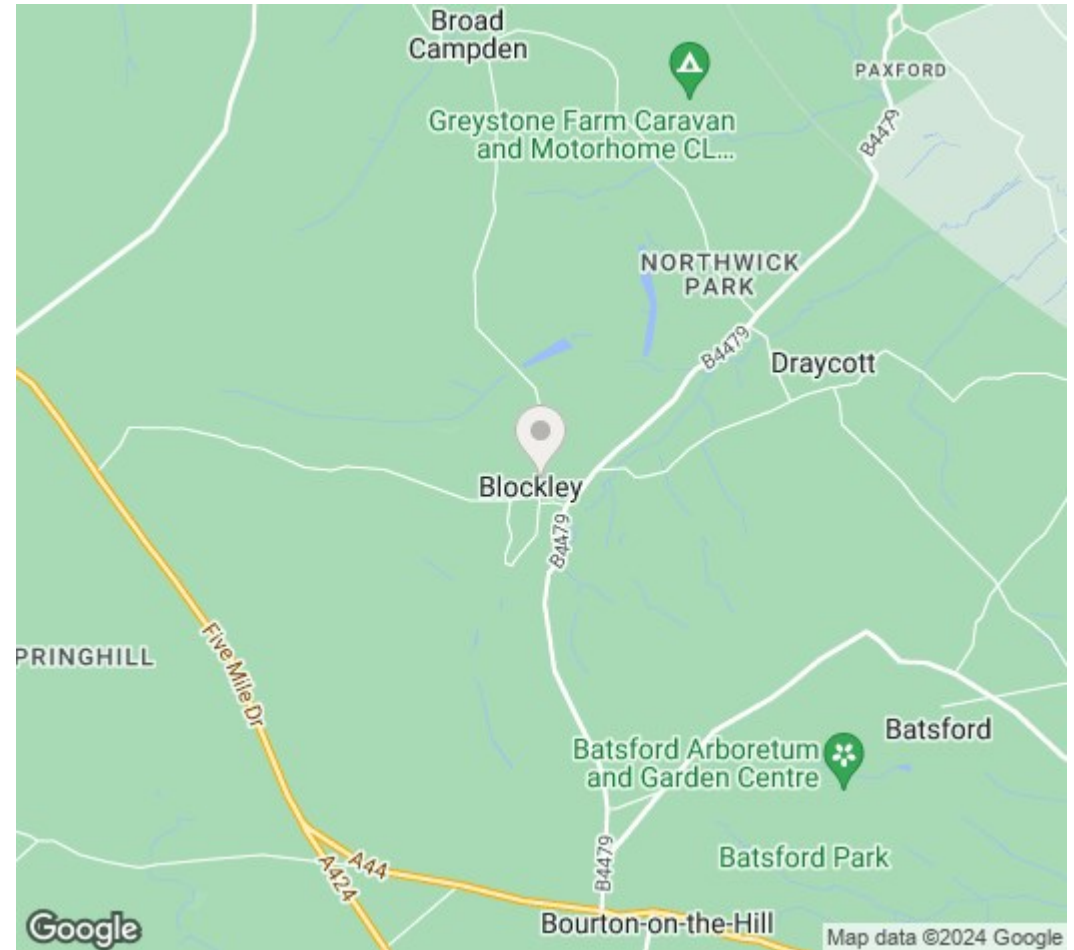

DISCLAIMER: Peter Clarke & Co LLP themselves and for the vendors or lessors of this property whose agents they are, give notice that the particulars are set out as a general outline only for the guidance of intending purchasers or lessors, and do not constitute part of an offer or contract; all descriptions, dimensions, references to condition and necessary permission for use and occupation, and other details are given without responsibility and any intending purchasers or tenants should not rely on them as statements or presentations of fact but must satisfy themselves by inspection or otherwise as to the correctness of each of them. Room sizes are given on a gross basis, excluding chimney breasts, pillars, cupboards, etc. and should not be relied upon for carpets and furnishings. We have not carried out a detailed survey and/or tested services, appliances and specific fittings. No person in the employment of Peter Clarke & Co LLP has any authority to make or give any representation of warranty whatever in relation to this property and it is suggested that prospective purchasers walk the land and boundaries of the property, prior to exchange of contracts, to satisfy themselves as to the exact area of land they are purchasing.

Multi-award winning offices
serving South Warwickshire & North Cotswolds

Grafton House High Street, Chipping Campden, Gloucestershire, GL55 6AT
01386 770044 | campden@peterclarke.co.uk | www.peterclarke.co.uk

