

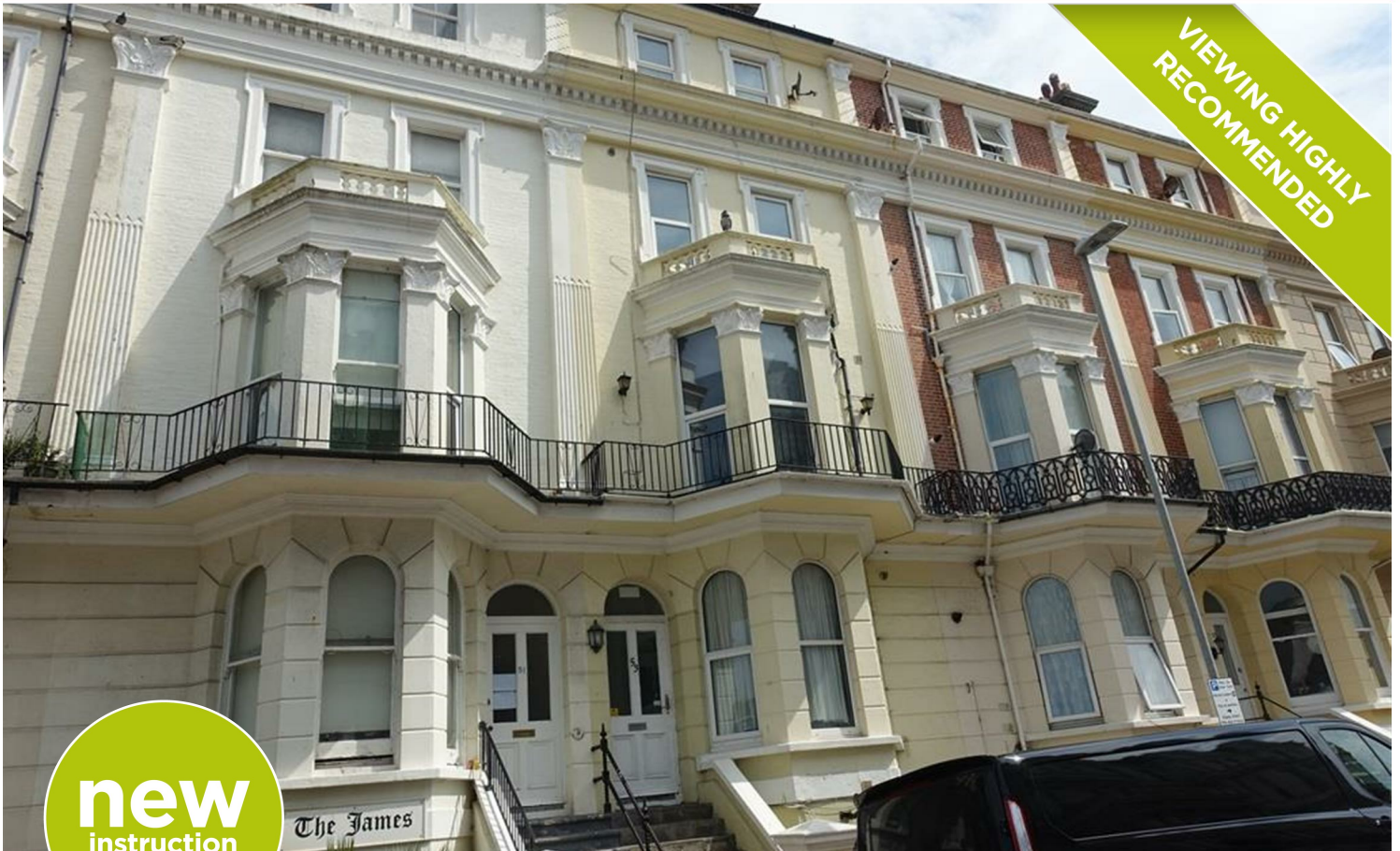

HOME + CASTLE
ESTATE AGENTS

Home and Castle Estate Agents
4 Millfields, Station Rd, Polegate BN26 6AS
Tel: 01323 481922
Email: info@hcsussex.co.uk
hcsussex.co.uk

VIEWING HIGHLY
RECOMMENDED



new
instruction



Jevington Gardens, Eastbourne, BN21

Studio Apartment

Home & Castle are pleased to present a well presented studio apartment with shower room. Kitchen with range of cupboards, drawer and worktops. Double glazed with electric heating. Outlook to rear of the property.

Great location, within minutes of the seafront, local parks, shops and Eastbourne town centre.

TO LET

£500 PCM

Dimensions

All dimensions supplied are for guidance purposes only and do not form part of any contract. No systems or services have been tested.

Open Plan Living Area

Living Area 10'4" x 9'9" (3.15m x 2.97m)

Power points, Dimplex wall-mounted electric heater, pendant light, built-in wardrobes and shelving. Carpet.

Kitchen Area 5'11" x 5'8" (1.80m x 1.73m)

Fitted kitchen with range of cupboards, drawer, worktops and stainless steel sink. Space for fridge freezer. Part tiled walls. Double glazed window with blind looking out to rear of property. Power points, pendant light. and vinyl flooring.

Shower Room 6'9" x 3'9" (2.06m x 1.14m)

Cubicle with electric shower, WC, basin, towel rail, ceiling light, extractor fan, tiled walls and vinyl flooring.

Additional Information

Please Note - This is a "No-Smoking" Building.

1 weeks rent as a holding deposit £115

5 weeks rent as a security deposit £576

Energy Performance Rating C.

Eastbourne Council Tax Band A - Currently £1,688.32 p.a.

Single Person Occupancy - Council Tax £1,266.24 p.a.

Floor Plan

STUDIO APARTMENT
158 sq.ft. (14.7 sq.m.) approx.

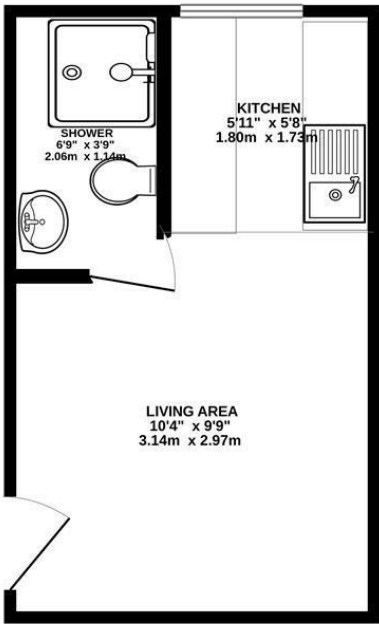

STUDIO APARTMENT
TOTAL FLOOR AREA - 158 sq.ft. (14.7 sq.m.) approx.

Whilst every attempt has been made to ensure the accuracy of the floorplan contained here, measurements of doors, windows, rooms and any other items are approximate and no responsibility is taken for any error, omission or mis-statement. This plan is for illustrative purposes only and should be used as such by any prospective purchaser. The services, systems and appliances shown have not been tested and no guarantee as to their operability or efficiency can be given.
Made with Metropix ©2024

Area Map



These particulars, whilst believed to be accurate are set out as a general outline only for guidance and do not constitute any part of an offer or contract. Intending purchasers should not rely on them as statements of representation of fact, but must satisfy themselves by inspection or otherwise as to their accuracy. No person in this firms employment has the authority to make or give any representation or warranty in respect of the property.

Energy Efficiency Graph

