



HOME + CASTLE
ESTATE AGENTS

Home and Castle Estate Agents
4 Millfields, Station Rd, Polegate BN26 6AS
Tel: 01323 481922
Email: info@hcsussex.co.uk
hcsussex.co.uk

VIEWING HIGHLY
RECOMMENDED



new
instruction



Bramley Road, Polegate, BN26 6JS

Freehold | House - Semi-Detached | 2 Bedrooms

Home + Castle welcome to the market this beautifully presented 2 BEDROOM SEMI-DETACHED HOUSE, situated in a popular area of Polegate. This property benefits from close proximity to local schools, amenities and Polegate mainline train station serving Gatwick, London Victoria and Ashford international. The property currently has PLANNING PERMISSION GRANTED for a single storey extension to the side. There is easy access to bus routes serving Eastbourne and road links of the A27 & A22 making this property ideal for commuters, first time buyers and families. Viewing highly recommended.

FOR SALE
FREEHOLD
£290,000

Approach

The property provides off-road parking for 2-3 cars, with a paved path to the composite front door. Lawn area with some mature shrubs to the front and side access to the rear garden.

Entrance Hall

A bright and spacious entrance hall with solid wood flooring, pendant light fitting, power points, radiator and stairs to first floor.

Lounge/diner 12'7" x 14'4" (3.85 x 4.38m)

Double glazed window to rear aspect, pendant light fitting, wooden flooring, storage space, radiator, power points, french door to garden.

Kitchen 6'6" x 10'0" (1.99 x 3.07m)

A modern fitted kitchen with a range of base, wall and drawer units with solid wood work surfaces. Double glazed window to rear aspect, integrated fridge freezer, electric oven, gas hob, cooker hood, stainless steel sink, and drainer, space and plumbing for a washing machine, solid wood flooring, ceiling light and power points.

Landing

Carpet, pendant light fitting and access to the loft which is part boarded, insulated and light.

Bedroom 1 12'7" x 8'5" (3.85 x 2.59m)

Double glazed window to front aspect, pendant light fitting, carpet, radiator and power points.

Bedroom 2 12'7" x 8'4" (3.84 x 2.56m)

Double glazed window to rear aspect, carpet, pendant light fitting, radiator and power points.

Bathroom 6'3" x 7'4" (1.92 x 2.25m)

a modern suite comprising a panelled bath with fitted chrome shower attachment, pedestal basin with chrome taps, WC, vinyl flooring, spot lights and chrome ladder style radiator.,opaque double glazed window.

Garden

Mostly laid to lawn with a paved patio area, side access to the front of the property and uninterrupted views.

Council tax band

PLANNING PERMISSION

THE PROPERTY CURRENTLY HAS PLANNING PERMISSION GRANTED FOR A SINGLE STOREY EXTENSION TO THE SIDE PROVIDING ADDITIONAL LIVING SPACE AND A GARAGE.

PLEASE ASK FOR FURTHER DETAILS

Floor Plan

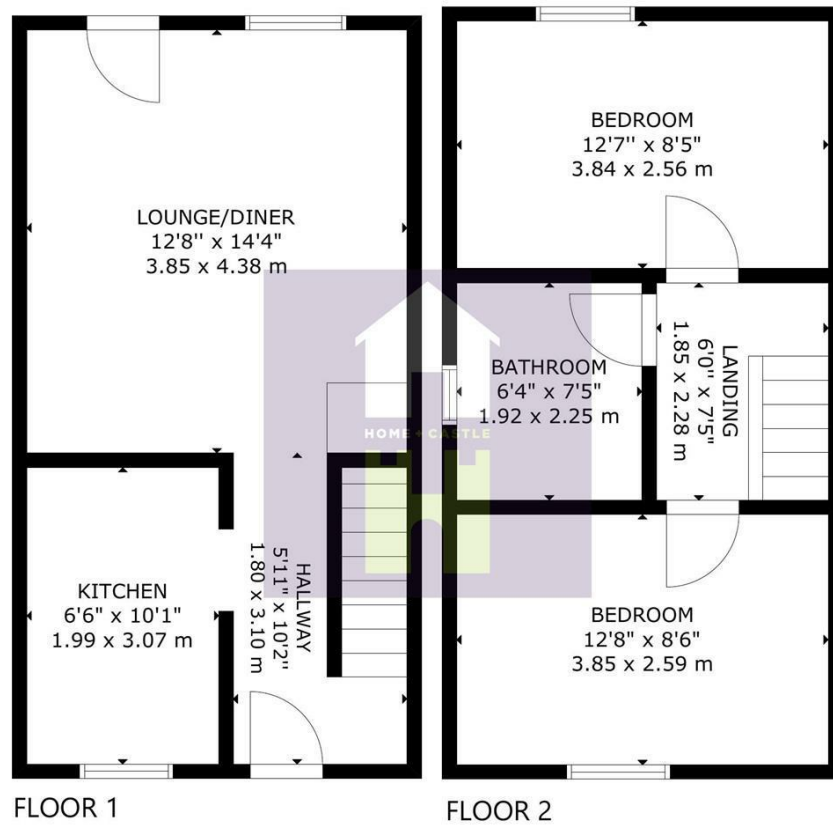

GROSS INTERNAL AREA
 TOTAL: 60 m²/641 sq ft
 FLOOR 1: 30 m²/322 sq ft, FLOOR 2: 30 m²/319 sq ft
 SIZE AND DIMENSIONS ARE APPROXIMATE, ACTUAL MAY VARY

Area Map



Energy Efficiency Graph

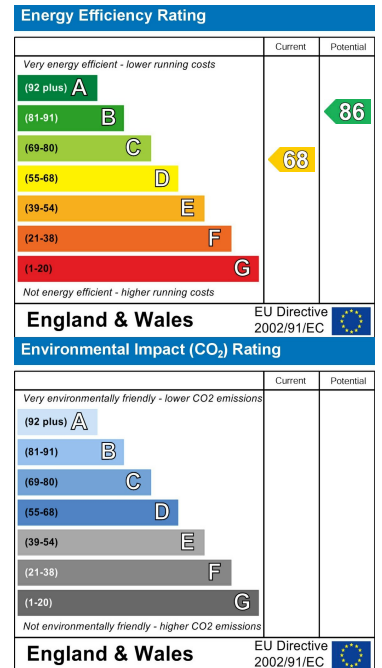

These particulars, whilst believed to be accurate are set out as a general outline only for guidance and do not constitute any part of an offer or contract. Intending purchasers should not rely on them as statements of representation of fact, but must satisfy themselves by inspection or otherwise as to their accuracy. No person in this firm's employment has the authority to make or give any representation or warranty in respect of the property.