

# Wild & Co.

wildandco.uk

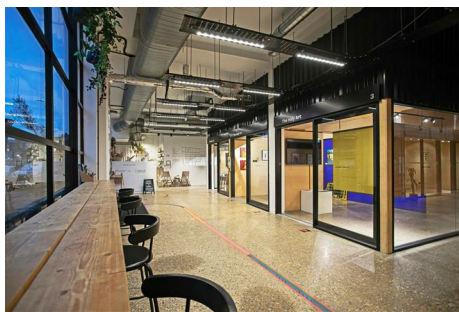

## The Factory, E8 2DA

The Factory is a glass fronted Class E emporium, offering flexible spaces, with an eclectic mix of contemporary businesses in situ, including a popular coffee house, interior designer, vintage kimonos, designer hats and others. Currently the arcade's front 3 intercommunicating units comprising 800 square foot, are available on flexible terms. The Factory is located just off Stoke Newington High Street on Shacklewell Lane with easy access to numerous bus routes and overground stations. The Landlords are dedicated to raising The Factory profile by running a variety of specialist trading days where entrepreneurs can rent pop up shops to market their wares. an early inspection of the units is highly recommended.

**£3,600 Per Month |**

# The Factory, E8 2DA



- 800 Square Foot
- Close to transport
- On site parking
- Trendy enviroment

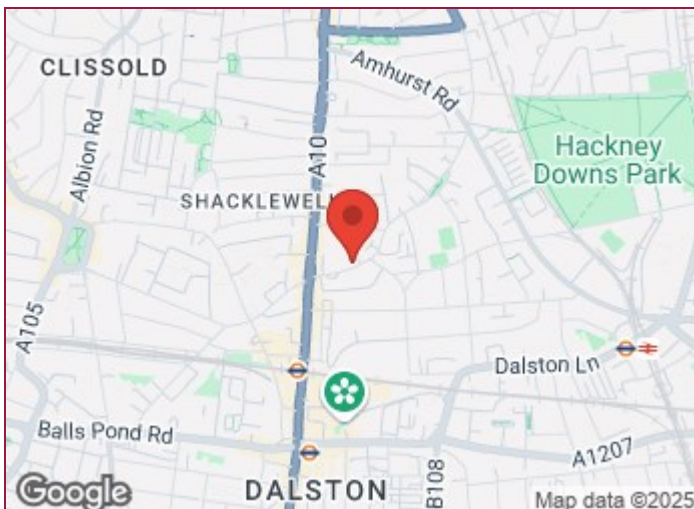

Directions





space	reception Style	boardroom / dinner	theatre
1/2/3	148		
1	50	12	25
2	48	12	25
3	50	12	25

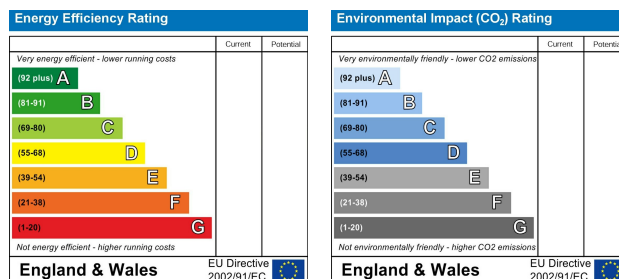

111 Lower Clapton Road, Hackney, London, E5 ONP  
1 Pride Court, 80/82 White Lion Street, London N1 9PF  
Tel: 020 8986 2298 Email: [hello@wildandco.uk](mailto:hello@wildandco.uk)