

Glastonbury Mews, Stockton Heath, Warrington

£220,000

🛏 2 🚗 2 🛋 2



A larger style, beautifully presented modern apartment forming part of the highly regarded Glastonbury Mews development on Fairfield Road, Stockton Heath.

Features of the immaculate accommodation include; a secure communal entrance hall with intercom access, private entrance porch / hall, a 18ft x 13ft open plan lounge / dining room, kitchen / breakfast room with integrated appliances, master bedroom with dressing area & ensuite, second double bedroom, bathroom & a useful additional bedroom / home office. Outside there are lovely communal gardens and allocated parking for two cars.

Early Viewing Advised.



Key Features

- Modern First Floor Apartment
- Sought After Development
- Immaculate Presentation
- Two / Three Bedrooms
- Open Plan Living Space
- Fully Integrated Kitchen
- Dressing Area + Ensuite
- Allocated Parking For Two Cars
- Lovely Communal Gardens
- Early Viewing Advised

Approx Gross Internal Area
79 sq m / 852 sq ft

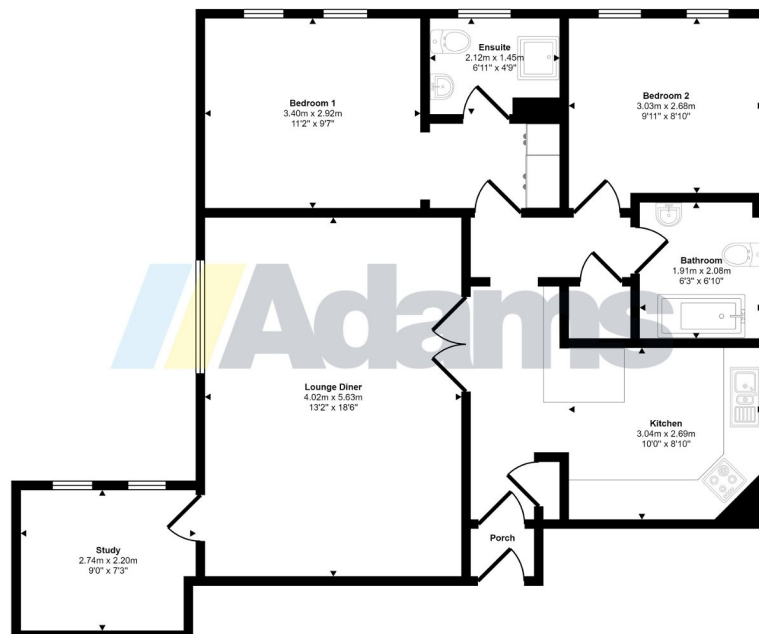

Floorplan

This floorplan is only for illustrative purposes and is not to scale. Measurements of rooms, doors, windows, and any items are approximate and no responsibility is taken for any error, omission or mis-statement. Icons of items such as bathroom suites are representations only and may not look like the real items. Made with Made Snappy 360.