



Flat 2 114-120 Essex Road, Angel, N1 8LX

£508 Per Week

## Flat 2 114-120 Essex Road, Angel N1 8LX

Well-presented one-bedroom apartment superbly located on Essex Road, Angel. The property measures approx 500 sq ft and consists of a double bedroom, well-sized living room with a semi open plan kitchen and bathroom. It further benefits from an abundance of built-in storage and most rooms are equipped with an exquisite a wooden floor that give an instant cozy feel.

Both Angel Underground and Highbury & Islington Stations are within a short walking distance. With its prime location, residents will enjoy easy access to a variety of local amenities, including shops, cafes, and restaurants, all within a short stroll.



Council Tax Band: C



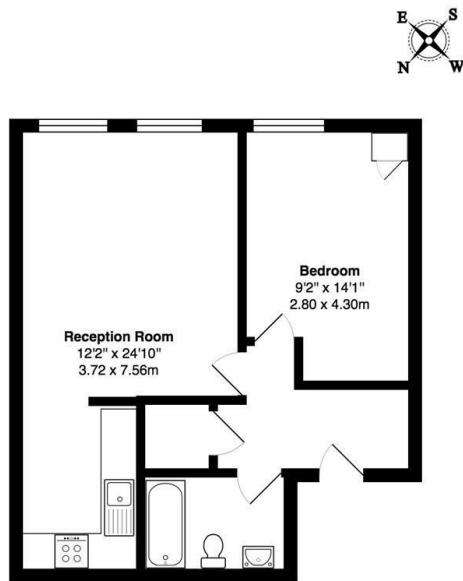

Essex Road, n1  
 Total Area: 503 ft² ... 46.7 m²  
 Floor plan are for identification purposes guideline only, not to scale.  
 Compliant with the RICS code of measuring practice.

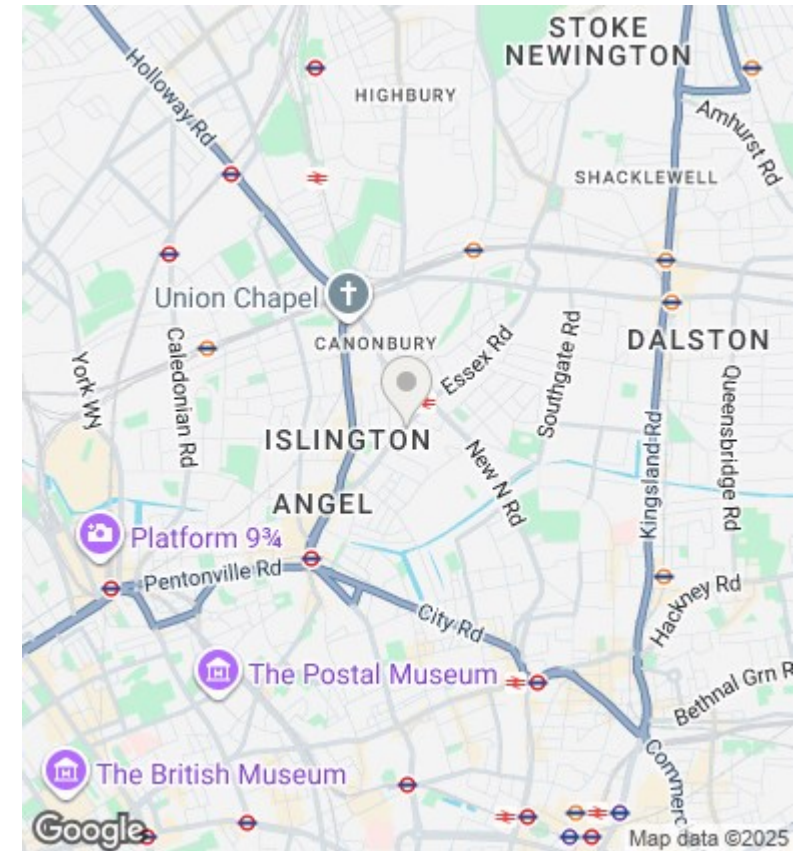

## Directions

## Viewings

Viewings by arrangement only. Call 02073593191 to make an appointment.

## Council Tax Band

C

Energy Efficiency Rating		
	Current	Potential
Very energy efficient - lower running costs		
(92 plus) <b>A</b>		
(81-91) <b>B</b>		
(69-80) <b>C</b>	<b>81</b>	<b>81</b>
(55-68) <b>D</b>		
(39-54) <b>E</b>		
(21-38) <b>F</b>		
(1-20) <b>G</b>		
Not energy efficient - higher running costs		
<b>England &amp; Wales</b>	EU Directive 2002/91/EC	

### Full description

Well-presented one bedroom apartment superbly located on Essex Road. The property measures approx 500 sqft and consists of a double bedroom, good sized living area, kitchen, and bathroom. Both Angel Underground and Highbury & Islington Stations are within a short walking distance.





