



17 Clover Court Seven Sisters Road, London, N4 2AH

£680,000



# 17 Clover Court Seven Sisters Road, london N4 2AH

Welcome to this beautifully presented, contemporary 3-bedroom flat with stunning views over Finsbury Park. Situated in a sought-after location, this bright and spacious home combines stylish modern living with the tranquillity of green surroundings.

The open-plan living and kitchen area is filled with natural light, enhanced by floor-to-ceiling windows that showcase the park views. A private balcony provides the perfect spot to relax, unwind, or enjoy morning coffee while overlooking the greenery.

The modern kitchen is equipped with integrated appliances and sleek finishes, while the elegant bathroom boasts contemporary fittings, with some flats also offering an en-suite. Additional highlights include ample storage, a secure entry system, and lift access.

Finsbury Park Station is just a short walk away, offering excellent transport links via the Victoria and Piccadilly lines, as well as National Rail, making commuting into Central London quick and convenient.

service charge approx. £3336pa

Ground rent is £461.24

Lease 123 Years



Council Tax Band: D



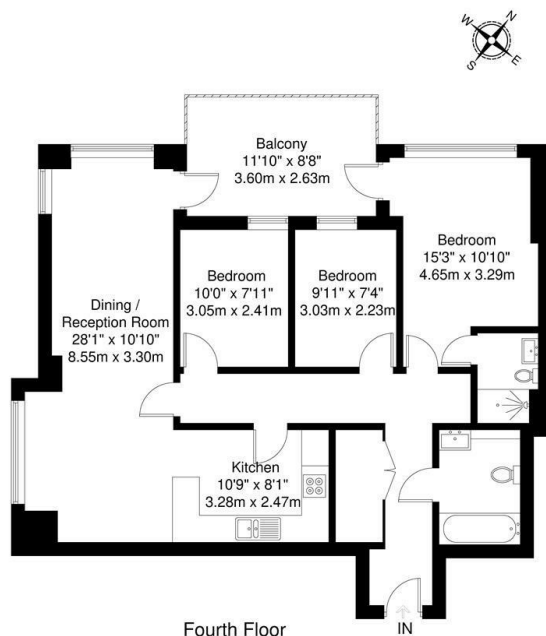

Clover Court, Seven Sisters Road, N4

Total Gross Internal Area = 87.6 sq m / 942 sq ft

All Measurements are approximate and for identification guideline purposes only, not to scale.  
Compliant with the RICS code of measuring practice

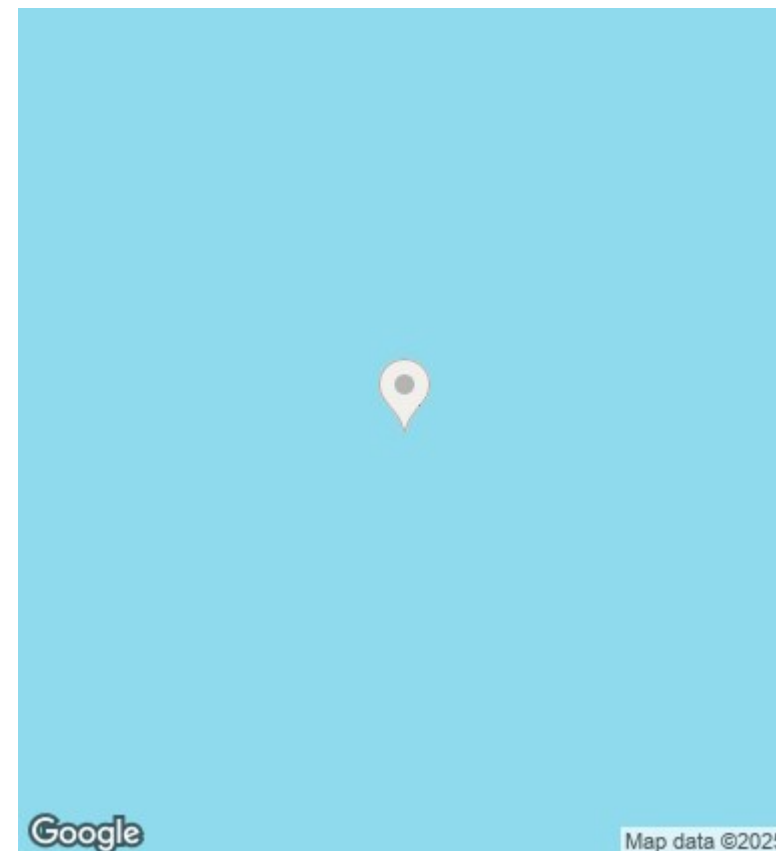

## Directions

## Viewings

Viewings by arrangement only. Call 02073593191 to make an appointment.

## Council Tax Band

D

Energy Efficiency Rating		
	Current	Potential
Very energy efficient - lower running costs		
(92 plus) A		
(81-91) B	84	85
(69-80) C		
(55-68) D		
(39-54) E		
(21-38) F		
(1-20) G		
Not energy efficient - higher running costs		
England & Wales	EU Directive 2002/91/EC	







