



Flat 1, 2 Oakfield Road, Finsbury Park, London, N4 4NL

£750 Per Week

Flat 1, 2 Oakfield Road, Finsbury Park N4 4NL

Magnificent 3 double bedroom flat. The flat comprises a very large open plan lounge/kitchen- 3 double bedrooms- and a tiled bathroom.. The picturesque Finsbury Park is just minutes away- offering a variety of amenities and attractions within a close distance.



Council Tax Band: D



Full description

Magnificent 3 double bedroom flat. The flat comprises a very large open plan lounge/kitchen-

3 double bedrooms-

and a tiled bathroom. The picturesque Finsbury Park is just minutes away-

offering a variety of amenities and attractions within a closed distance. Direct transport links towards the city centre and Highbury and Islington can be found nearby at Finsbury Pa

EPC Band E





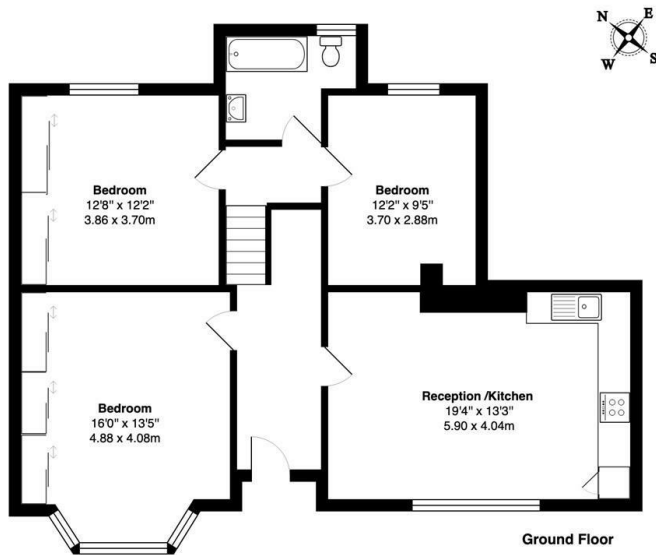

Oakfield Rd, N4
Total Gross Area: 925 ft² ... 85.9 m²
All measurements are approximate and for identification guideline purposes only, not to scale.
Compliant with the RICS code of measuring practice

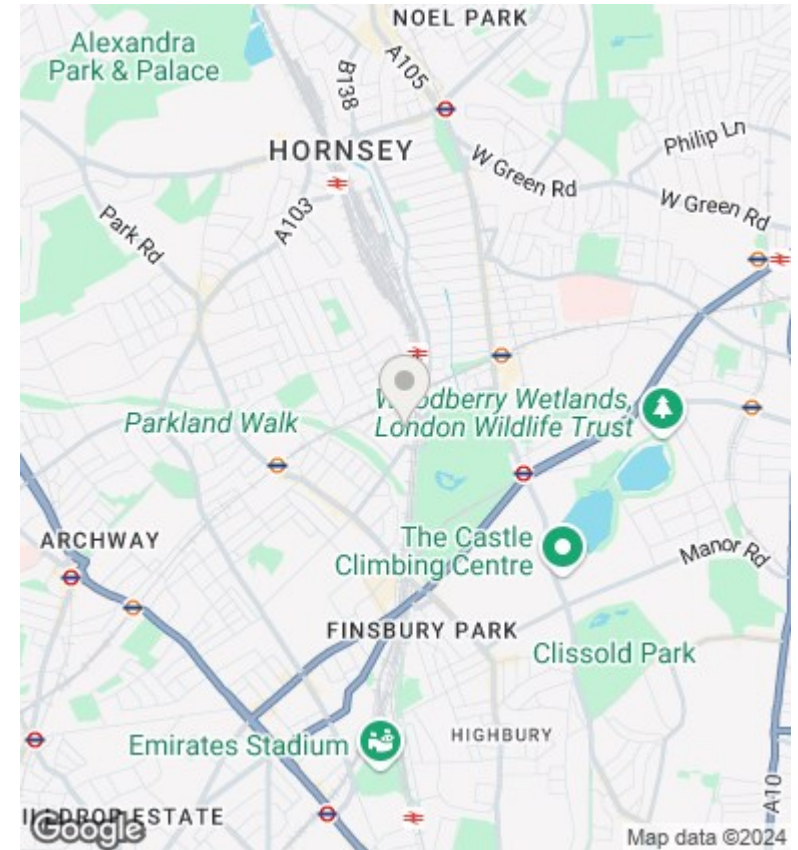

Directions

Viewings

Viewings by arrangement only. Call 02073593191 to make an appointment.

Council Tax Band

D

Energy Efficiency Rating		
	Current	Potential
<i>Very energy efficient - lower running costs</i>		
(92 plus) A		
(81-91) B		
(69-80) C		
(55-68) D	47	54
(39-54) E		
(21-38) F		
(1-20) G		
<i>Not energy efficient - higher running costs</i>		
England & Wales	EU Directive 2002/91/EC	