



5 TRAJECTUS WAY
KEYNSHAM
BRISTOL
BS31 2FX
£275,000

LOCATED WITHIN THE HEART OF THE SOUGHT-AFTER SOMERDALE COMMUNITY WITHIN KEYNSHAM IS THIS CONTEMPORARY GROUND FLOOR, TWO DOUBLE BEDROOM APARTMENT. BOASTING AN EXPOSED BRICK, INDUSTRIAL PROFILE OVERLOOKING THE ICONIC FORMER CHOCOLATE FACTORY, THIS CONTEMPORARY HOME CAN BE FOUND AT THE FOOT OF THE IMPRESSIVE TREE LINED ENTRANCE INTO THE DEVELOPMENT.

Internally the property comprises of a full length open plan kitchen living area, with dual aspect light and a well-proportioned, bright fitted kitchen finished with a full selection of integrated appliances. Each of the two bedrooms provide good double bed proportions, with a stylish bathroom suite and ample storage all accessible from the hall. Externally, the property includes an allocated parking space with further visitors spaces and bicycle storage available.

The development itself has rapidly earned a prestigious status, with an excellent selection of facilities found within the site to include a gymnasium and swimming pool, a doctors surgery, a primary school and eateries just to name a few. For commuters, Keynsham railway station resides just a short, pleasant stroll from the property, with the amenities of Keynsham high street a short distance away.

A truly impressive apartment, and one worth an early internal viewing.





1st Floor
672 sq.ft. (62.5 sq.m.) approx.

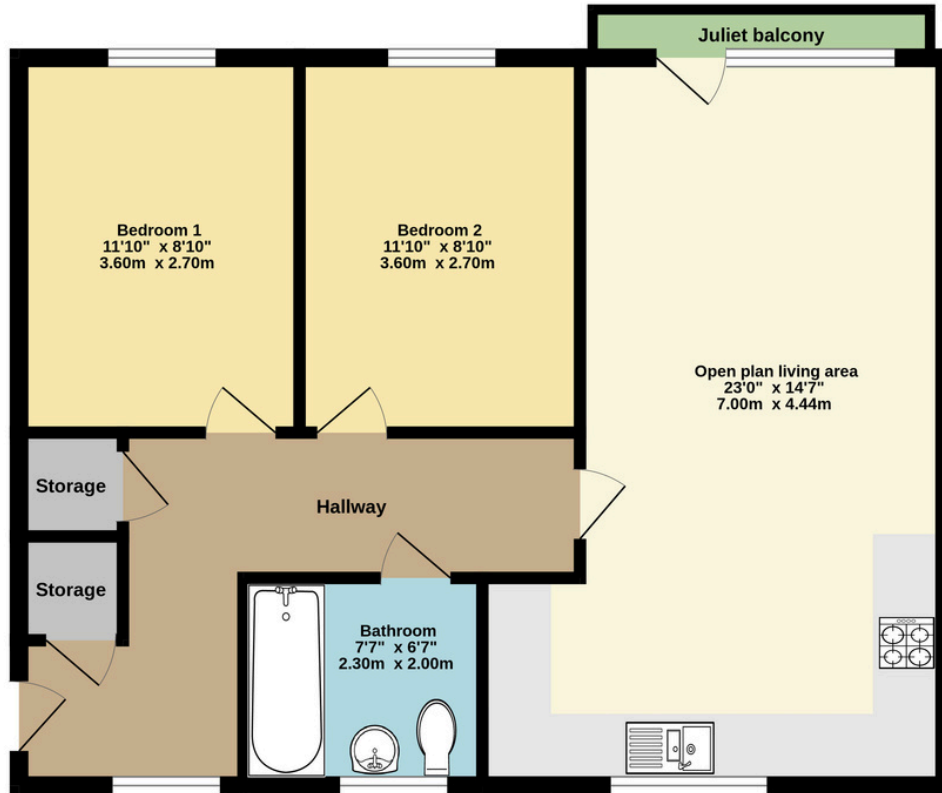

TOTAL FLOOR AREA : 672 sq.ft. (62.5 sq.m.) approx.

Whilst every attempt has been made to ensure the accuracy of the floorplan contained here, measurements of doors, windows, rooms and any other items are approximate and no responsibility is taken for any error, omission or mis-statement. This plan is for illustrative purposes only and should be used as such by any prospective purchaser. The services, systems and appliances shown have not been tested and no guarantee as to their operability or efficiency can be given.
Made with Metropix ©2025

Energy performance certificate (EPC)

5, Trajectus Way
Keynsham
BRISTOL
BS31 2FX

Energy rating
B

Valid until: 13 November 2027

Certificate number: 9048-5981-7309-5553-0954

Property type: Ground-floor flat
Total floor area: 62 square metres

Rules on letting this property

Properties can be let if they have an energy rating from A to E.

You can read [guidance for landlords on the regulations and exemptions](https://www.gov.uk/guidance/domestic-private-rented-property-minimum-energy-efficiency-standard-landlord-guidance)

(<https://www.gov.uk/guidance/domestic-private-rented-property-minimum-energy-efficiency-standard-landlord-guidance>).

Energy rating and score

This property's energy rating is B. It has the potential to be B.

[See how to improve this property's energy efficiency.](#)

The graph shows this property's current and potential energy rating.

Properties get aratingfromA(best)toG (worst)and a score. The better the rating and score, the lower your energy bills are likely to be.

For properties in England and Wales:

the average energy rating is D
the average energy score is 60

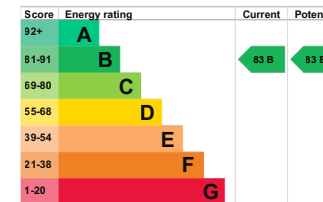

0117 986 6644

GREGORYS.CLICK

ENQUIRIES@GREGORYS.CLICK



GREGORYS
— ESTATE AGENTS —