

58 GREENFIELD ROAD
KEYNSHAM
BRISTOL
BS31 1FL
OFFERS OVER £190K



G R E G O R Y S
— E S T A T E A G E N T S —

Offered to the market with no onward chain. A superb, first floor apartment offered for sale in excellent decorative standard. Positioned within the popular 'Meadows' development, this Taylor Wimpey constructed property sits on the fringes of Keynsham.



The High Street and Train Station can be found nearby, whilst the beautiful open countryside and walks are only a stones throw away. This style of apartment has proved popular with young professionals and buy to let investors. Internally the accommodation has been enhanced and combined with generous room proportions, makes for a very attractive proposition. Entrance to the first floor is via a communal hallway and stairs, accessed via secure intercom system. An entrance hallway then provides access to the accommodation, firstly a large double bedroom, then a bathroom, complete with a three piece white suite. To the end of the hallway can be found the impressive, open plan living room. The kitchen comprises a good selection of fitted units and integrated appliances. Ample space is available for a comfortable lounge area with the dining area offering 'French' doors and a 'Juliette' balcony with views to the rear aspect.



Parking is by means of an allocated parking space with further visitor spaces available. The property is double glazed throughout and is heated via a gas combination boiler. An early internal viewing is highly recommended.



Ground Floor
495 sq.ft. (46.0 sq.m.) approx.

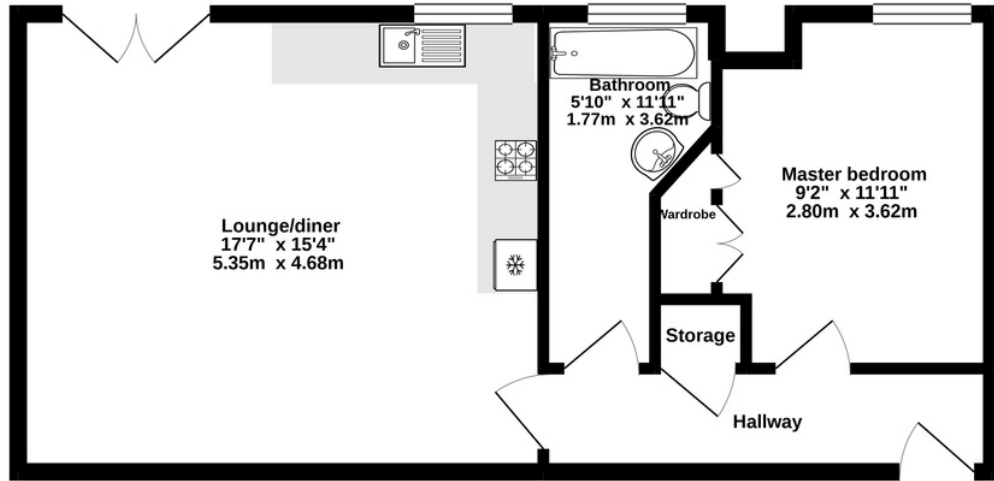

TOTAL FLOOR AREA : 495 sq.ft. (46.0 sq.m.) approx.

Whilst every attempt has been made to ensure the accuracy of the floorplan contained here, measurements of doors, windows, rooms and any other items are approximate and no responsibility is taken for any error, omission or mis-statement. This plan is for illustrative purposes only and should be used as such by any prospective purchaser. The services, systems and appliances shown have not been tested and no guarantee as to their operability or efficiency can be given.
Made with Metropix ©2021

Energy performance certificate (EPC)

58, Greenfield Road Keynsham BRISTOL BS31 1FL		Energy rating B
Valid until 12 January 2026	Certificate number 0146-3817-7096-9796-9565	

Property type
Mid-floor flat

Total floor area
52 square metres

Rules on letting this property

Properties can be rented if they have an energy rating from A to E.

If the property is rated F or G, it cannot be let, unless an exemption has been registered. You can read [guidance for landlords on the regulations and exemptions \(https://www.gov.uk/guidance/domestic-private-rented-property-minimum-energy-efficiency-standard-landlord-guidance\)](https://www.gov.uk/guidance/domestic-private-rented-property-minimum-energy-efficiency-standard-landlord-guidance).

Energy efficiency rating for this property

This property's current energy rating is B. It has the potential to be B.

[See how to improve this property's energy performance.](#)

